

ROGUE

ECHO BIKE CUSTOMER INSTRUCTIONS (SHEET 1)

SEE SHEETS 9 & 10 FOR ITEM DESCRIPTIONS AND QUANTITIES

1

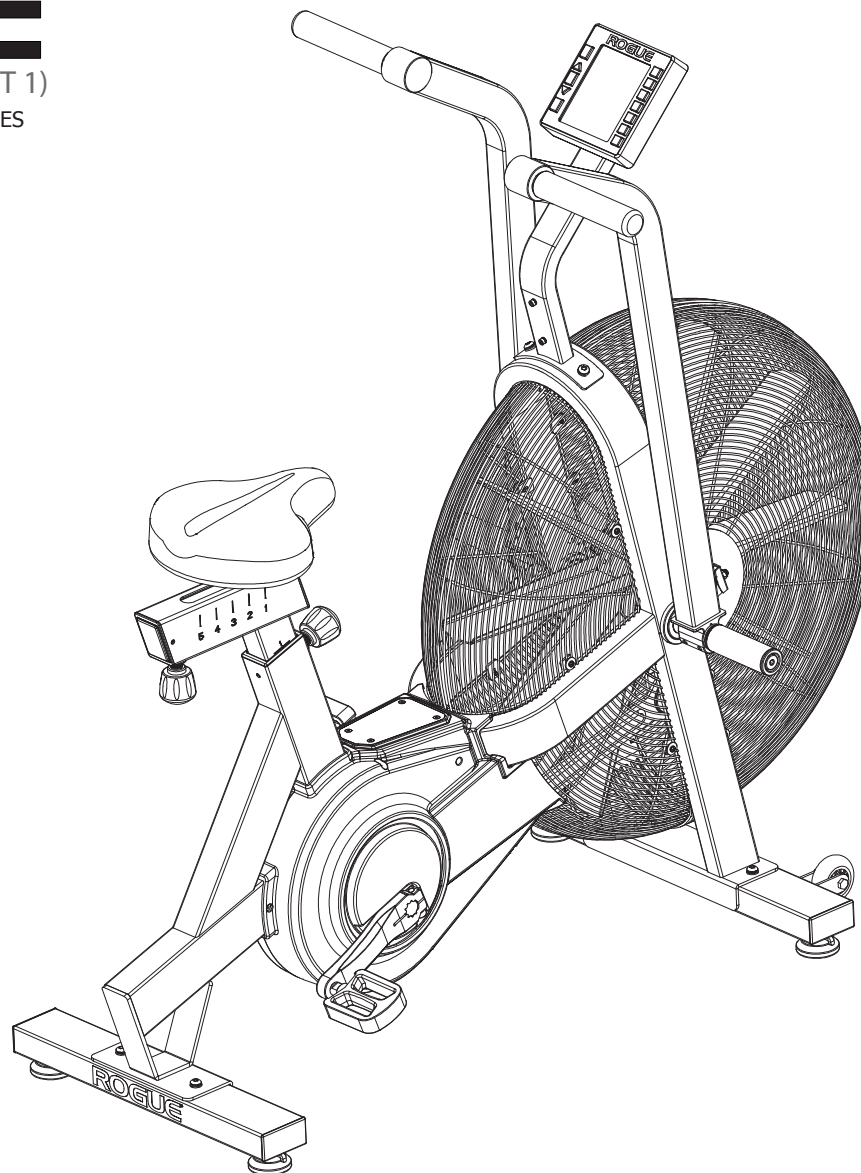

DISCLAIMER

Resistance training, gymnastics training, and activities at height are potentially dangerous and may lead to serious injury or even death. Use common sense when training, to obtain instruction in the proper execution of movements, and understand your limitations. This equipment must only be used by competent and responsible person, or under the direct and visual control of a competent and responsible person. Obtaining instructions in appropriate techniques and methods of use is your own responsibility. You assume all risks and responsibilities for all damage, injury or death which may occur during or following incorrect installation or use of this equipment in any matter whatsoever. Rogue Fitness bears no liability beyond the replacement value of the equipment in question.



WARNING

MISUSE OF THIS CAN RESULT IN SEVERE INJURY

BOTH ROGUE FITNESS AND BUYER DISCLAIM ANY EXPRESS OR IMPLIED WARRANTY, INCLUDING, WITHOUT LIMITATION, WARRANTIES OR MERCHANTABILITY AND/OR FITNESS FOR A PARTICULAR PURPOSE WITH RESPECT TO THE EQUIPMENT. BUYER ASSUMES ALL LIABILITY IN USE OF EQUIPMENT

ROGUE FITNESS
511 E 5th Ave
Columbus, OH 43201
(614) 358-6190
TEAM@ROGUEFITNESS.COM

ROGUE

ECHO BIKE CUSTOMER INSTRUCTIONS (SHEET 2)

SEE SHEETS 9 & 10 FOR ITEM DESCRIPTIONS AND QUANTITIES

STEP 1: USING THE 6mm HEX KEY, REMOVE THE SHIPPING SUPPORT TUBE. TUBE AND HARDWARE MAY BE DISCARDED.

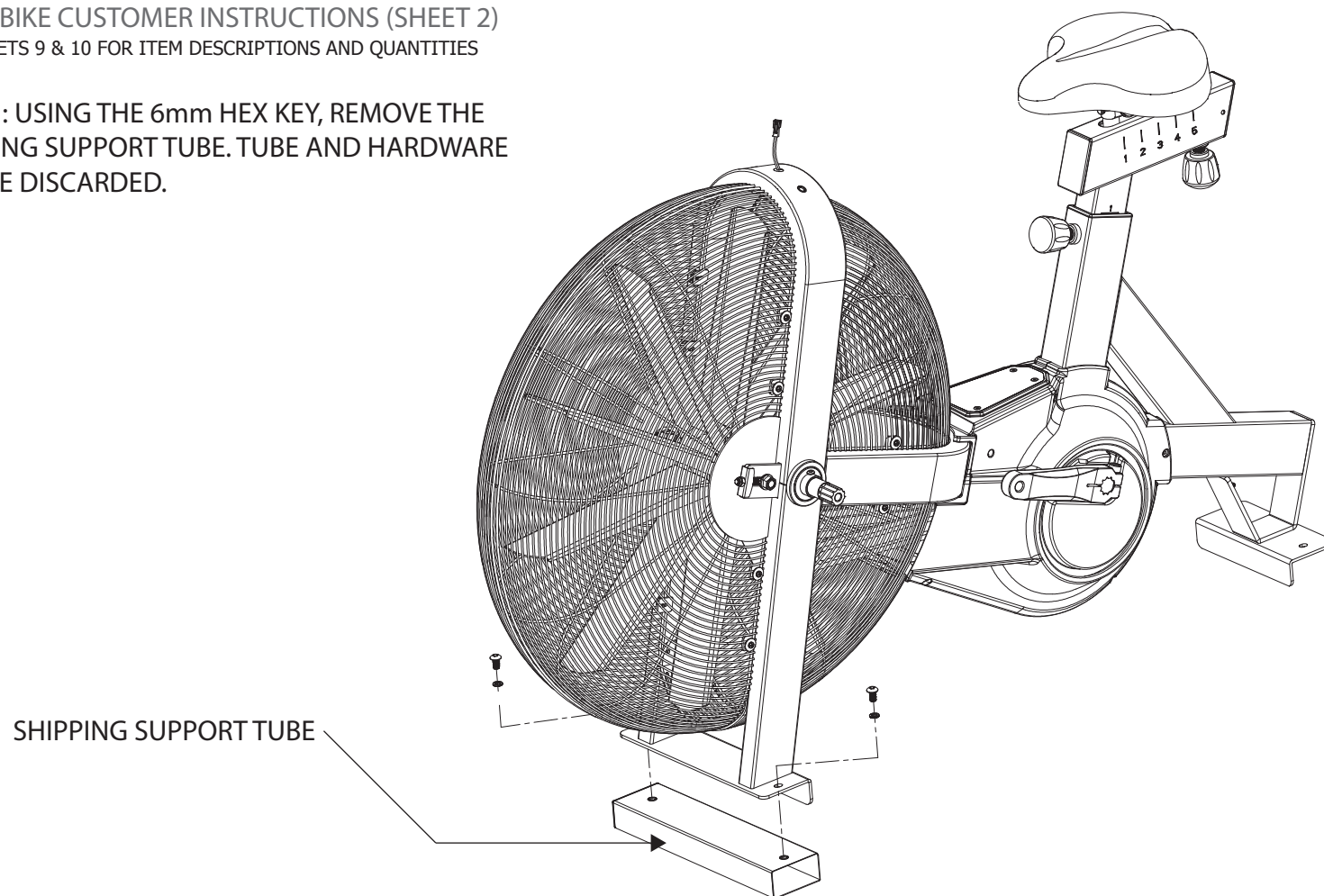

DISCLAIMER

Resistance training, gymnastics training, and activities at height are potentially dangerous and may lead to serious injury or even death. Use common sense when training, to obtain instruction in the proper execution of movements, and understand your limitations. This equipment must only be used by competent and responsible person, or under the direct and visual control of a competent and responsible person. Obtaining instructions in appropriate techniques and methods of use is your own responsibility. You assume all risks and responsibilities for all damage, injury or death which may occur during or following incorrect installation or use of this equipment in any matter whatsoever. Rogue Fitness bears no liability beyond the replacement value of the equipment in question.



WARNING

MISUSE OF THIS CAN RESULT IN SEVERE INJURY

BOTH ROGUE FITNESS AND BUYER DISCLAIM ANY EXPRESS OR IMPLIED WARRANTY, INCLUDING, WITHOUT LIMITATION, WARRANTIES OR MERCHANTABILITY AND/OR FITNESS FOR A PARTICULAR PURPOSE WITH RESPECT TO THE EQUIPMENT. BUYER ASSUMES ALL LIABILITY IN USE OF EQUIPMENT

ROGUE

ECHO BIKE CUSTOMER INSTRUCTIONS (SHEET 3)

STEP 2: ATTACH THE BASE FRONT FOOT (1) AND BASE REAR FOOT (11) TO THE MAIN FRAME USING TWO SETS OF M8*20 BUTTON HEAD SCREWS (9), M8 LOCK WASHERS (7) AND M8 FLAT WASHERS (10).

***NOTE ORIENTATION OF LOGO ON BOTH THE BASE FRONT AND REAR FEET**

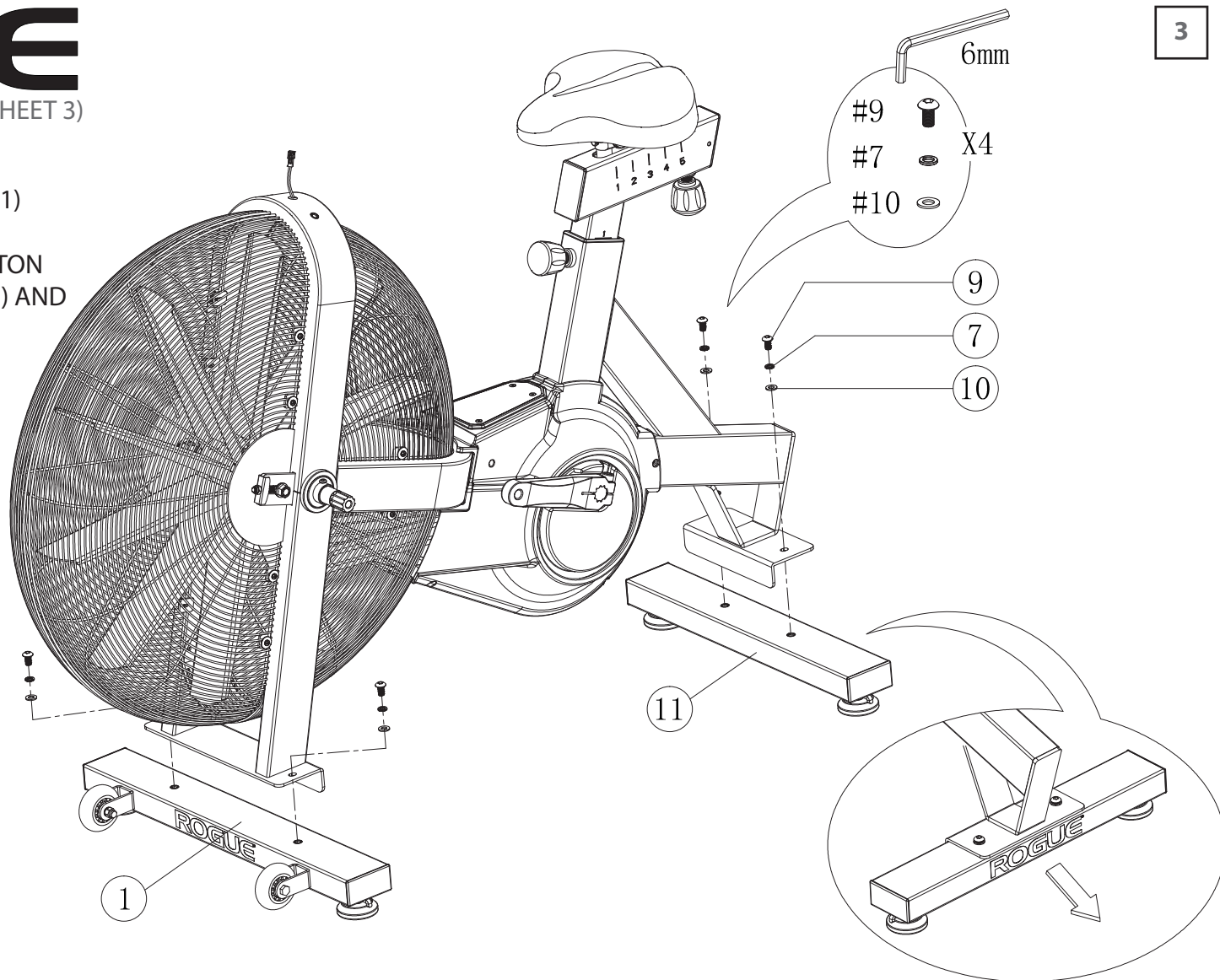

DISCLAIMER

Resistance training, gymnastics training, and activities at height are potentially dangerous and may lead to serious injury or even death. Use common sense when training, to obtain instruction in the proper execution of movements, and understand your limitations. This equipment must only be used by competent and responsible person, or under the direct and visual control of a competent and responsible person. Obtaining instructions in appropriate techniques and methods of use is your own responsibility. You assume all risks and responsibilities for all damage, injury or death which may occur during or following incorrect installation or use of this equipment in any matter whatsoever. Rogue Fitness bears no liability beyond the replacement value of the equipment in question.

⚠️ WARNING ⚠️

MISUSE OF THIS CAN RESULT IN SEVERE INJURY

BOTH ROGUE FITNESS AND BUYER DISCLAIM ANY EXPRESS OR IMPLIED WARRANTY, INCLUDING, WITHOUT LIMITATION, WARRANTIES OR MERCHANTABILITY AND/OR FITNESS FOR A PARTICULAR PURPOSE WITH RESPECT TO THE EQUIPMENT. BUYER ASSUMES ALL LIABILITY IN USE OF EQUIPMENT

ROGUE FITNESS
511 E 5th Ave
Columbus, OH 43201
(614) 358-6190
TEAM@ROGUEFITNESS.COM

ROGUE

ECHO BIKE CUSTOMER INSTRUCTIONS (SHEET 4)

STEP 3: ATTACH THE PEDALS TO THE MAIN FRAME.

***NOTE: THE LEFT PEDAL IS TIGHTENED BY TURNING COUNTER-CLOCKWISE. THE RIGHT PEDAL IS TIGHTENED CLOCKWISE.**

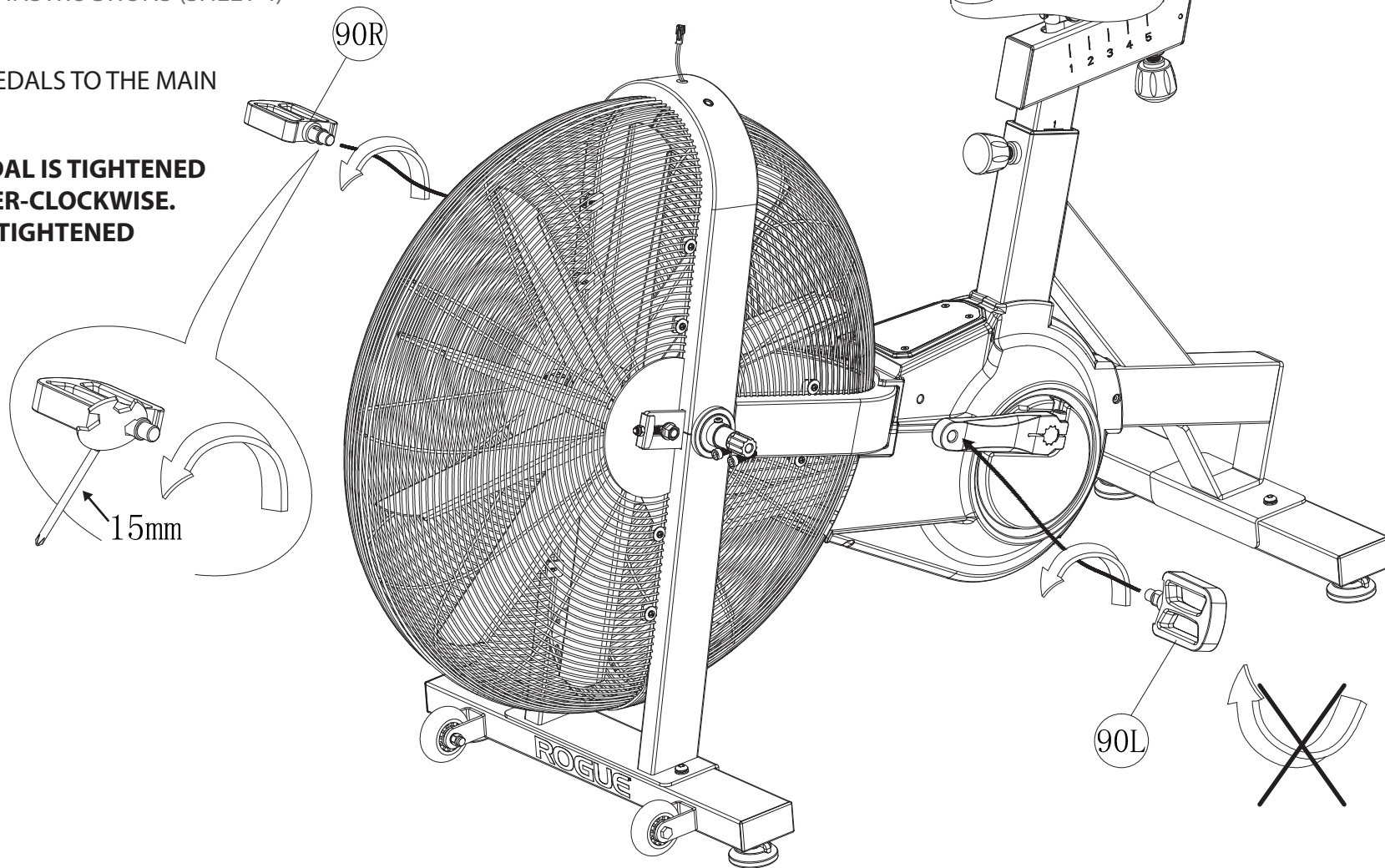

DISCLAIMER

Resistance training, gymnastics training, and activities at height are potentially dangerous and may lead to serious injury or even death. Use common sense when training, to obtain instruction in the proper execution of movements, and understand your limitations. This equipment must only be used by competent and responsible person, or under the direct and visual control of a competent and responsible person. Obtaining instructions in appropriate techniques and methods of use is your own responsibility. You assume all risks and responsibilities for all damage, injury or death which may occur during or following incorrect installation or use of this equipment in any matter whatsoever. Rogue Fitness bears no liability beyond the replacement value of the equipment in question.

⚠️ WARNING ⚠️

MISUSE OF THIS CAN RESULT IN SEVERE INJURY

BOTH ROGUE FITNESS AND BUYER DISCLAIM ANY EXPRESS OR IMPLIED WARRANTY, INCLUDING, WITHOUT LIMITATION, WARRANTIES OR MERCHANTABILITY AND/OR FITNESS FOR A PARTICULAR PURPOSE WITH RESPECT TO THE EQUIPMENT. BUYER ASSUMES ALL LIABILITY IN USE OF EQUIPMENT

ROGUE FITNESS
511 E 5th Ave
Columbus, OH 43201
(614) 358-6190
TEAM@ROGUEFITNESS.COM

ROGUE

ECHO BIKE CUSTOMER INSTRUCTIONS (SHEET 5)

STEP 4.1: ATTACH CABLE (#15) FROM THE BOTTOM OF THE CONSOLE MOUNTING ARM (#16) TO CABLE (#20) EXTENDING UP FROM THE WHEEL FORK.

NOTE: USE CAUTION WHEN ATTACHING CABLE #15 TO CABLE #20 TO ENSURE IT DOES NOT PULL THROUGH THE CONSOLE MOUNTING ARM (#16)

STEP 4.2: CONNECT CONSOLE MOUNTING ARM (#16) TO THE WHEEL FORK USING 2X M8*20mm BUTTON HEAD SCREW (#9), 2X M8 LOCK WASHERS (#7), AND 2X ARC WASHERS (#17)

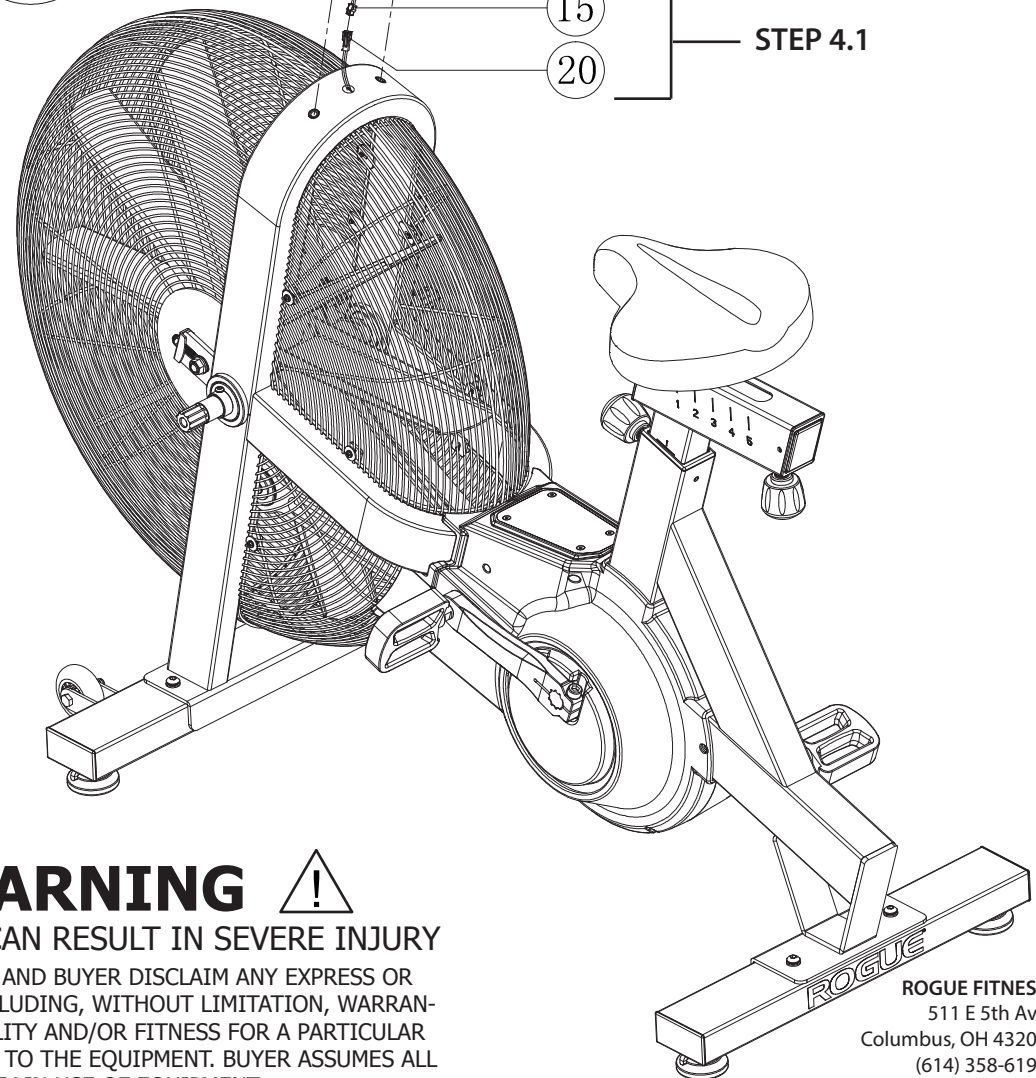
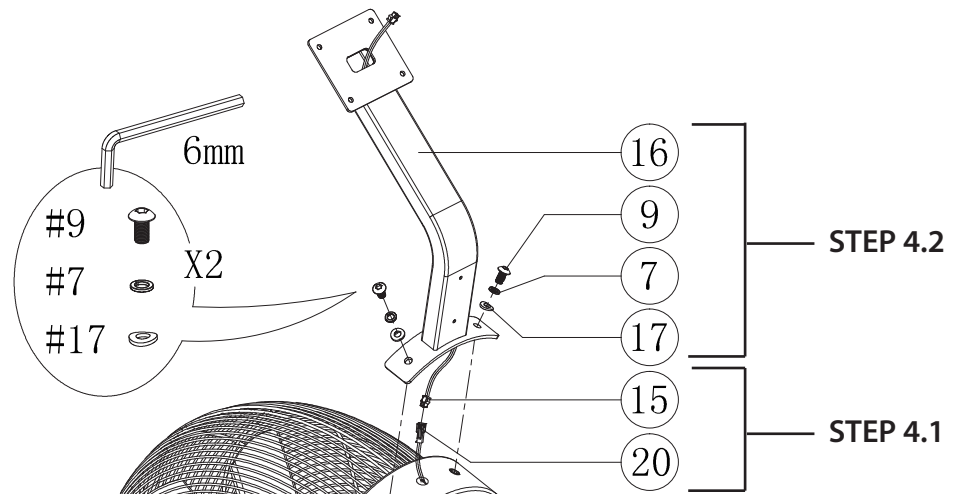

DISCLAIMER

Resistance training, gymnastics training, and activities at height are potentially dangerous and may lead to serious injury or even death. Use common sense when training, to obtain instruction in the proper execution of movements, and understand your limitations. This equipment must only be used by competent and responsible person, or under the direct and visual control of a competent and responsible person. Obtaining instructions in appropriate techniques and methods of use is your own responsibility. You assume all risks and responsibilities for all damage, injury or death which may occur during or following incorrect installation or use of this equipment in any matter whatsoever. Rogue Fitness bears no liability beyond the replacement value of the equipment in question.

⚠️ WARNING ⚠️

MISUSE OF THIS CAN RESULT IN SEVERE INJURY

BOTH ROGUE FITNESS AND BUYER DISCLAIM ANY EXPRESS OR IMPLIED WARRANTY, INCLUDING, WITHOUT LIMITATION, WARRANTIES OR MERCHANTABILITY AND/OR FITNESS FOR A PARTICULAR PURPOSE WITH RESPECT TO THE EQUIPMENT. BUYER ASSUMES ALL LIABILITY IN USE OF EQUIPMENT

ROGUE FITNESS

511 E 5th Ave

Columbus, OH 43201

(614) 358-6190

TEAM@ROGUEFITNESS.COM

ROGUE

ECHO BIKE CUSTOMER INSTRUCTIONS (SHEET 6)

STEP 5.1: ATTACH CABLE (#15) FROM THE TOP OF THE CONSOLE MOUNTING ARM (#16) TO CABLE (A) EXTENDING FROM THE CONSOLE (#12).

STEP 5.2: CONNECT CONSOLE (#12) TO THE CONSOLE MOUNTING ARM (#16) USING 4X M5*10 PAN HEAD SCREWS (#13). SEE NOTE BELOW. DO NOT OVERTIGHTEN SCREWS.

STEP 5.3: INSTALL (2) AA BATTERIES (INCLUDED) INTO BATTERY COMPARTMENT.

***NOTE: M5*10 PAN HEAD SCREWS (#13) IN STEP 5.2 ARE PRE-INSTALLED INTO THE BACK OF THE CONSOLE (#12). SEE DETAIL A BELOW**

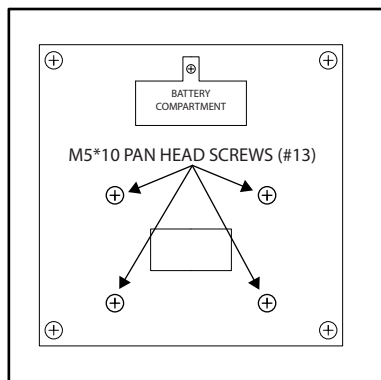
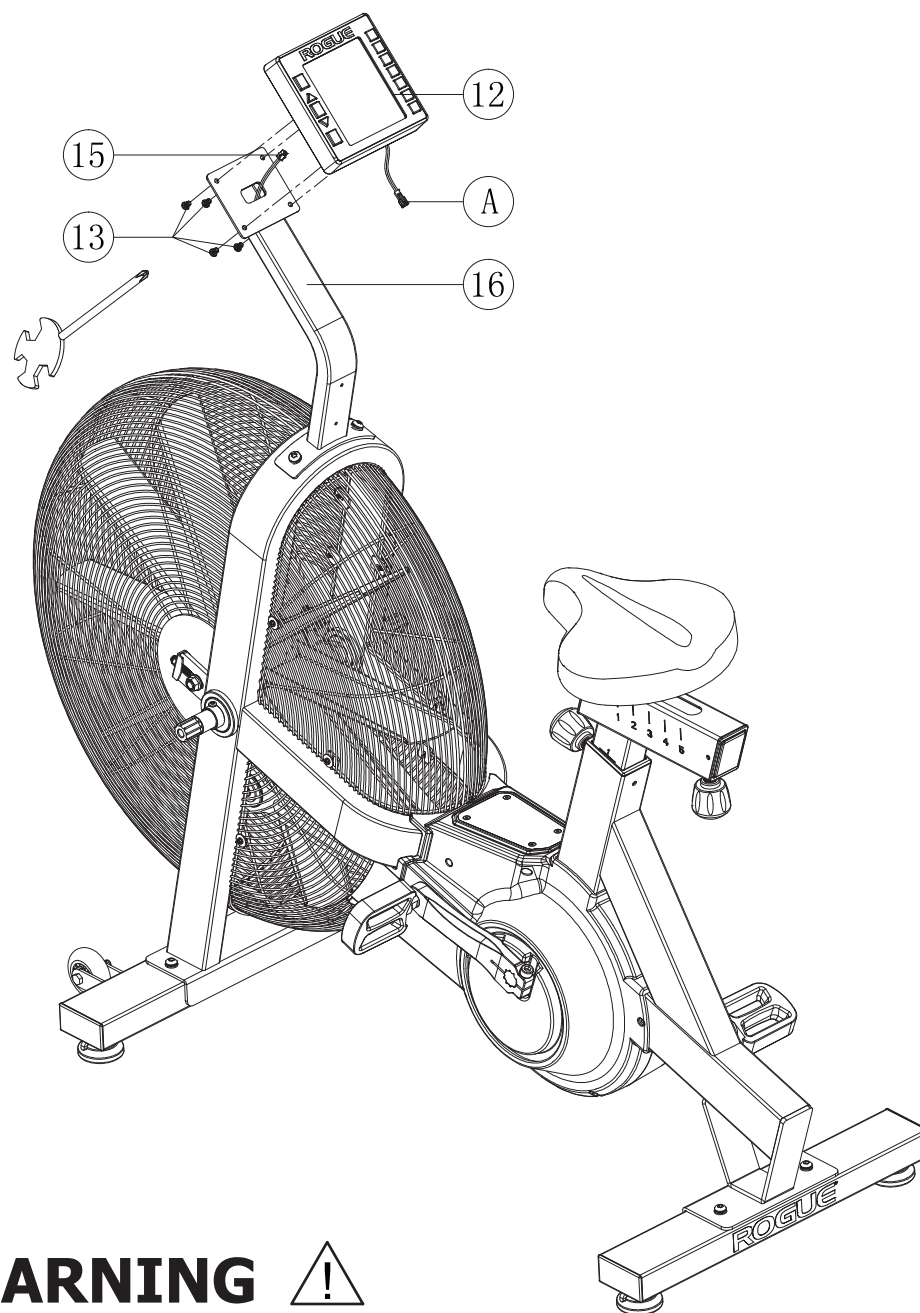

DETAIL A : BACK OF CONSOLE (#12)

DISCLAIMER

Resistance training, gymnastics training, and activities at height are potentially dangerous and may lead to serious injury or even death. Use common sense when training, to obtain instruction in the proper execution of movements, and understand your limitations. This equipment must only be used by competent and responsible person, or under the direct and visual control of a competent and responsible person. Obtaining instructions in appropriate techniques and methods of use is your own responsibility. You assume all risks and responsibilities for all damage, injury or death which may occur during or following incorrect installation or use of this equipment in any matter whatsoever. Rogue Fitness bears no liability beyond the replacement value of the equipment in question.

⚠️ WARNING ⚠️

MISUSE OF THIS CAN RESULT IN SEVERE INJURY

BOTH ROGUE FITNESS AND BUYER DISCLAIM ANY EXPRESS OR IMPLIED WARRANTY, INCLUDING, WITHOUT LIMITATION, WARRANTIES OR MERCHANTABILITY AND/OR FITNESS FOR A PARTICULAR PURPOSE WITH RESPECT TO THE EQUIPMENT. BUYER ASSUMES ALL LIABILITY IN USE OF EQUIPMENT

ROGUE FITNESS
511 E 5th Ave
Columbus, OH 43201
(614) 358-6190
TEAM@ROGUEFITNESS.COM

ROGUE

ECHO BIKE CUSTOMER INSTRUCTIONS (SHEET 7)

STEP 6: ATTACH LEFT HANDLE ASSEMBLY (#24) AND RIGHT HANDLE ASSEMBLY (#25) TO THE MAIN FRAME USING M8*30mm SCREWS (#31) AND M8 LOCK WASHERS (#7).

***NOTE: ENSURE THE SOCKET OF EACH HANDLEBAR IS FULLY INSTALLED ONTO THE AXLE. SEE DETAIL B.**

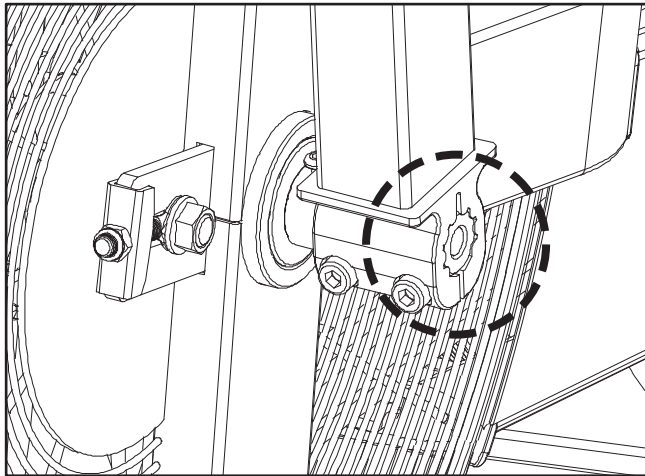

DETAIL B

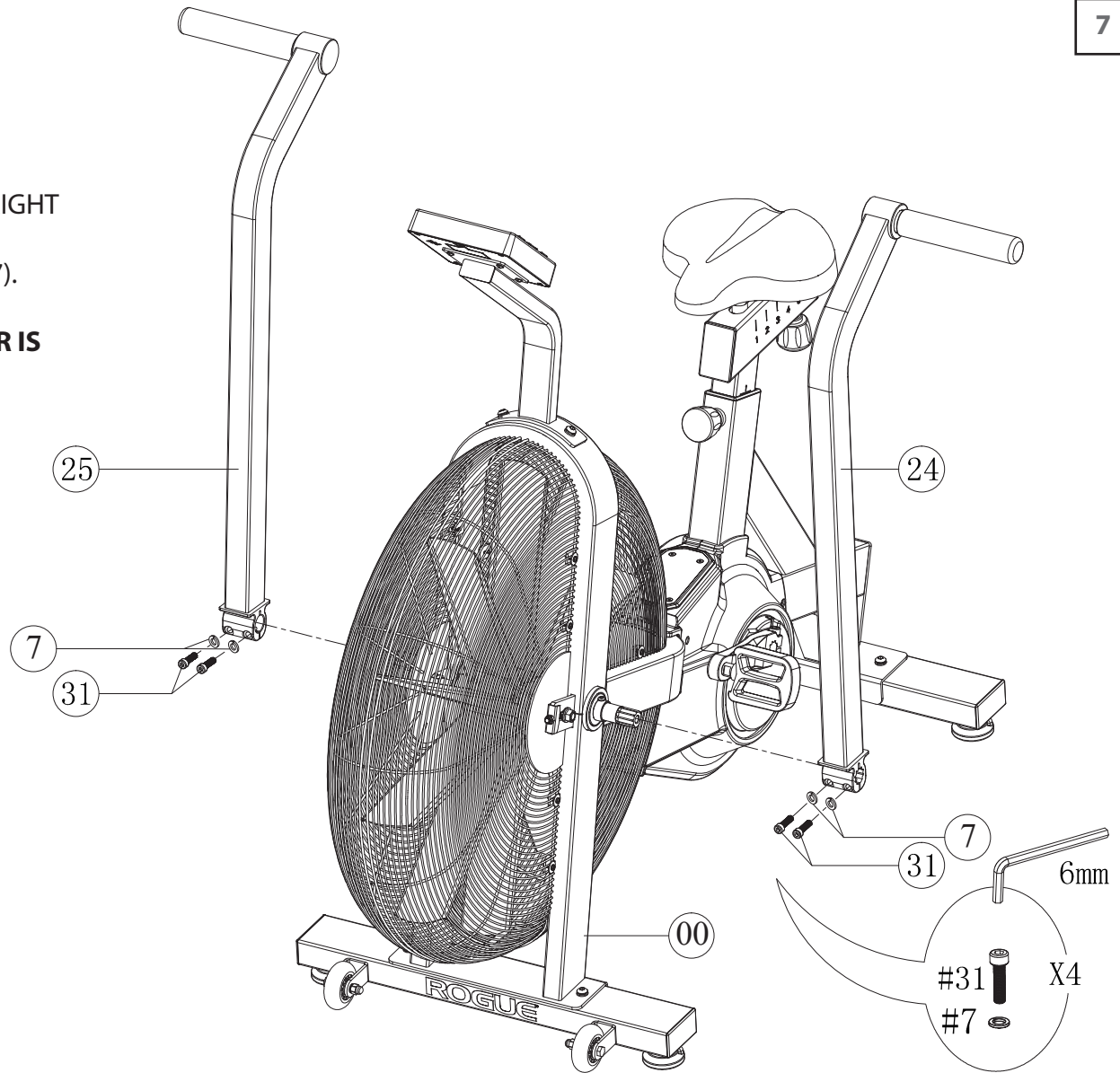

DISCLAIMER

Resistance training, gymnastics training, and activities at height are potentially dangerous and may lead to serious injury or even death. Use common sense when training, to obtain instruction in the proper execution of movements, and understand your limitations. This equipment must only be used by competent and responsible person, or under the direct and visual control of a competent and responsible person. Obtaining instructions in appropriate techniques and methods of use is your own responsibility. You assume all risks and responsibilities for all damage, injury or death which may occur during or following incorrect installation or use of this equipment in any matter whatsoever. Rogue Fitness bears no liability beyond the replacement value of the equipment in question.

⚠️ WARNING ⚠️

MISUSE OF THIS CAN RESULT IN SEVERE INJURY

BOTH ROGUE FITNESS AND BUYER DISCLAIM ANY EXPRESS OR IMPLIED WARRANTY, INCLUDING, WITHOUT LIMITATION, WARRANTIES OR MERCHANTABILITY AND/OR FITNESS FOR A PARTICULAR PURPOSE WITH RESPECT TO THE EQUIPMENT. BUYER ASSUMES ALL LIABILITY IN USE OF EQUIPMENT

ROGUE FITNESS

511 E 5th Ave

Columbus, OH 43201

(614) 358-6190

TEAM@ROGUEFITNESS.COM

ROGUE

ECHO BIKE CUSTOMER INSTRUCTIONS (SHEET 8)

STEP 7: ATTACH FOOT PEGS (#28) TO THE MAIN FRAME USING FOOT PEG BOLT (#26), FOOT PEG SPACER (#29), AND THE LARGE WASHERS (#30).

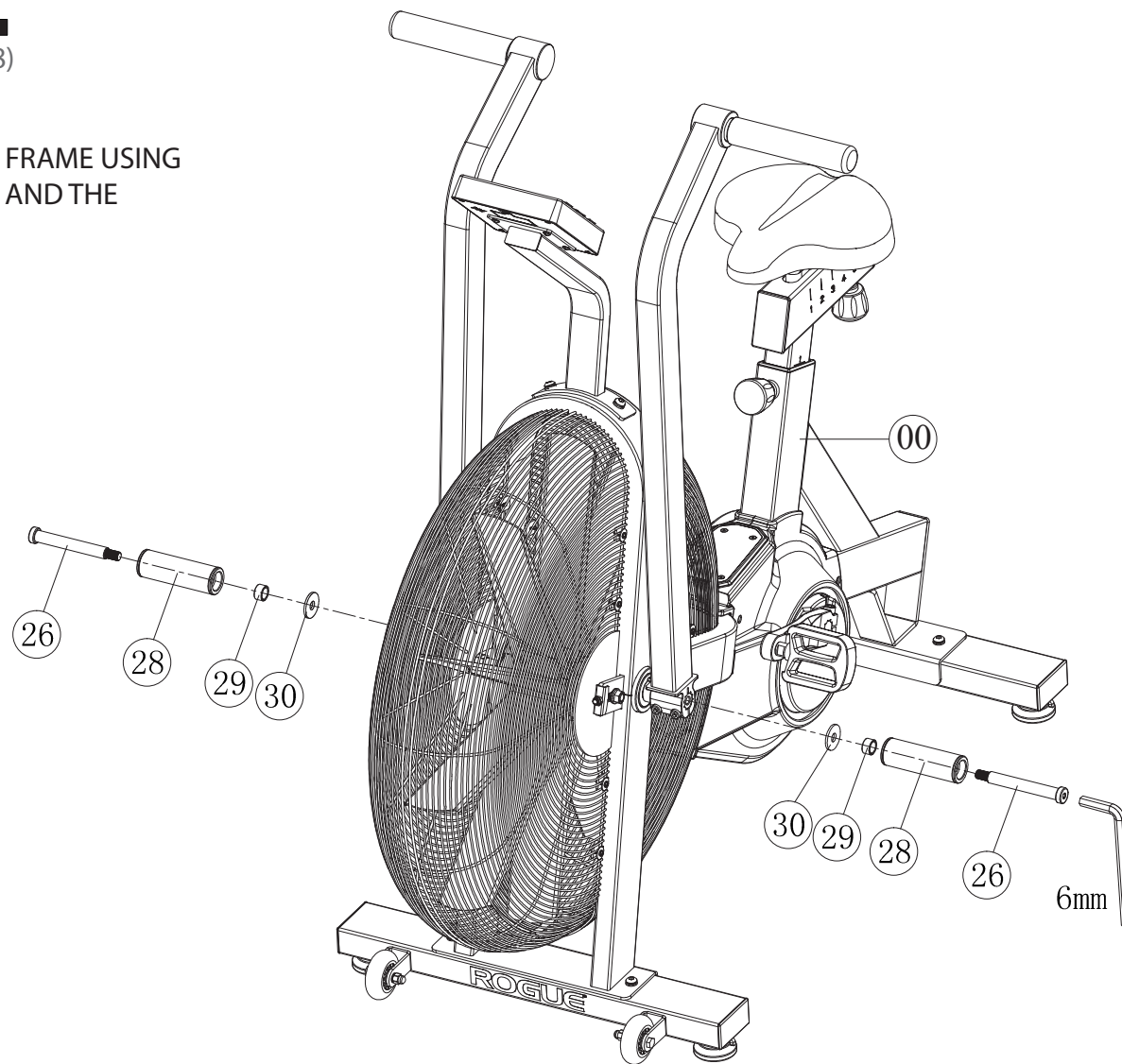

DISCLAIMER

Resistance training, gymnastics training, and activities at height are potentially dangerous and may lead to serious injury or even death. Use common sense when training, to obtain instruction in the proper execution of movements, and understand your limitations. This equipment must only be used by competent and responsible person, or under the direct and visual control of a competent and responsible person. Obtaining instructions in appropriate techniques and methods of use is your own responsibility. You assume all risks and responsibilities for all damage, injury or death which may occur during or following incorrect installation or use of this equipment in any matter whatsoever. Rogue Fitness bears no liability beyond the replacement value of the equipment in question.

⚠️ WARNING ⚠️

MISUSE OF THIS CAN RESULT IN SEVERE INJURY

BOTH ROGUE FITNESS AND BUYER DISCLAIM ANY EXPRESS OR IMPLIED WARRANTY, INCLUDING, WITHOUT LIMITATION, WARRANTIES OR MERCHANTABILITY AND/OR FITNESS FOR A PARTICULAR PURPOSE WITH RESPECT TO THE EQUIPMENT. BUYER ASSUMES ALL LIABILITY IN USE OF EQUIPMENT

ROGUE FITNESS
511 E 5th Ave
Columbus, OH 43201
(614) 358-6190
TEAM@ROGUEFITNESS.COM

ROGUE

ECHO BIKE CUSTOMER INSTRUCTIONS (SHEET 9)

INCLUDED PARTS (COMPONENTS)

*NOTE: IMAGES NOT SHOWN TO SCALE

ITEM #	QTY.	DESCRIPTION
00	1	BIKE MAIN FRAME
1	1	BASE FRONT FOOT
11	1	BASE REAR FOOT
12	1	CONSOLE
16	1	CONSOLE MOUNTING ARM
24	1	LEFT HANDLE ASSEMBLY
25	1	RIGHT HANDLE ASSEMBLY
28	2	FOOT PEG
90R/L	1	PEDAL SET
S6	1	6mm HEX KEY
S4	1	4mm HEX KEY
S13/14/15	1	WRENCH / SCREWDRIVER

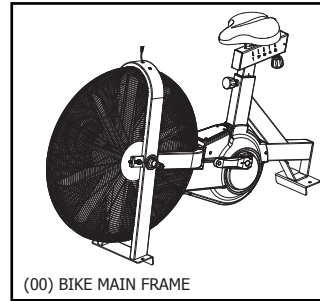

(00) BIKE MAIN FRAME

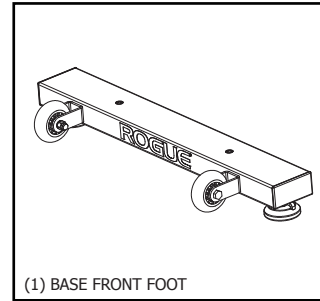

(1) BASE FRONT FOOT

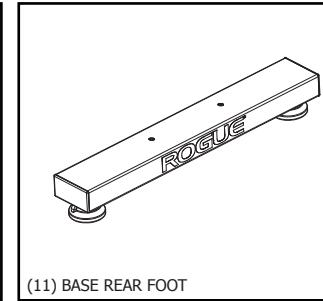

(11) BASE REAR FOOT

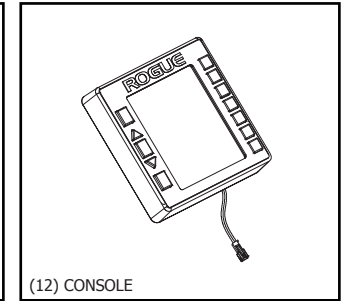

(12) CONSOLE

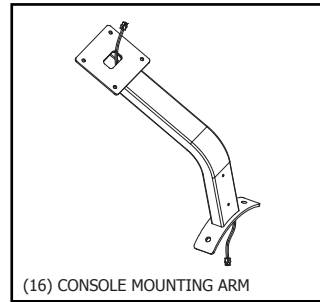

(16) CONSOLE MOUNTING ARM

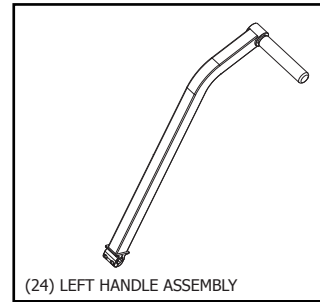

(24) LEFT HANDLE ASSEMBLY

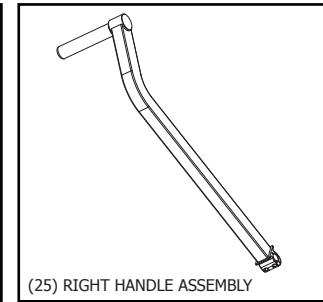

(25) RIGHT HANDLE ASSEMBLY

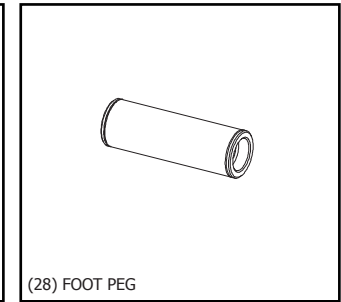

(28) FOOT PEG

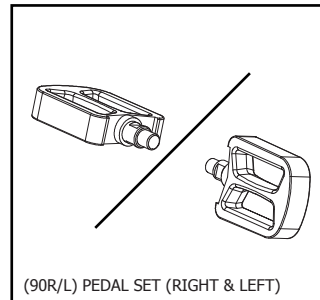

(90R/L) PEDAL SET (RIGHT & LEFT)

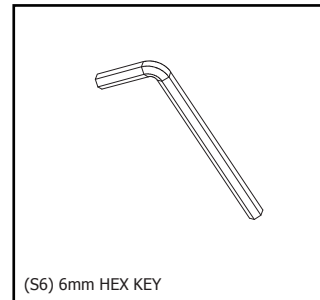

(S6) 6mm HEX KEY

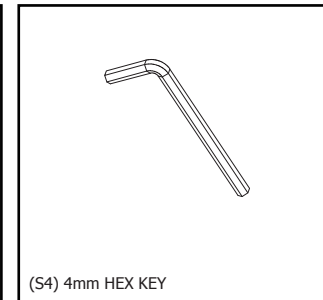

(S4) 4mm HEX KEY

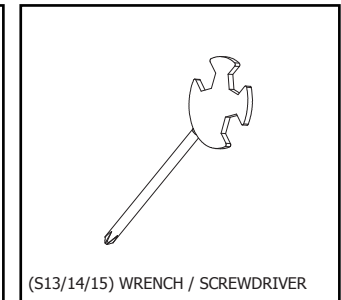

(S13/14/15) WRENCH / SCREWDRIVER

****SEE SHEET 10 FOR
HARDWARE****

DISCLAIMER

Resistance training, gymnastics training, and activities at height are potentially dangerous and may lead to serious injury or even death. Use common sense when training, to obtain instruction in the proper execution of movements, and understand your limitations. This equipment must only be used by competent and responsible person, or under the direct and visual control of a competent and responsible person. Obtaining instructions in appropriate techniques and methods of use is your own responsibility. You assume all risks and responsibilities for all damage, injury or death which may occur during or following incorrect installation or use of this equipment in any matter whatsoever. Rogue Fitness bears no liability beyond the replacement value of the equipment in question.



WARNING

MISUSE OF THIS CAN RESULT IN SEVERE INJURY

BOTH ROGUE FITNESS AND BUYER DISCLAIM ANY EXPRESS OR IMPLIED WARRANTY, INCLUDING, WITHOUT LIMITATION, WARRANTIES OR MERCHANTABILITY AND/OR FITNESS FOR A PARTICULAR PURPOSE WITH RESPECT TO THE EQUIPMENT. BUYER ASSUMES ALL LIABILITY IN USE OF EQUIPMENT

ROGUE FITNESS
511 E 5th Ave
Columbus, OH 43201
(614) 358-6190
TEAM@ROGUEFITNESS.COM

ROGUE

ECHO BIKE CUSTOMER INSTRUCTIONS (SHEET 10)

ITEM # QTY. DESCRIPTION

7	10	M8 LOCK WASHER
9	6	M8*20mm BUTTON HEAD SCREW
10	4	M8 FLAT WASHER
17	2	M8 ARC WASHER
18*	2	M5 SPRING WASHER*
19*	2	M5*15mm SCREW*
26	2	FOOT PEG BOLT
29	2	FOOT PEG SPACER
30	2	LARGE WASHER
31	4	M8*30mm SCREW

***NOTE : ITEM #'S 18 & 19 ARE OPTIONAL HARDWARE THAT CAN BE USED TO ATTACH BOTTLE CAGE (NOT INCLUDED) TO CONSOLE MOUNTING ARM (#16).**

INCLUDED PARTS (HARDWARE)

*NOTE: IMAGES NOT SHOWN TO SCALE

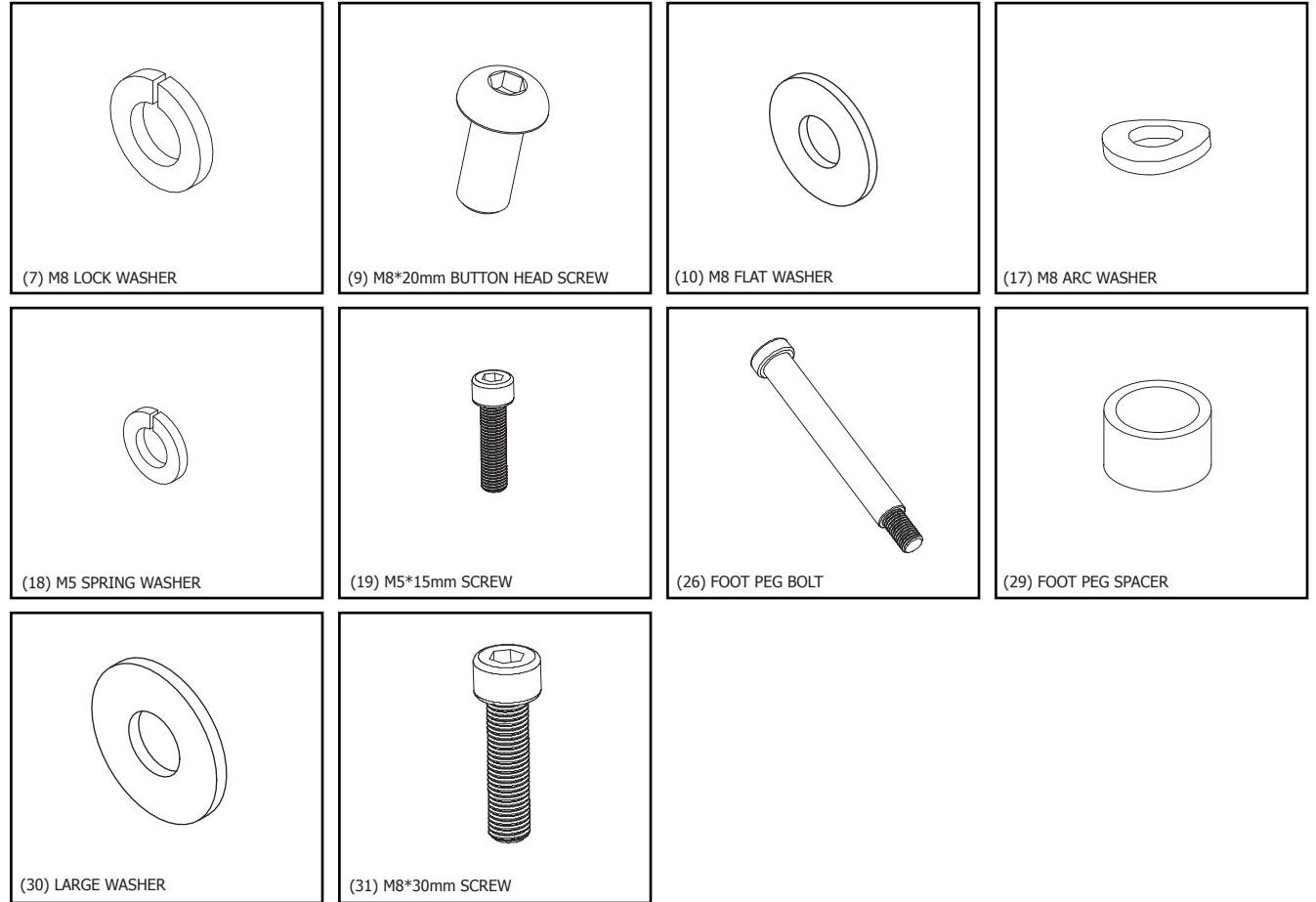

DISCLAIMER

Resistance training, gymnastics training, and activities at height are potentially dangerous and may lead to serious injury or even death. Use common sense when training, to obtain instruction in the proper execution of movements, and understand your limitations. This equipment must only be used by competent and responsible person, or under the direct and visual control of a competent and responsible person. Obtaining instructions in appropriate techniques and methods of use is your own responsibility. You assume all risks and responsibilities for all damage, injury or death which may occur during or following incorrect installation or use of this equipment in any matter whatsoever. Rogue Fitness bears no liability beyond the replacement value of the equipment in question.



WARNING

MISUSE OF THIS CAN RESULT IN SEVERE INJURY

BOTH ROGUE FITNESS AND BUYER DISCLAIM ANY EXPRESS OR IMPLIED WARRANTY, INCLUDING, WITHOUT LIMITATION, WARRANTIES OR MERCHANTABILITY AND/OR FITNESS FOR A PARTICULAR PURPOSE WITH RESPECT TO THE EQUIPMENT. BUYER ASSUMES ALL LIABILITY IN USE OF EQUIPMENT

ROGUE FITNESS
 511 E 5th Ave
 Columbus, OH 43201
 (614) 358-6190
 TEAM@ROGUEFITNESS.COM