

# ROGUE ECHO BIKE V3.0

SEE SHEETS 9 & 10 FOR ITEM DESCRIPTIONS AND QUANTITIES

Version 1.3

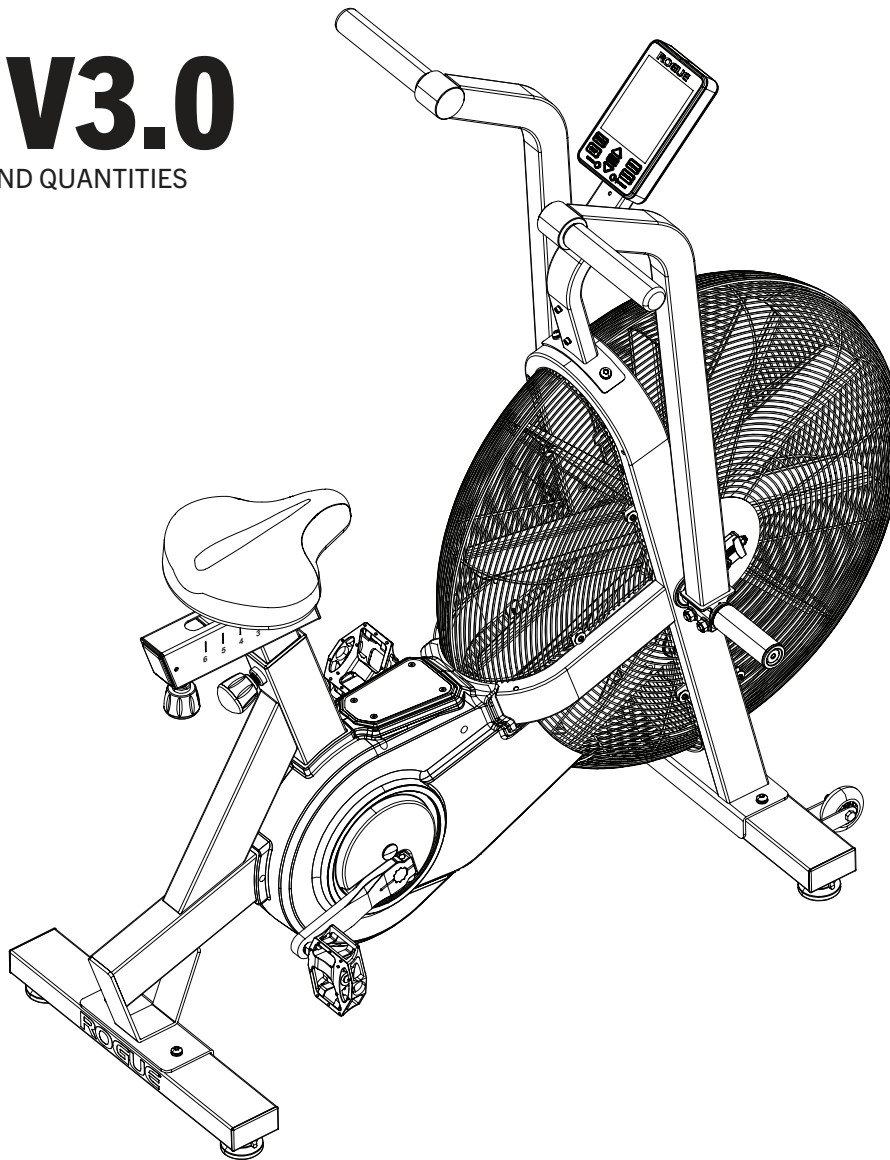

## IMPORTANT SAFETY INFORMATION

### DISCLAIMER:

Resistance training, gymnastics training, and activities at height are potentially dangerous and may lead to severe injury or death. Use common sense when training, obtain instruction in the proper execution of movements, and understand your limitations. This equipment must only be used by competent and responsible persons. Obtaining instruction in appropriate techniques and methods of use is your own responsibility. You assume all risks and responsibilities for all damage, injury or death which may occur during or following incorrect use of this equipment in any matter whatsoever. Rogue Fitness bears no liability beyond the replacement value of the equipment in question.

### WARNING:

#### MISUSE OF THIS CAN RESULT IN SEVERE INJURY.

Both Rogue Fitness and buyer disclaim any express or implied warranty, including, without limitation, warranties or merchantability and/or fitness for a particular purpose with respect to the equipment. Buyer assumes all liability to use of equipment.

ITEM #	QTY.	DESCRIPTION
00	1	BIKE MAIN FRAME
1	1	BASE FRONT FOOT
11	1	BASE REAR FOOT
12	1	CONSOLE
16	1	CONSOLE MOUNTING ARM
24	1	LEFT HANDLE ASSEMBLY
25	1	RIGHT HANDLE ASSEMBLY
28	2	FOOT PEG ASSEMBLY
90R/L	1	PEDAL SET
S6	1	6mm HEX KEY
S4	1	4mm HEX KEY
SCREW DRIVER	1	SCREWDRIVER

**INCLUDED PARTS (COMPONENTS)**  
**\*NOTE: IMAGES NOT SHOWN TO SCALE**

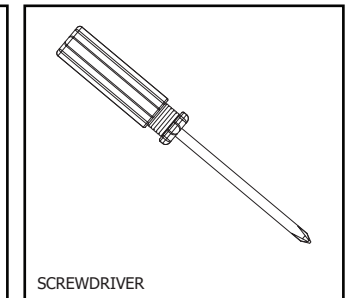
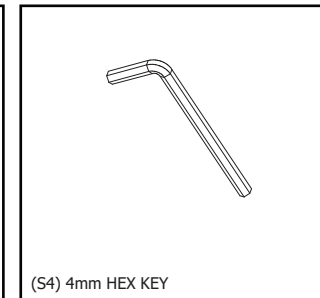
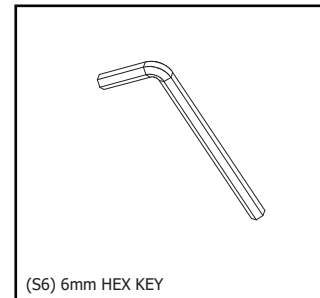
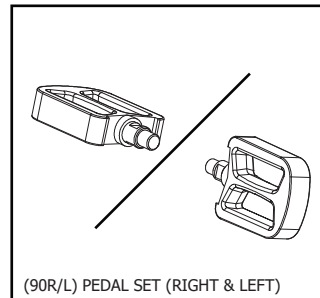
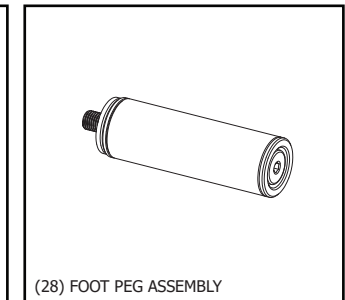
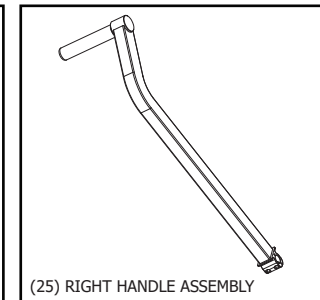
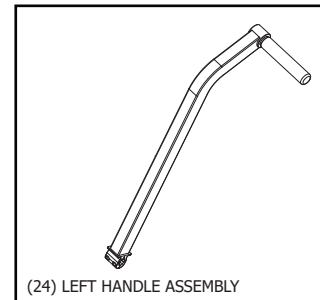
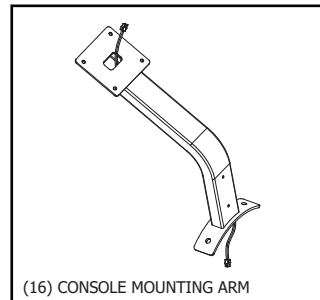
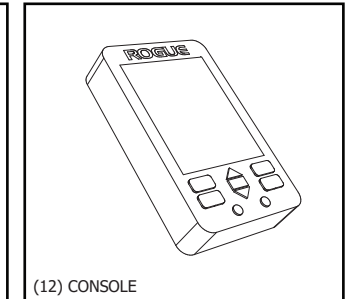
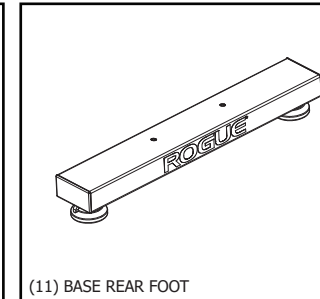
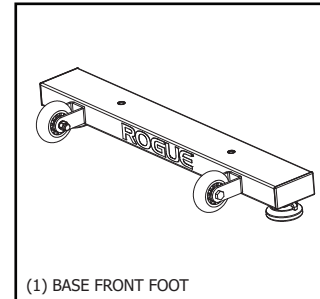
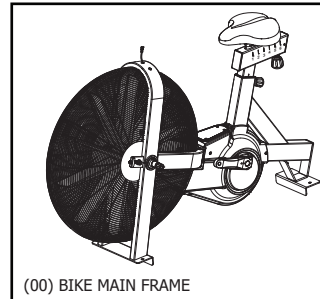

**\*\*SEE SHEET 3 FOR  
HARDWARE\*\***

**INCLUDED PARTS (HARDWARE)**  
**\*NOTE: IMAGES NOT SHOWN TO SCALE**

ITEM #	QTY.	DESCRIPTION
7	10	M8 SPRING WASHER
9	6	M8*20mm BUTTON HEAD SCREW
10	4	M8 FLAT WASHER
17	2	M8 ARC WASHER
31	4	M8*50mm SCREW
112	4	M8 HEXAGON FLANGE NUT
S13/15	1	WRENCH

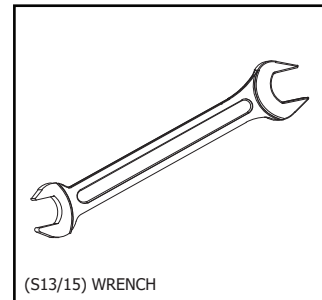
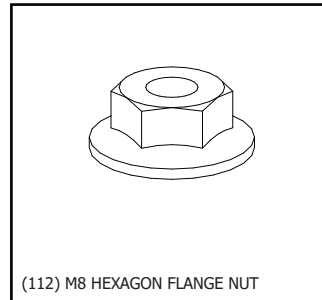
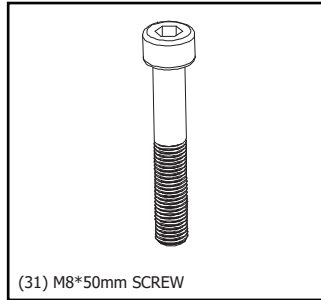
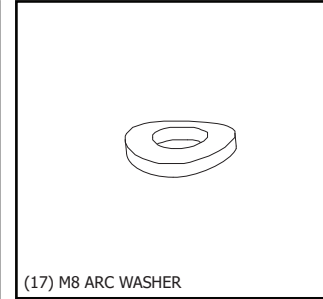
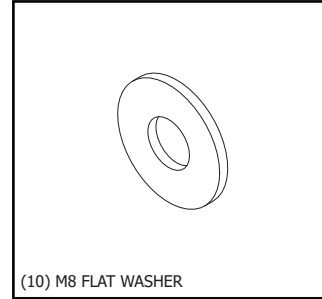
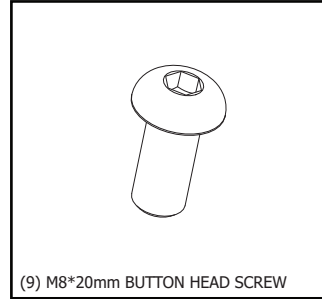
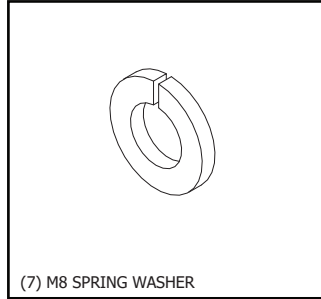

## STEP 1:

- USING THE SCREW DRIVER, REMOVE THE SHIPPING SUPPORT TUBE. TUBE AND HARDWARE MAY BE DISCARDED.

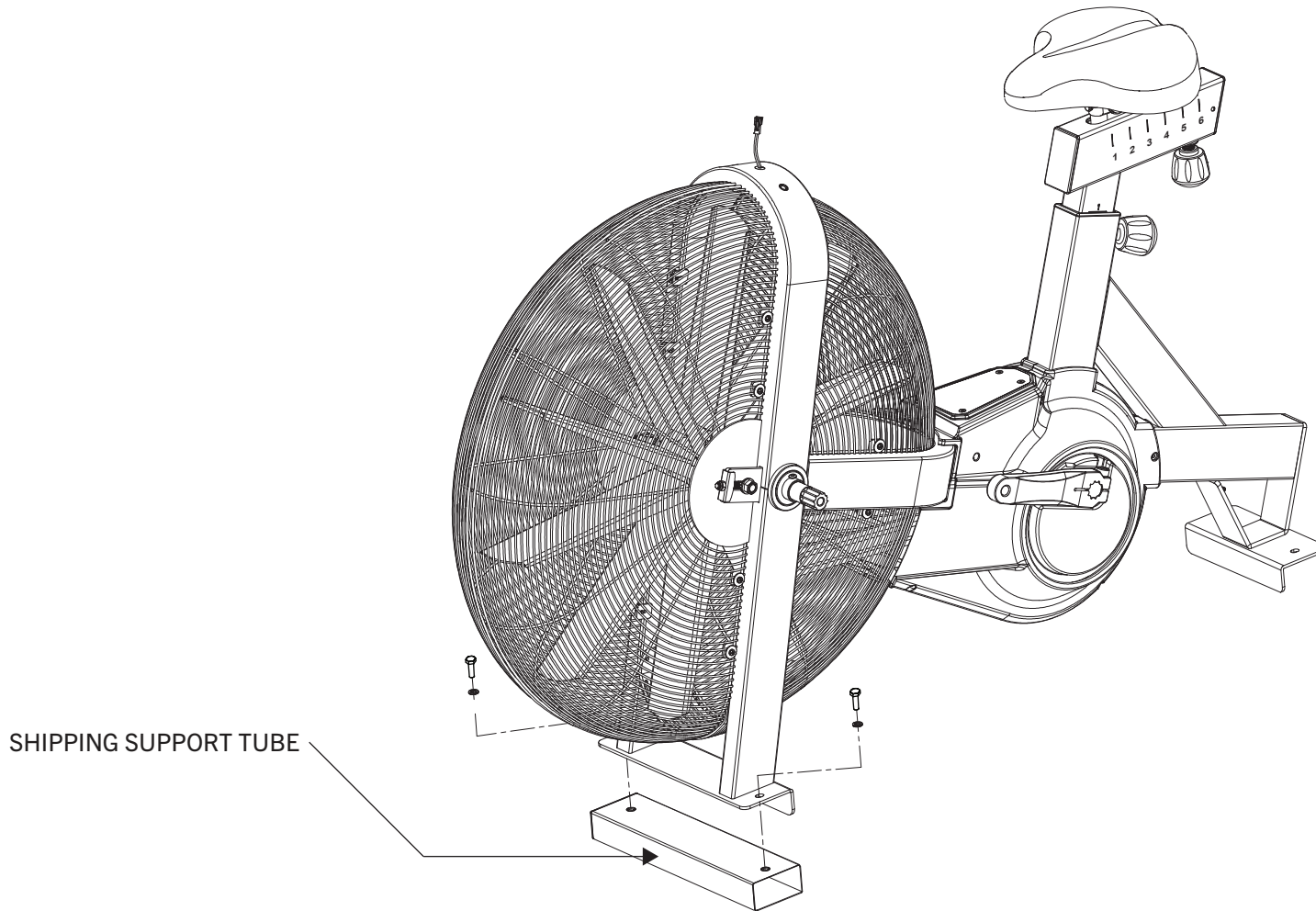

**STEP 2:**

•ATTACH THE BASE FRONT FOOT (1) AND BASE REAR FOOT (11) TO THE MAIN FRAME USING TWO SETS OF M8\*20 BUTTON HEAD SCREWS (9), M8 SPRING WASHERS (7) AND M8 FLAT WASHERS (10).

\*NOTE ORIENTATION OF LOGO ON BOTH THE BASE FRONT AND REAR FEET

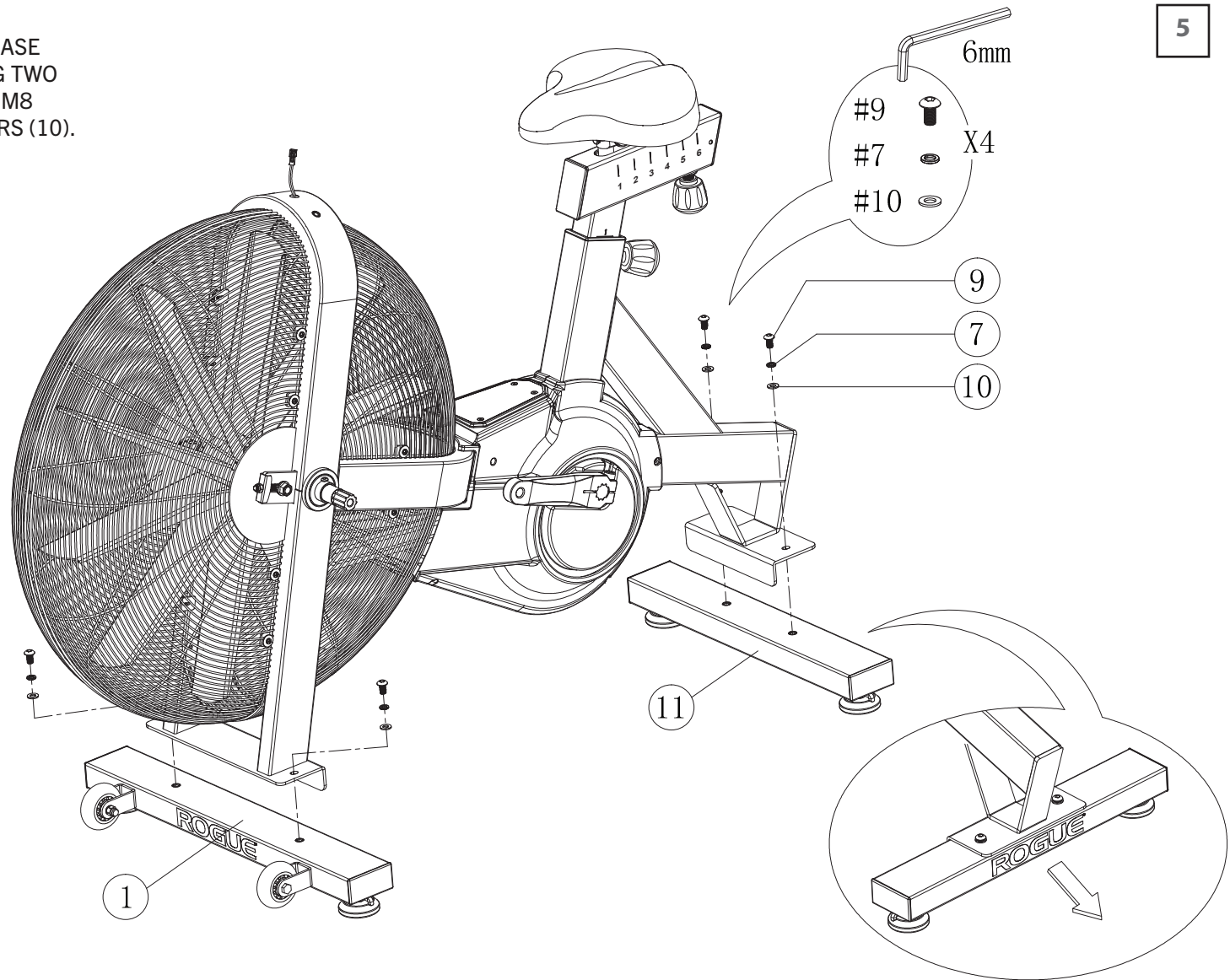

### STEP 3:

- ATTACH THE PEDALS TO THE MAIN FRAME.

\*NOTE: THE LEFT PEDAL IS TIGHTENED BY TURNING COUNTER-CLOCKWISE.  
THE RIGHT PEDAL IS TIGHTENED CLOCKWISE.

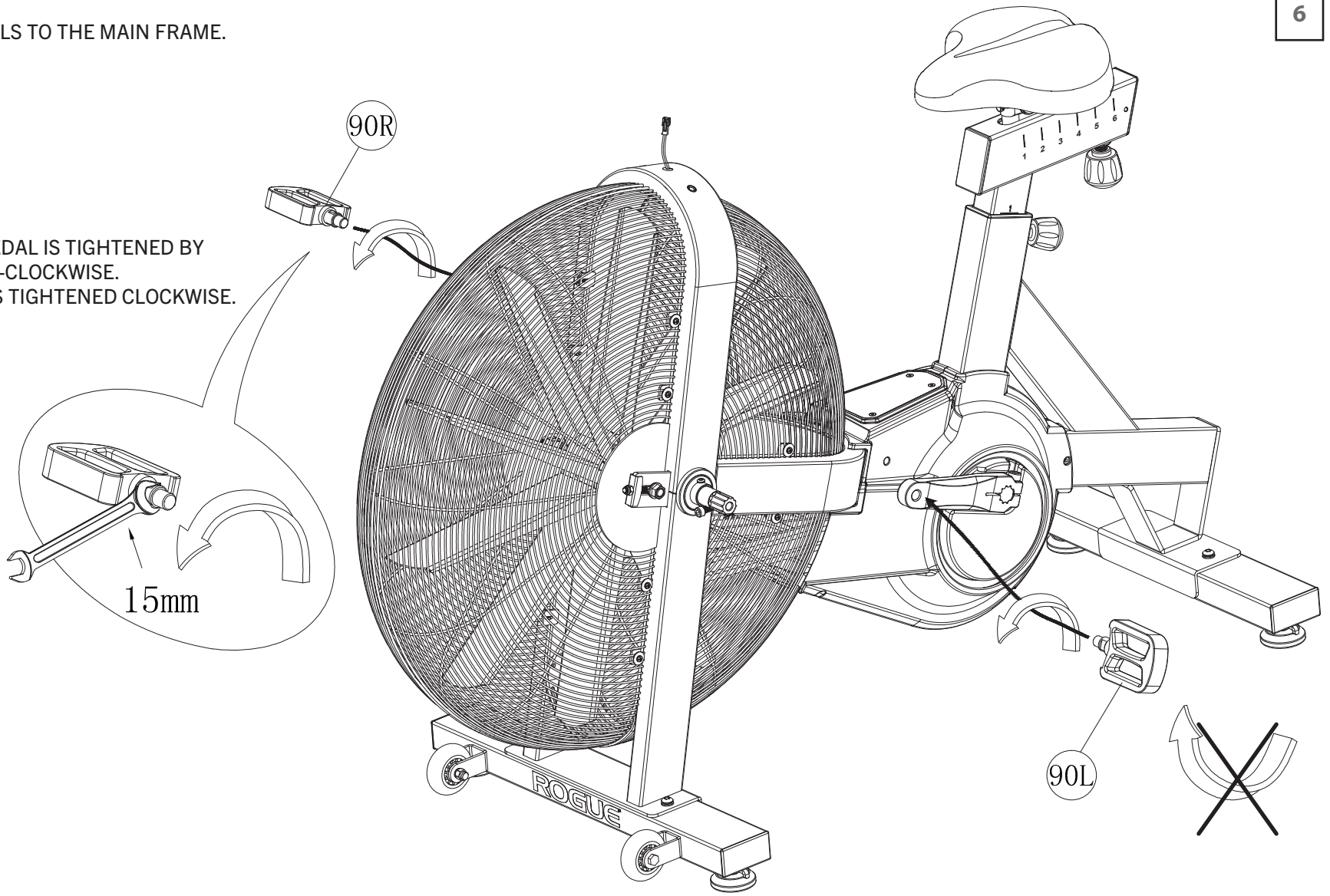

**STEP 4.1:**

•ATTACH CABLE (#15) FROM THE BOTTOM OF THE CONSOLE MOUNTING ARM (#16) TO CABLE (#20) EXTENDING UP FROM THE WHEEL FORK.

**NOTE:** USE CAUTION WHEN ATTACHING CABLE #15 TO CABLE #20 TO ENSURE IT DOES NOT PULL THROUGH THE CONSOLE MOUNTING ARM (#16)

**STEP 4.2:**

•CONNECT CONSOLE MOUNTING ARM (#16) TO THE WHEEL FORK USING 2X M8\*20mm BUTTON HEAD SCREW (#9), 2X M8 SPRING WASHERS (#7), AND 2X ARC WASHERS (#17).

**NOTE:** GENTLY PULL UP ON CABLE #15 FROM THE TOP OF THE CONSOLE MOUNTING ARM (#16) DURING STEP 4.2. THIS WILL ENSURE THAT THE CABLE DOES NOT GET SMASHED BETWEEN THE CONSOLE MOUNTING ARM (#16) AND THE WHEEL FORK WHICH MAY CAUSE DAMAGE.

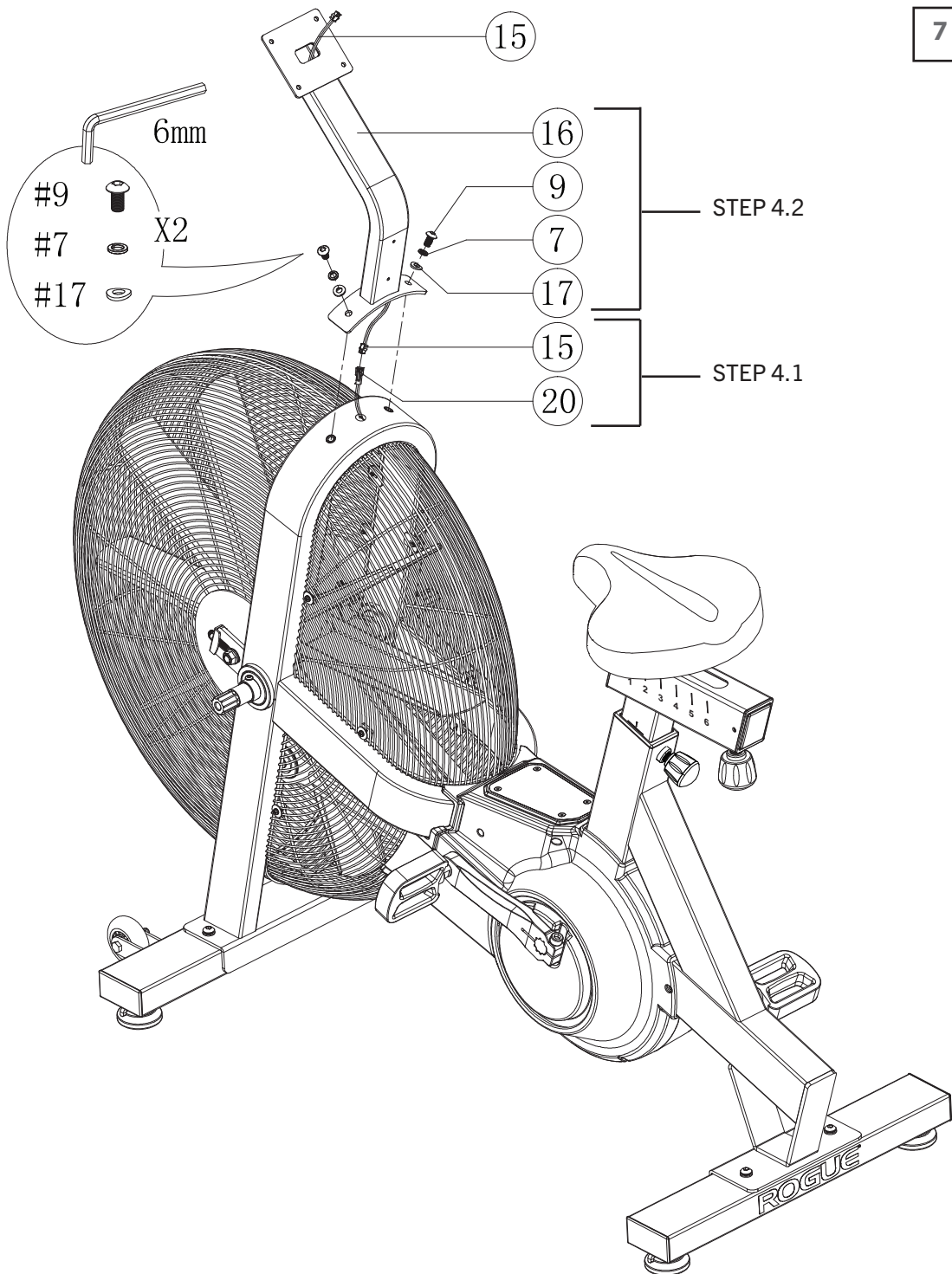

**STEP 5.1:**

ATTACH CABLE (#15) FROM THE TOP OF THE CONSOLE MOUNTING ARM (#16) TO CABLE (A) EXTENDING FROM THE CONSOLE (#12). GENTLY FEED EXCESS CABLE BACK DOWN INTO THE CONSOLE MOUNTING ARM. THIS WILL ENSURE THAT THE CABLE DOES NOT GET SMASHED BETWEEN THE CONSOLE AND THE CONSOLE MOUNTING ARM WHICH MAY CAUSE DAMAGE.

**STEP 5.2:**

CONNECT CONSOLE (#12) TO THE CONSOLE MOUNTING ARM (#16) USING 4X M5\*10 PAN HEAD SCREWS (#13). SEE NOTE BELOW. DO NOT OVERTIGHTEN SCREWS.

**STEP 5.3:**

INSTALL (4) AA BATTERIES (INCLUDED) INTO BATTERY COMPARTMENT.

\*NOTE: M5\*10 PAN HEAD SCREWS (#13) IN STEP 5.2 ARE PRE-INSTALLED INTO THE BACK OF THE CONSOLE (#12). SEE DETAIL A BELOW

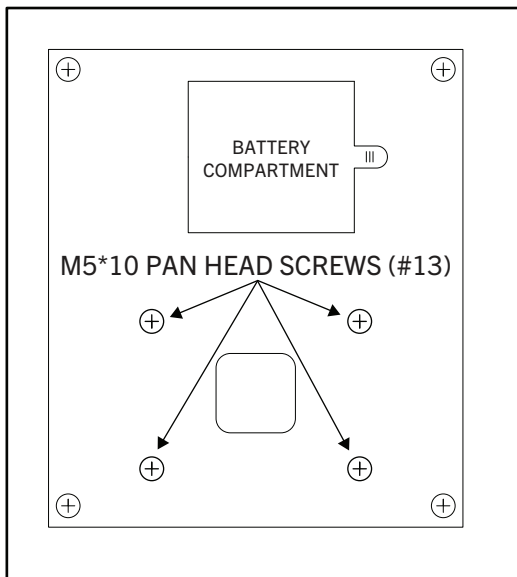
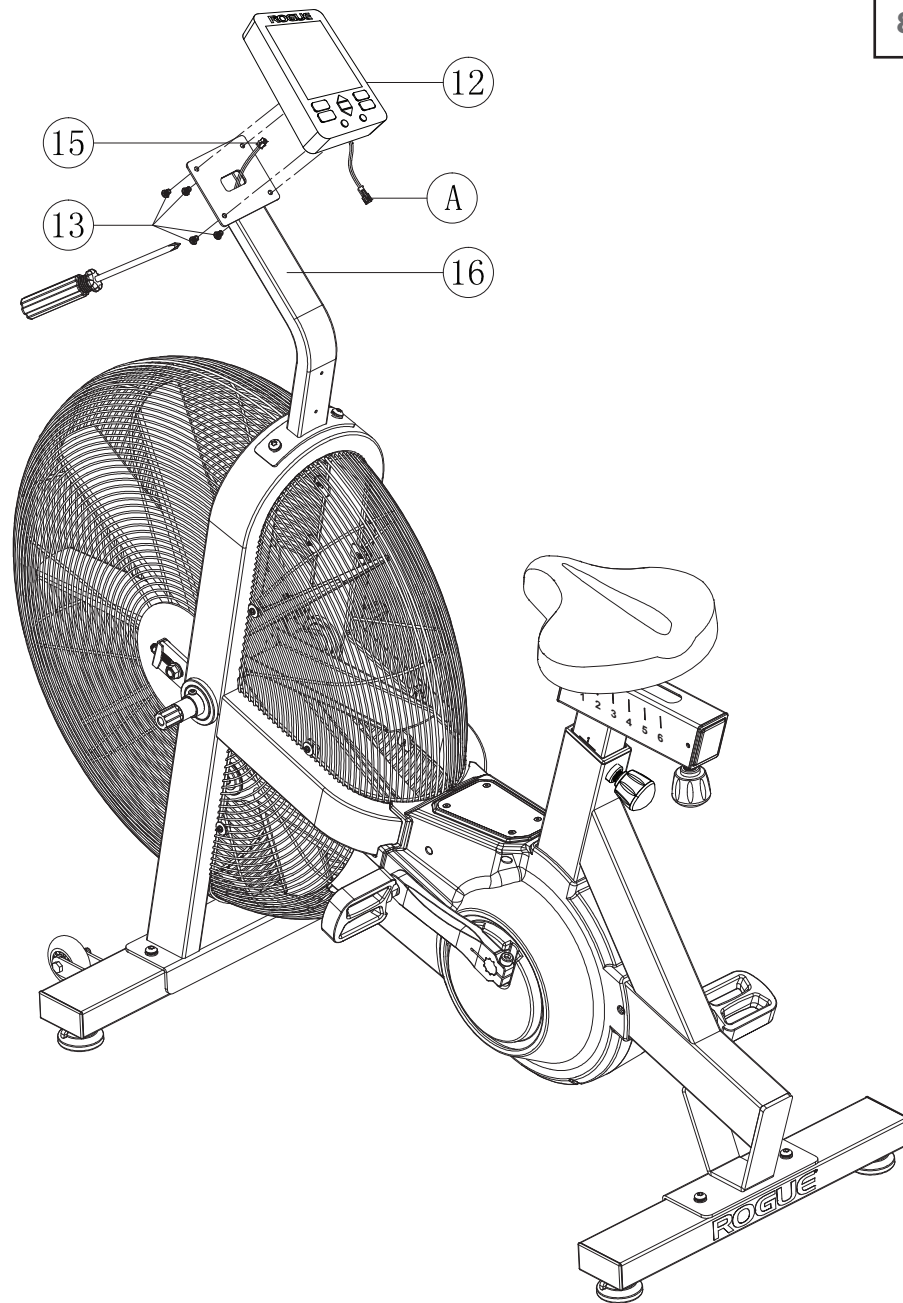

**DETAIL A :**

BACK OF CONSOLE (#12)

**STEP 6:**  
SLIDE LEFT HANDLE ASSEMBLY (#24) AND RIGHT HANDLE ASSEMBLY (#25) ON TO THE MAIN FRAME SPINDLE.

\*NOTE: SLOT IN THE HANDLE ASSEMBLY WILL ALIGN WITH THE WHITE LINE ON THE SPINDLE. SEE DETAIL B.

\*NOTE: ENSURE THE SOCKET OF EACH HANDLEBAR IS FULLY INSTALLED ONTO THE AXLE. SEE DETAIL C.

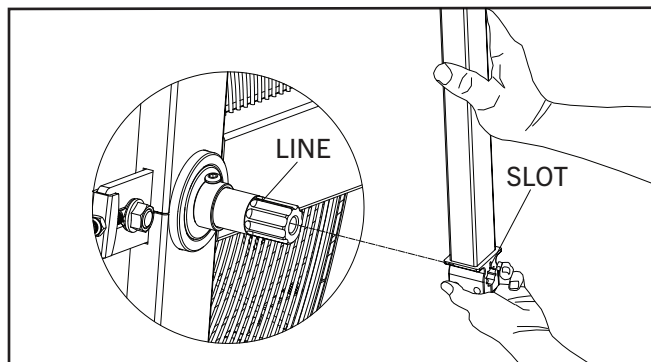

**DETAIL B**

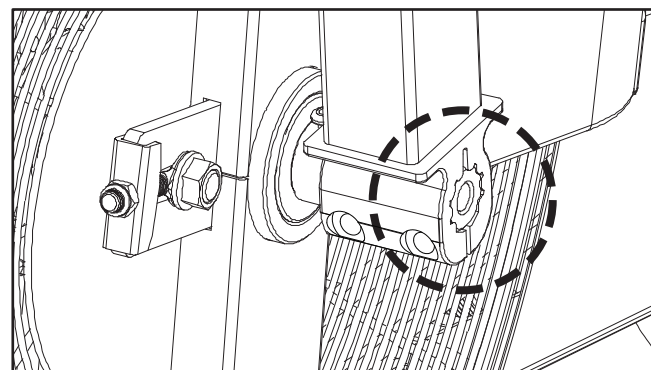

**DETAIL C**

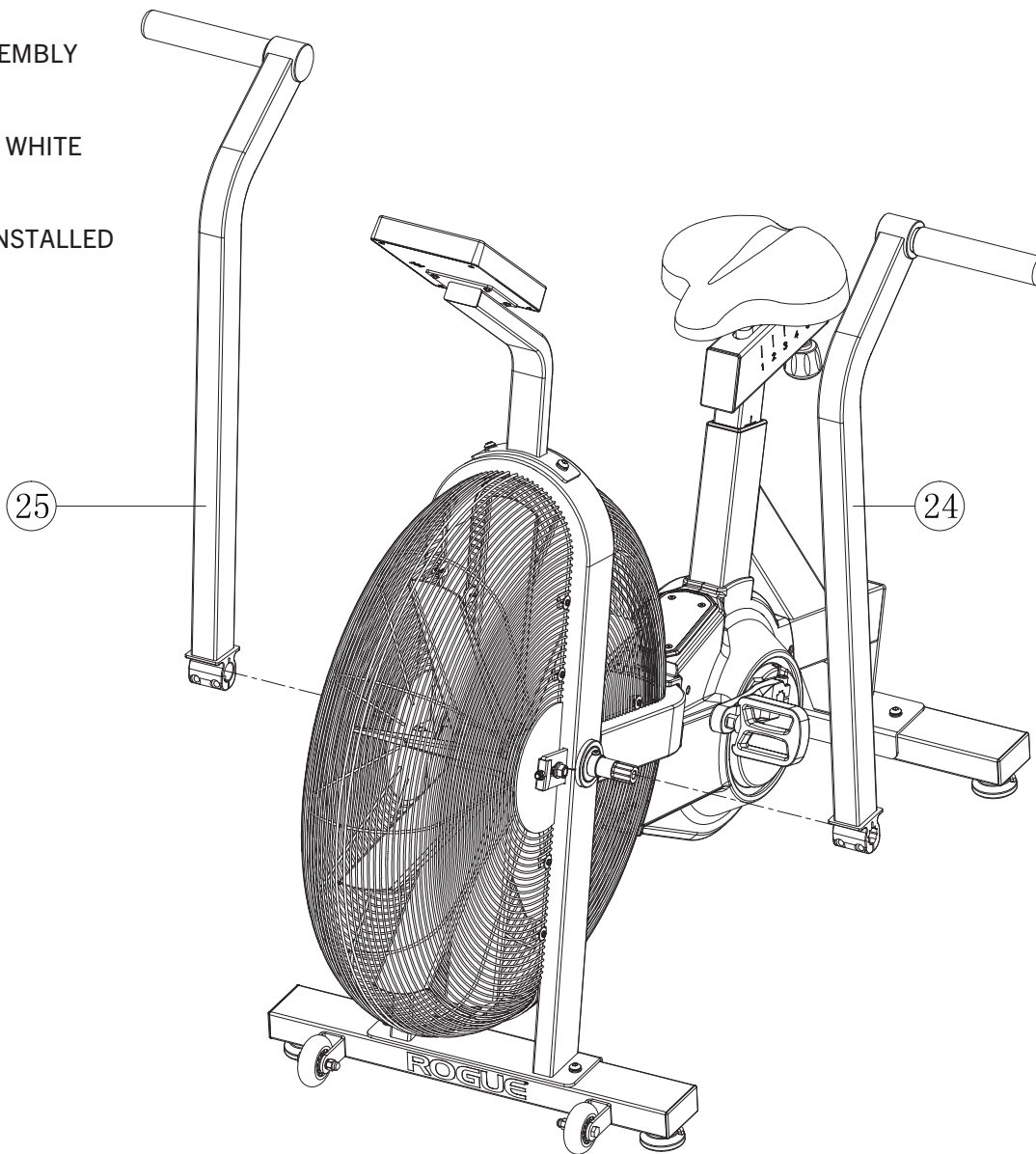

**STEP 7.1:**

ATTACH FOOT PEGS ASSEMBLIES (#28) TO THE MAIN FRAME. REMOVE FOOT PEG CAP (F) PRIOR TO INSTALLING FOOT PEGS.

**NOTE:**

IN THE NEXT STEP, ENSURE THE HANDLE ASSEMBLY SCREWS (#31) ARE INSTALLED FROM FRONT TO BACK. SEE DETAIL D.

**STEP 7.2:**

TIGHTEN LEFT HANDLE ASSEMBLY (#24) AND RIGHT HANDLE ASSEMBLY (#25) TO THE MAIN FRAME USING M8\*50mm SCREWS (#31), M8 SPRING WASHERS (#7), AND M8 FLANGE NUTS (#112).

**NOTE:**

IF PROPERLY TIGHTENED, THERE WILL NOT BE ANY PLAY IN THE HANDLES.

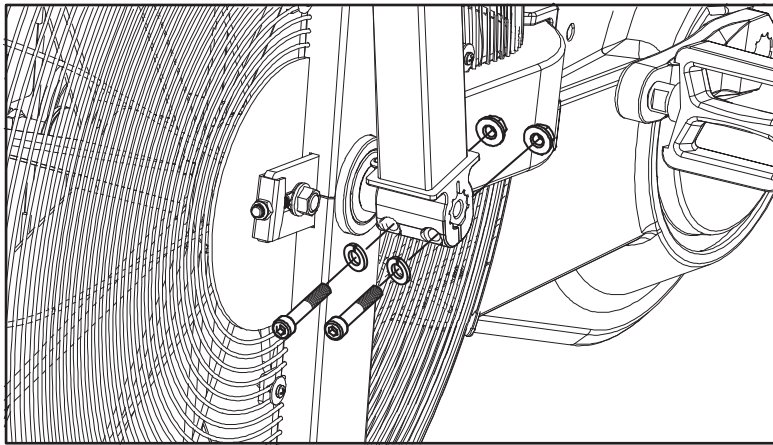

**DETAIL D**

