

ROGUE®

3 TIER MASS STORAGE SYSTEM

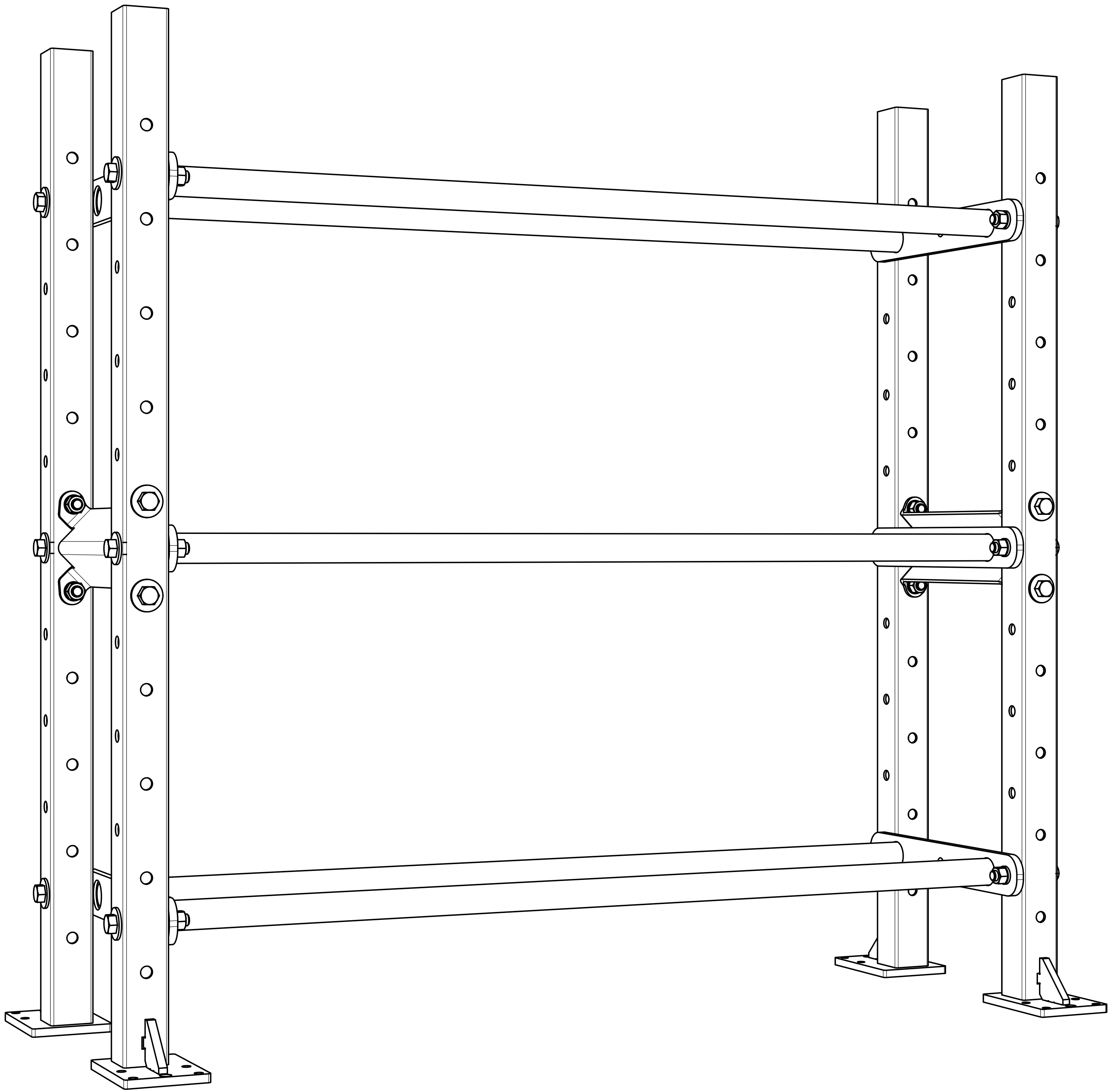

⚠ IMPORTANT SAFETY INFORMATION

DISCLAIMER:

Resistance training, gymnastics training, and activities at height are potentially dangerous and may lead to severe injury or even death. Use common sense when training, obtain instruction in the proper execution of movements, and understand your limitations. This equipment must only be used by competent and responsible persons. Obtaining instruction in appropriate techniques and methods of use is your own responsibility. You assume all risks and responsibilities for all damage, injury or death which may occur during or following incorrect use of this equipment in any matter whatsoever. Rogue Fitness bears no liability beyond the replacement value of the equipment in question.

WARNING:

MISUSE OF THIS PRODUCT CAN RESULT IN SEVERE INJURY. Both Rogue Fitness and buyer disclaim any express or implied warranty, including, without limitation, warranties or merchantability and/or fitness for a particular purpose with respect to the equipment. Buyer assumes all liability to use of equipment.

INCLUDED PARTS

Note: Images not shown at scale

1 Qty: **4x**

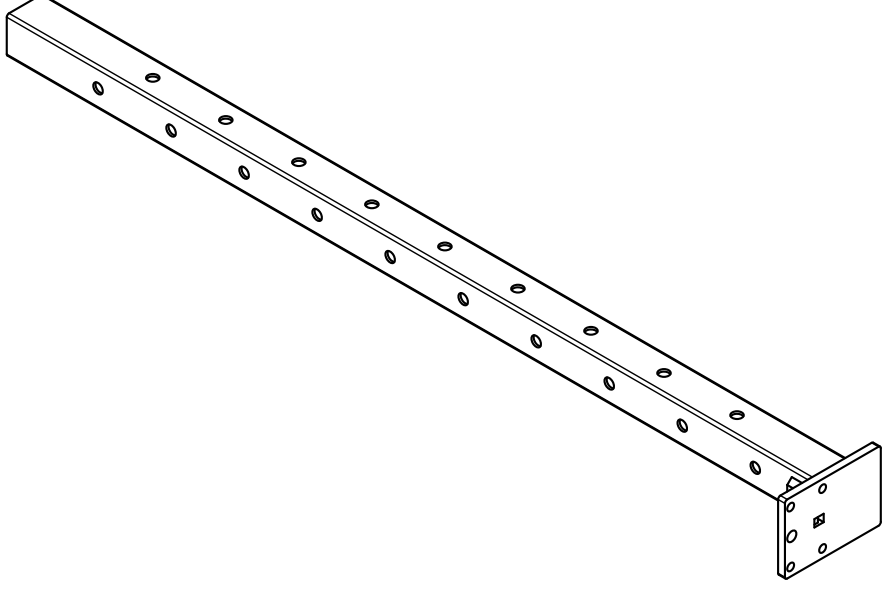

Upright

A long, narrow metal bar with a series of holes along its length and a flange at one end.

2 Qty: **3x**

*

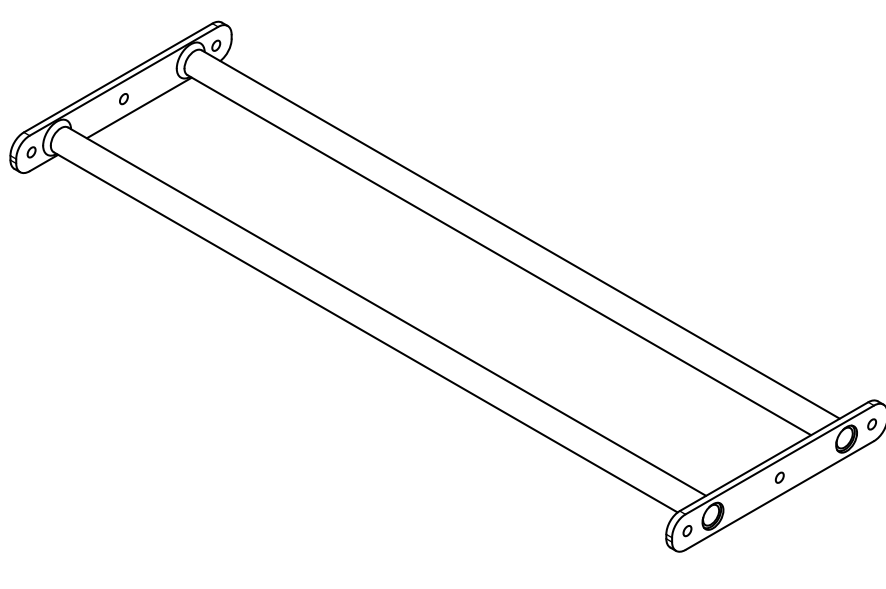

Crossmember

A metal bar with a flange at one end and a hole at the other, marked with an asterisk.

3 Qty: **2x**

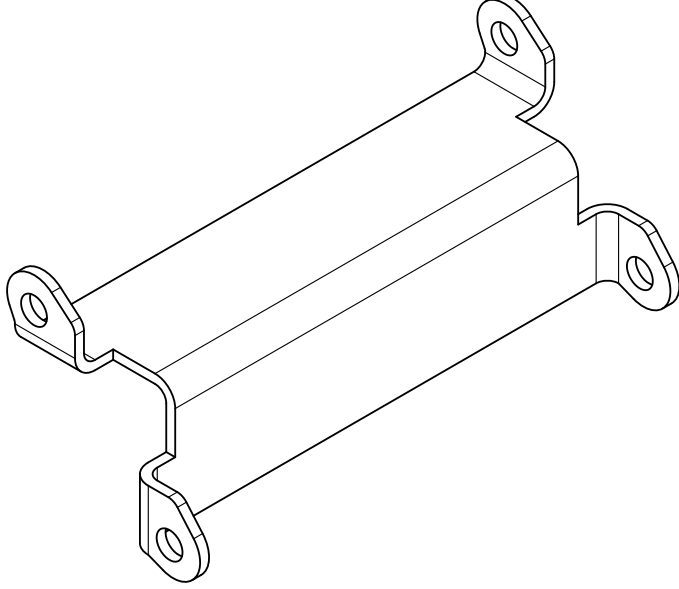

Bracket

A metal bracket with a central bar and four mounting points at the ends.

4 Qty: **20x**

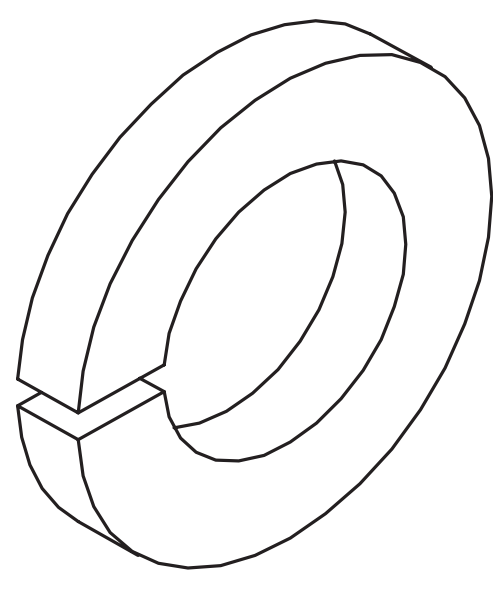

1/2" Lock Washer

A circular lock washer with a split design.

5 Qty: **20x**



1/2" Hex Nut

A standard hexagonal nut.

6 Qty: **20x**

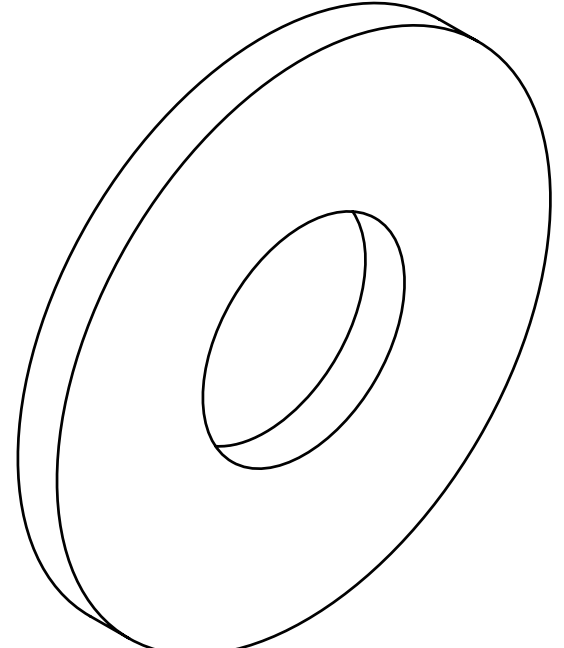

1/2" Flat Washer

A standard flat washer.

7 Qty: **8x**

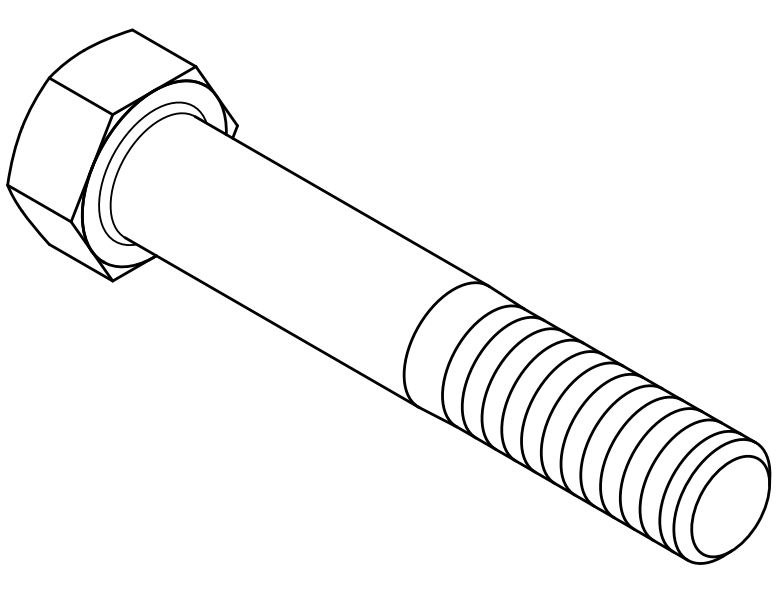

1/2" x 3" Hex Bolt

A hex bolt with a threaded section of approximately 3 inches.

8 Qty: **12x**

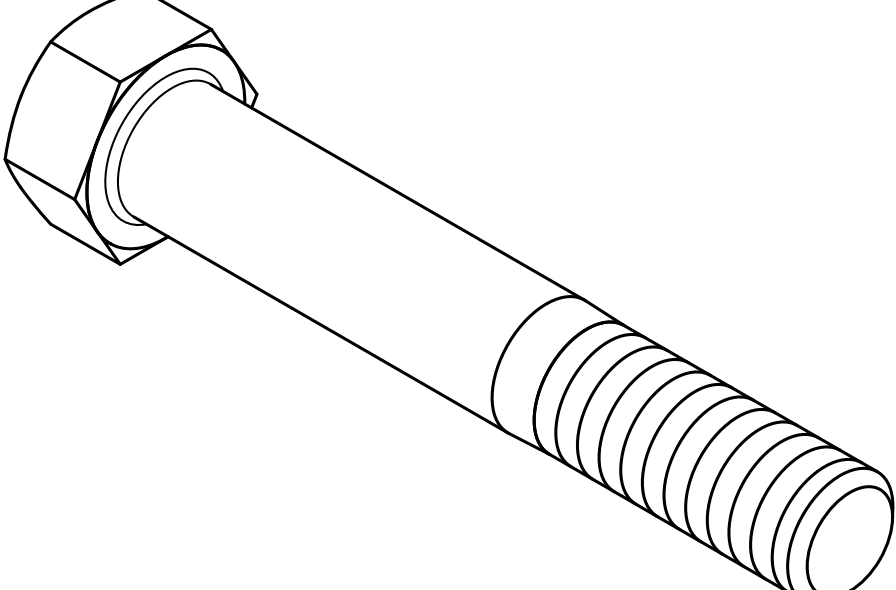

1/2" x 3-1/2" Hex Bolt

A hex bolt with a threaded section of approximately 3.5 inches.

* 43" or 70" Crossmember selected at checkout. Crossmember version (Bumper/Medball, Kettlebell, Dumbbell) selected at checkout.

STEP 1

- Bolt the Bracket [3] between the Uprights [1] using 1/2" x 3" Hex Bolts [7], 1/2" Flat Washers [6], 1/2" Lock Washers [4], and 1/2" Hex Nuts [5].
- The Brackets [3] should be pointing outward.
- Ensure the feet on Uprights [1] are pointing out as shown below.

- Do not fully tighten hardware until the entire rack is assembled. This will ensure your rack sits level to the floor.
- Do not bolt rack to the floor until it is fully assembled and all hardware is tightened.

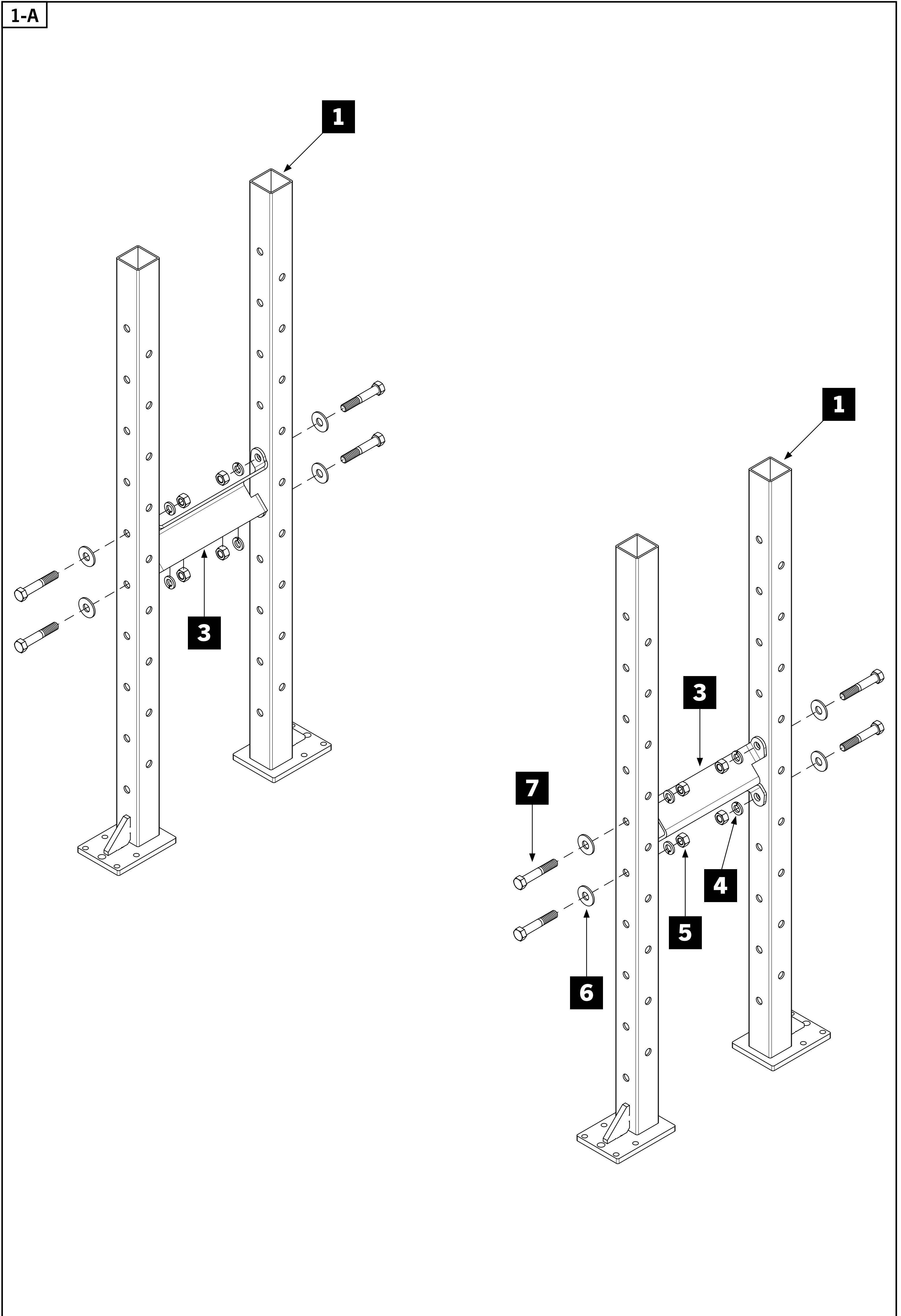

STEP 1

- Attach Crossmembers [2] to Uprights [1] using 1/2" x 3-1/2" Hex Bolts [8], 1/2" Flat Washers [6], 1/2" Lock Washers [4], and 1/2" Hex Nuts [5].

- Note: Crossmembers [2] can be placed at various positions. It is highly recommended heavier items are stored at lower levels. Bumper Plates should not be placed on top levels.

- **FULLY TIGHTEN ALL HARDWARE.**

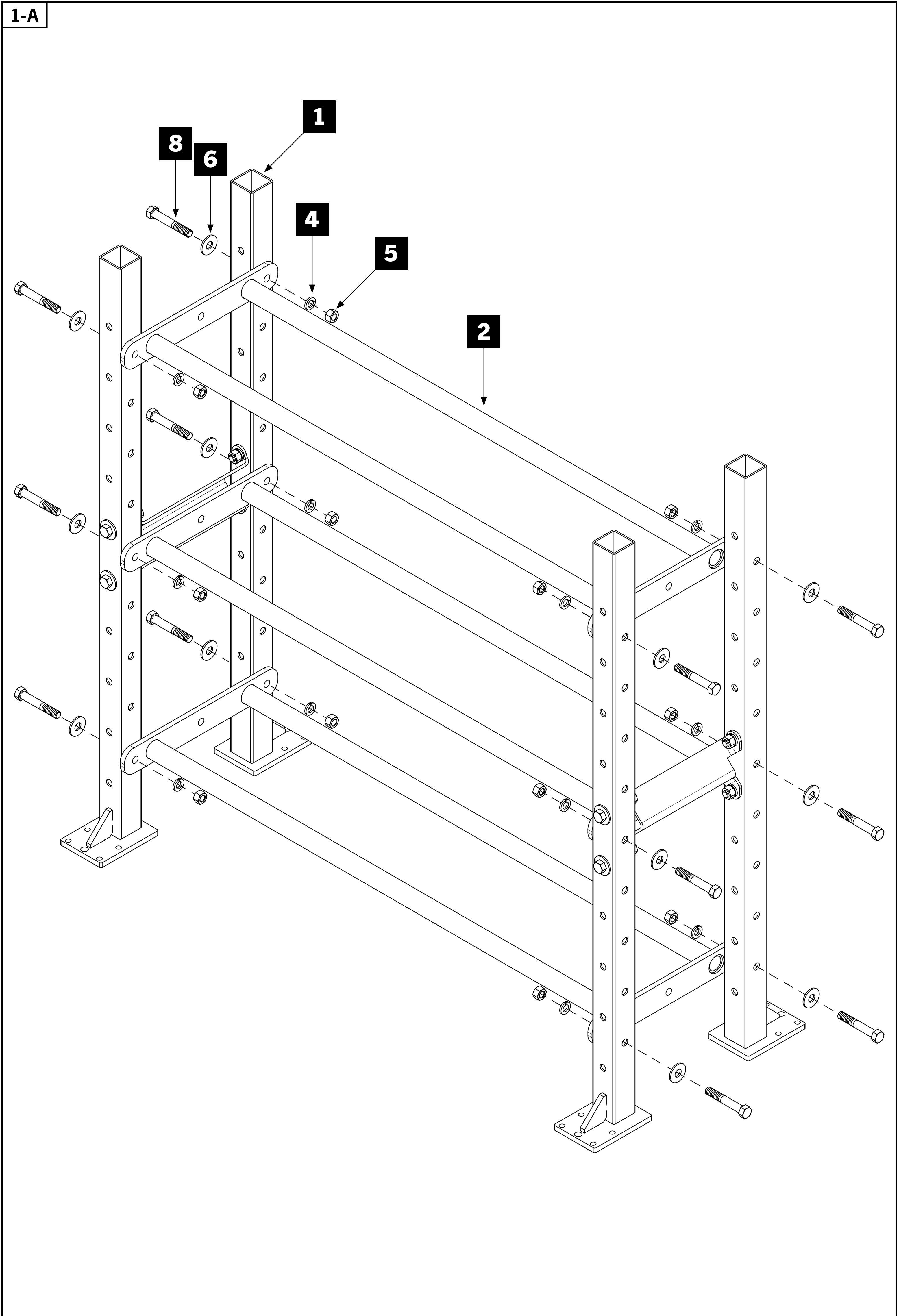

ROGUE



**SCAN FOR
INSTRUCTIONS**



**IRON GAME
PROGRAMMING**