

# ROGUE®

# 3 TIER UNIVERSAL STORAGE 2.0

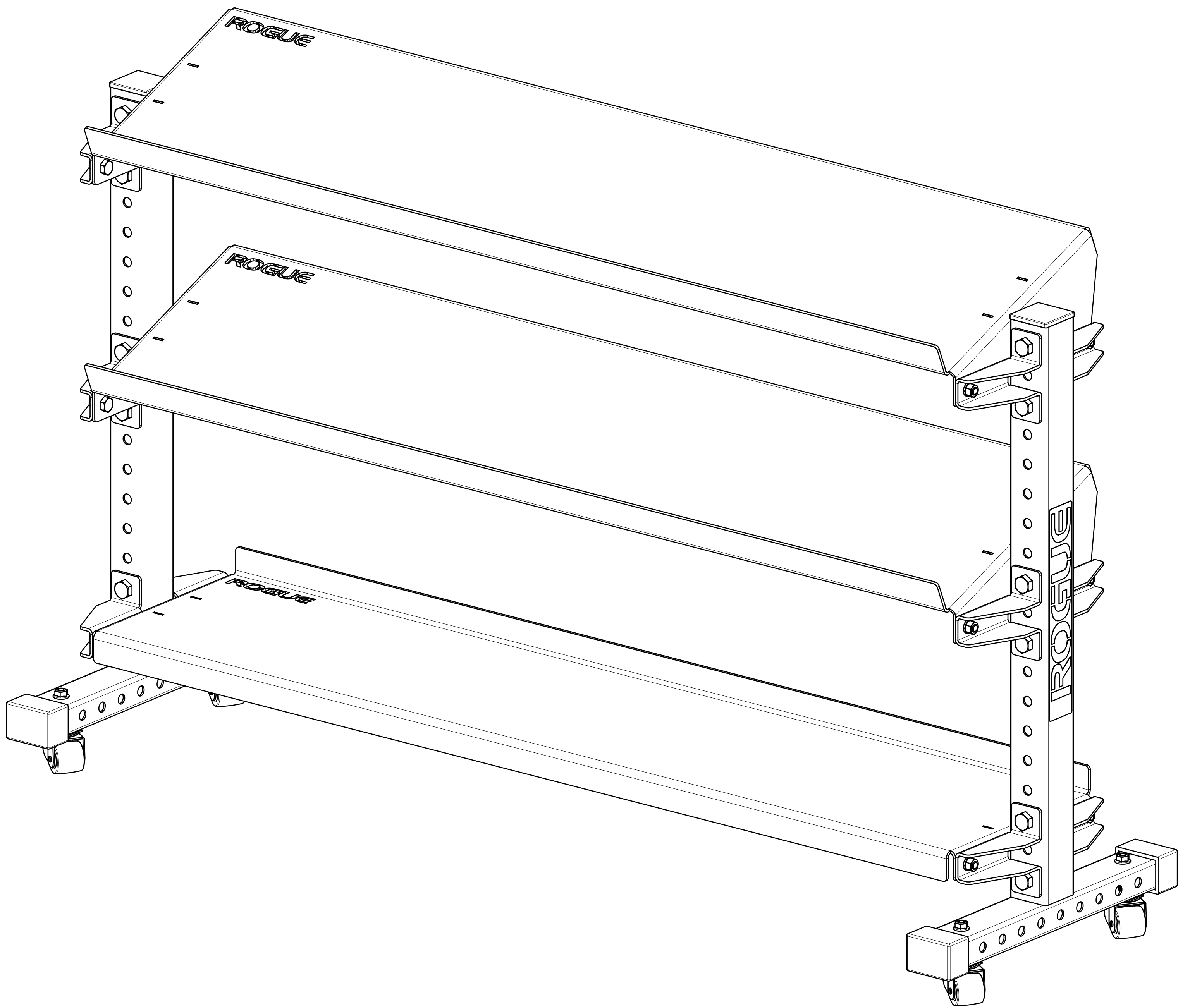

## **⚠ IMPORTANT SAFETY INFORMATION**

### **DISCLAIMER:**

Resistance training, gymnastics training, and activities at height are potentially dangerous and may lead to severe injury or even death. Use common sense when training, obtain instruction in the proper execution of movements, and understand your limitations. This equipment must only be used by competent and responsible persons. Obtaining instruction in appropriate techniques and methods of use is your own responsibility. You assume all risks and responsibilities for all damage, injury or death which may occur during or following incorrect use of this equipment in any matter whatsoever. Rogue Fitness bears no liability beyond the replacement value of the equipment in question.

### **WARNING:**

**MISUSE OF THIS PRODUCT CAN RESULT IN SEVERE INJURY.** Both Rogue Fitness and buyer disclaim any express or implied warranty, including, without limitation, warranties or merchantability and/or fitness for a particular purpose with respect to the equipment. Buyer assumes all liability to use of equipment.

# INCLUDED PARTS

Note: Images not shown at scale

**1** Qty: **2x**

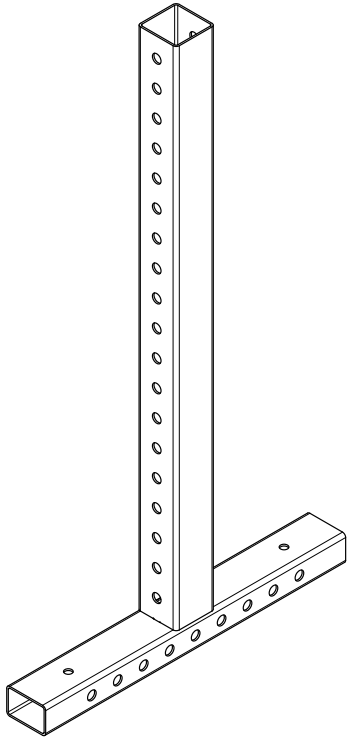

3 Tier Side

**2** Qty: **12x**

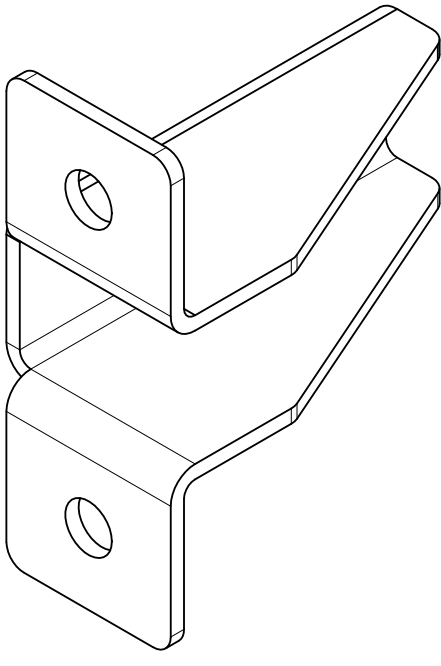

Shelf Bracket

**3** Qty: **Up to 3x**

\*



70" Dumbbell Shelf

**4** Qty: **Up to 3x**

\*



70" Kettlebell Shelf

**5** Qty: **4x**

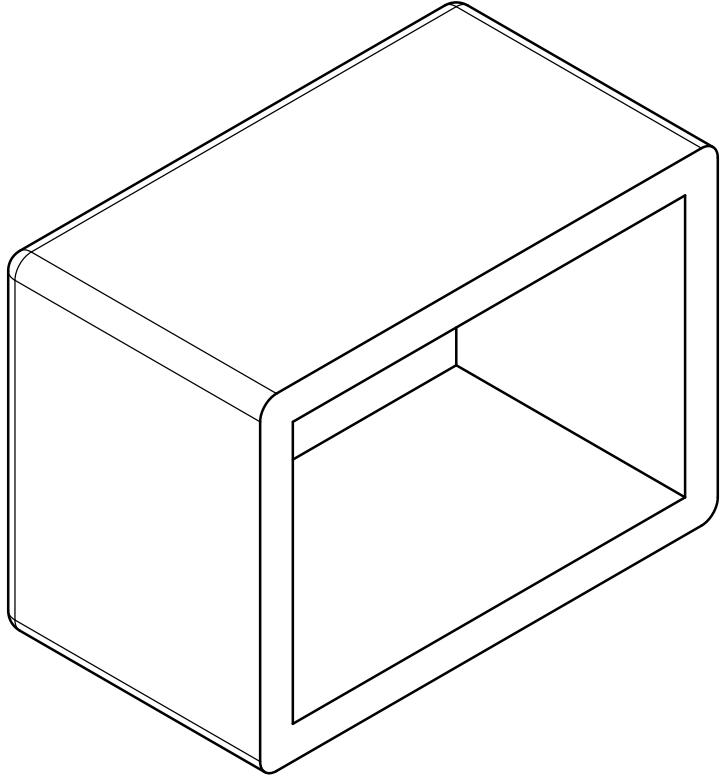

2" x 3" Rubber Cap

**6** Qty: **2x**

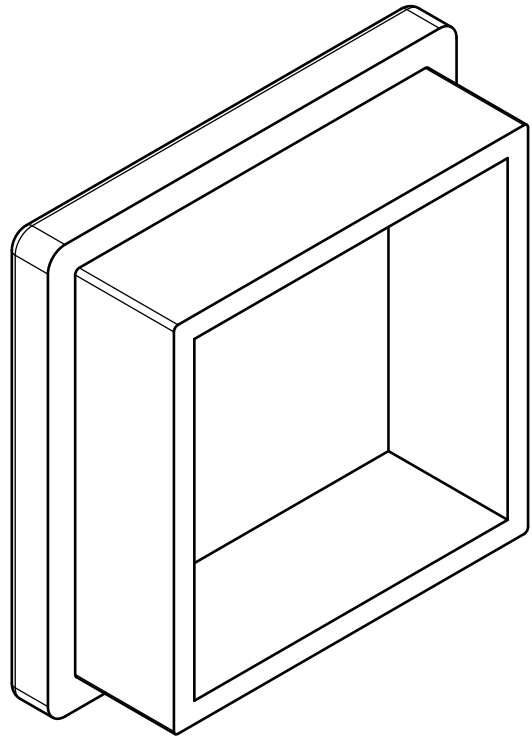

3" x 3" Cap

**7** Qty: **4x**

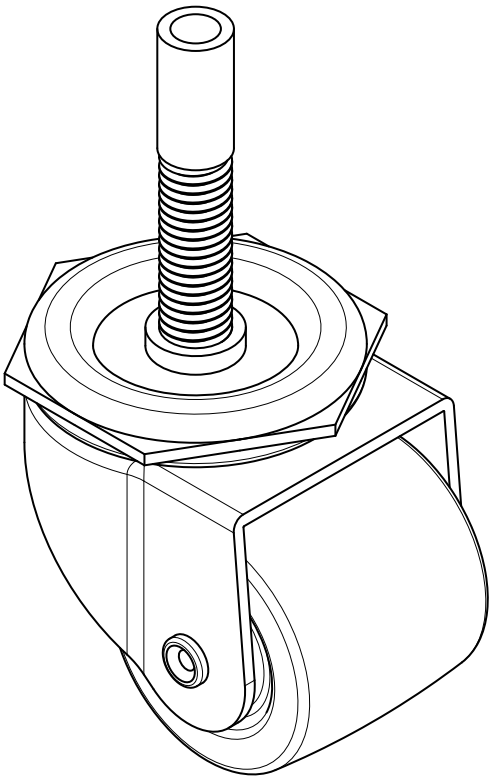

Stem Caster

**8** Qty: **4x**

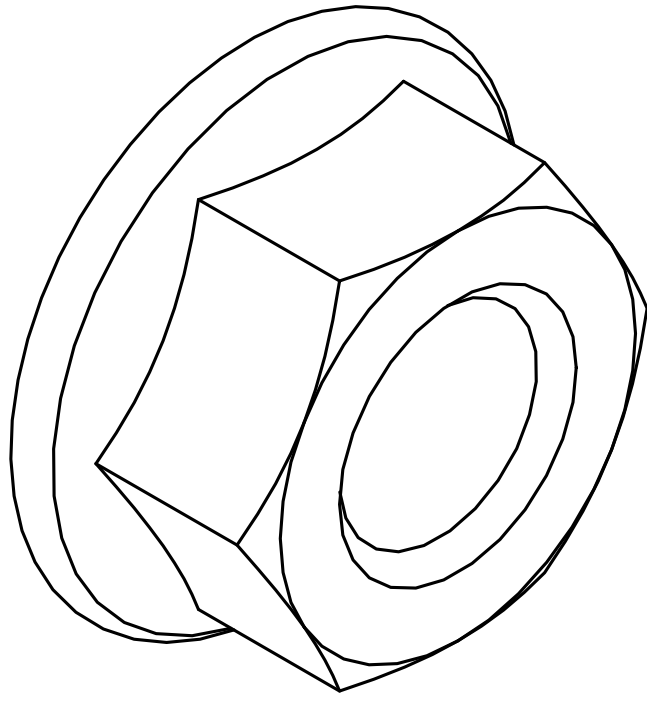

1/2" Serrated Flange Nut

**9** Qty: **12x**

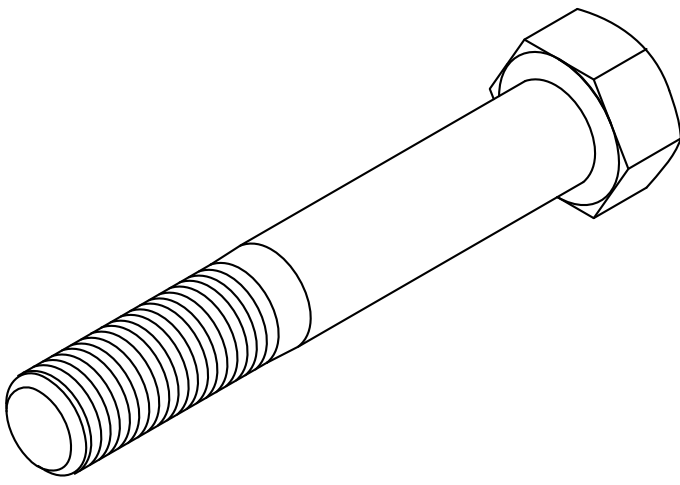

5/8" x 4.25" Hex Bolt

**10** Qty: **12x**

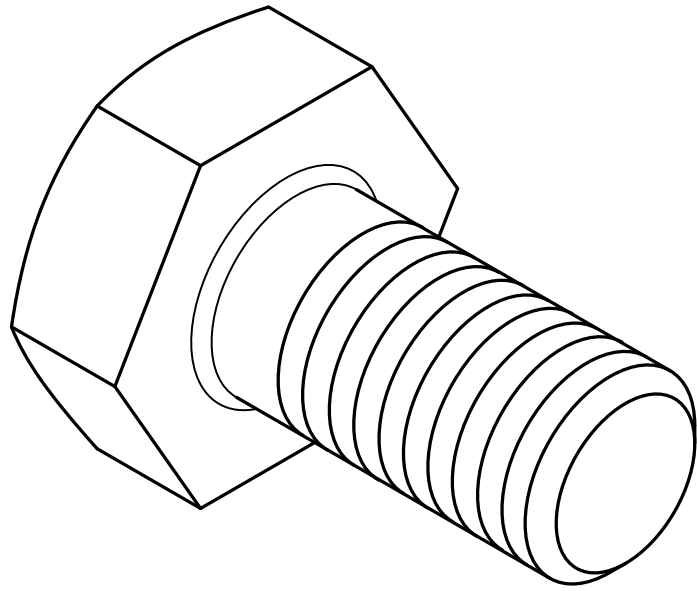

1/2" x 1.25" Hex Bolt

**11** Qty: **12x**

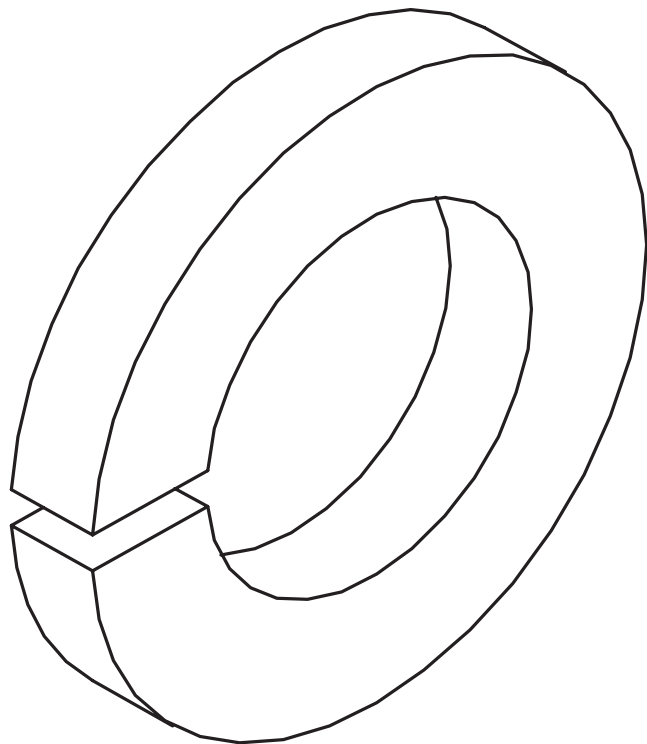

5/8" Lock Washer

**12** Qty: **12x**

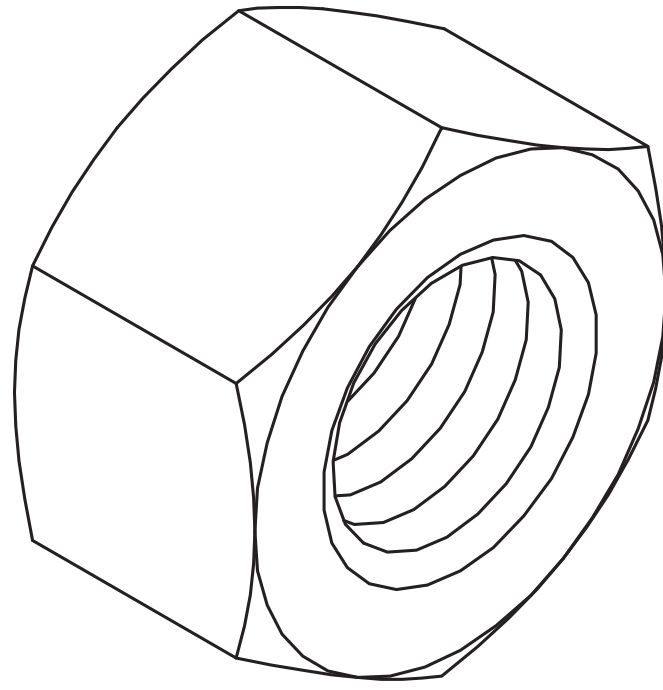

5/8" Hex Nut

\* Quantity depends on selection made at checkout.

# INCLUDED PARTS

Note: Images not shown at scale

**13** Qty: **12x**

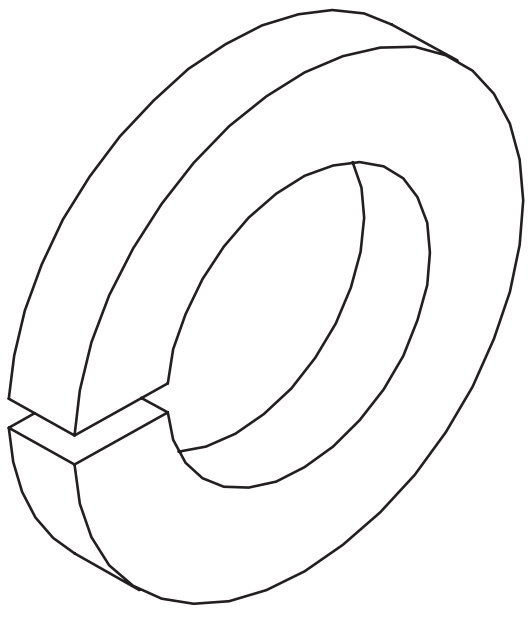

1/2" Lock Washer

**14** Qty: **12x**

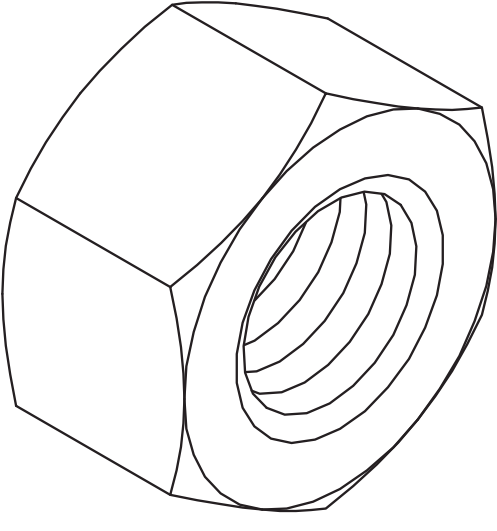

1/2" Hex Nut

**15** Qty: **Up to 3x**

\*

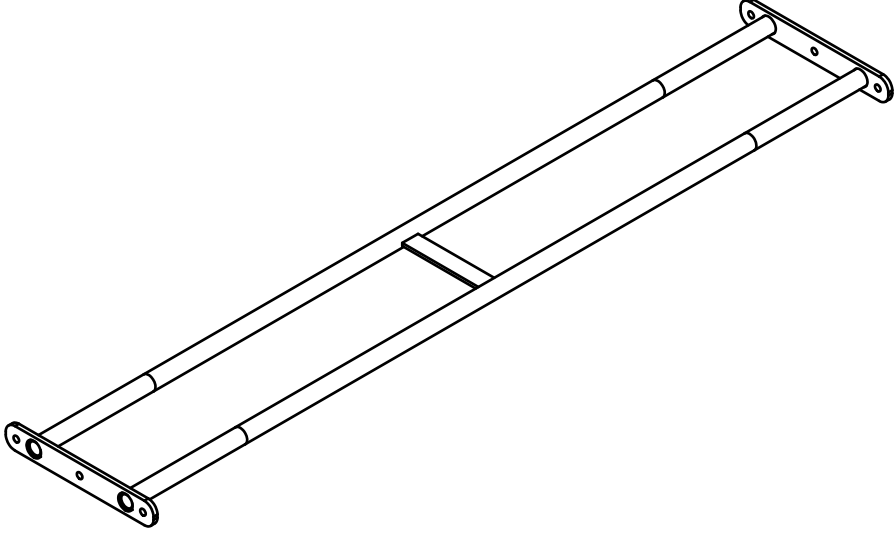

70" Medball Shelf

\* Quantity depends on selection made at checkout.

# STEP 1

- Begin assembly by laying out the 3 Tier Side [1] and Shelf Brackets [2] as shown in **STEP 1-A**.
- Bolt the Shelf Brackets [2] to the 3 Tier Side [1] using 5/8" x 4.25" Hex Bolt [9], 5/8" Lock Washer [11], and 5/8" Hex Nut [12].
- **FULLY TIGHTEN HARDWARE BEFORE MOVING TO NEXT STEPS.**

- Brackets are designed to be bolted through upper and lower most holes of the vertical tube. The middle bracket should have 5 empty holes on either side.
- On the base of the 3 Tier Side [1] add the 2" x 3" Rubber Caps [5] to both sides as shown. Then add the 3" x 3" Cap [6] to the top of the 3 Tier Side [1].

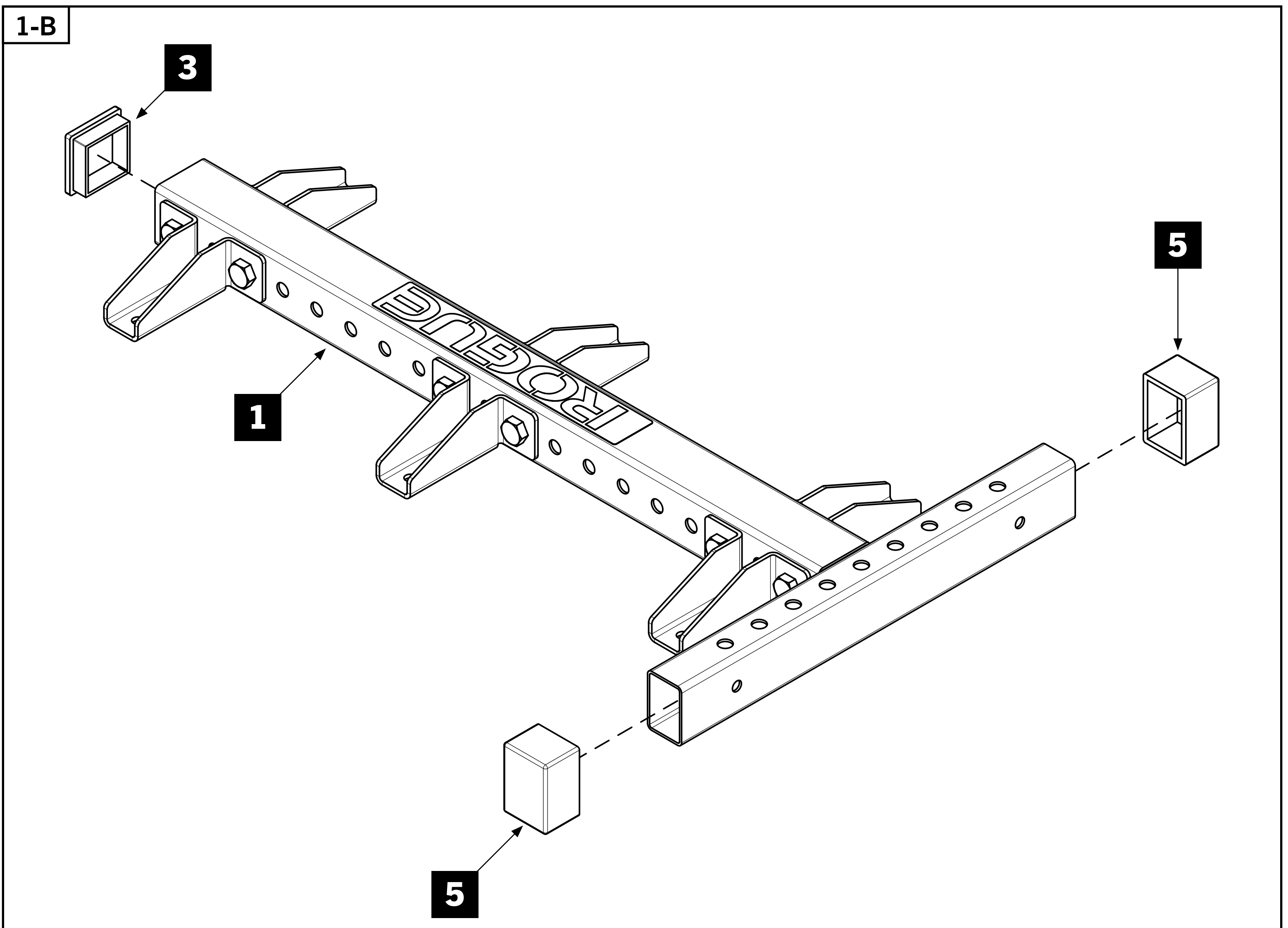
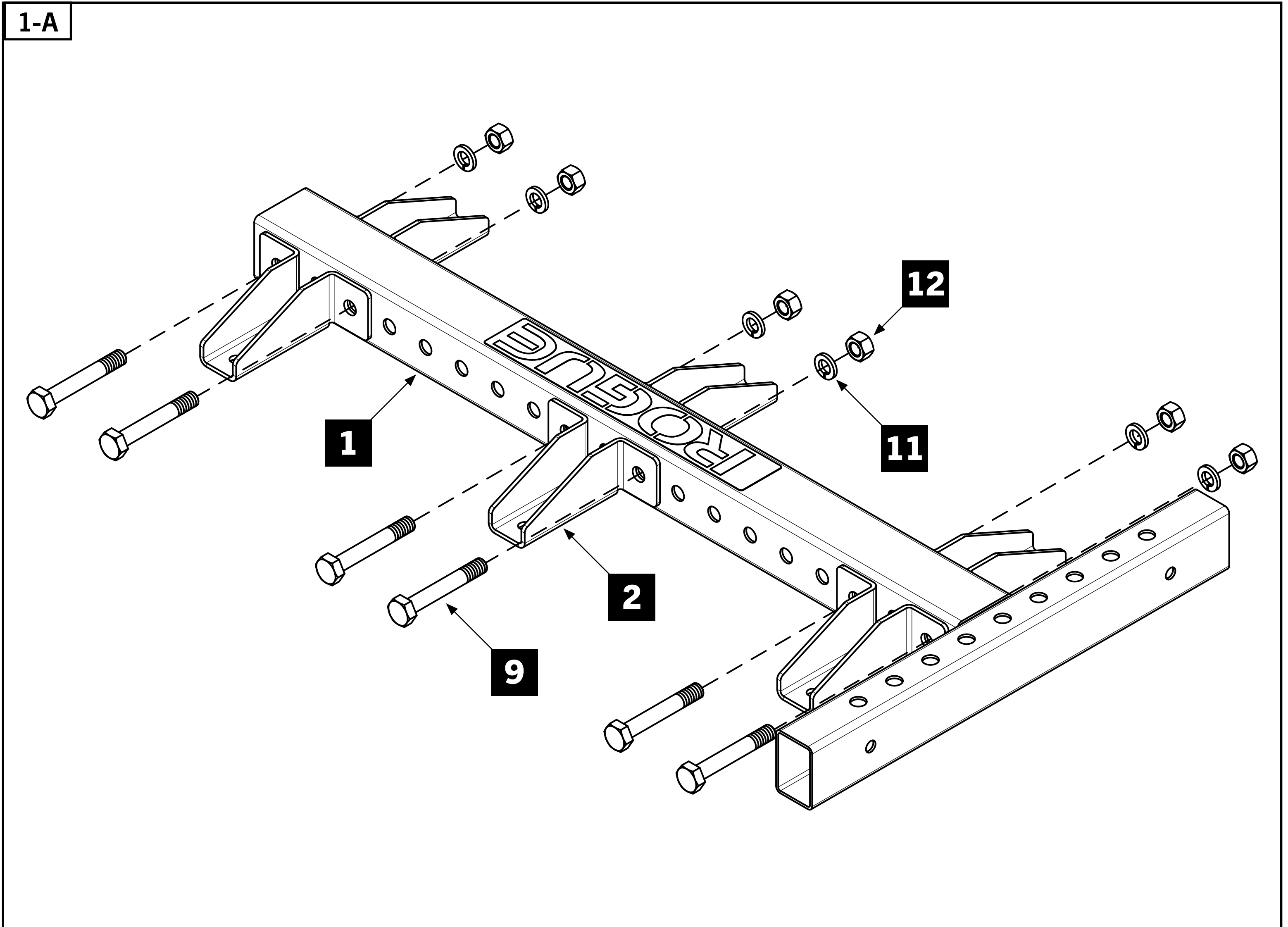

## STEP 2

- **THIS STEP IS BEST DONE WITH A PARTNER.**
- Start by standing up the 3 Tier Sides [1] approximately 70" from one another as shown in **STEP 2-A**.

- Working from bottom to top, bolt each shelf to the Shelf Brackets [2] using 1/2" x 1.25" Hex Bolt [10], 1/2" Lock Washer [13], and 1/2" Hex Nut [14].
- **HAND TIGHTEN SHELF HARDWARE.**

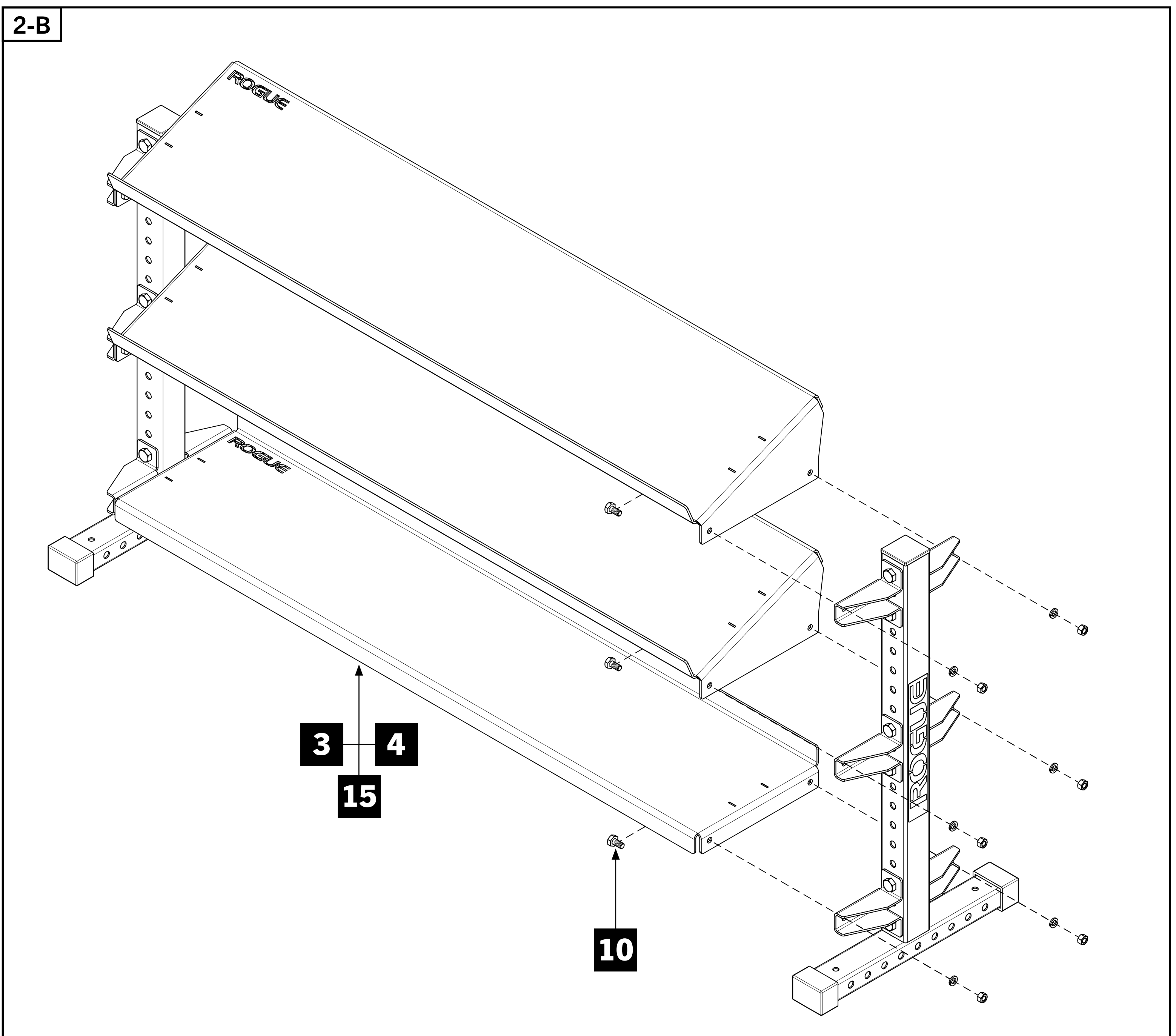
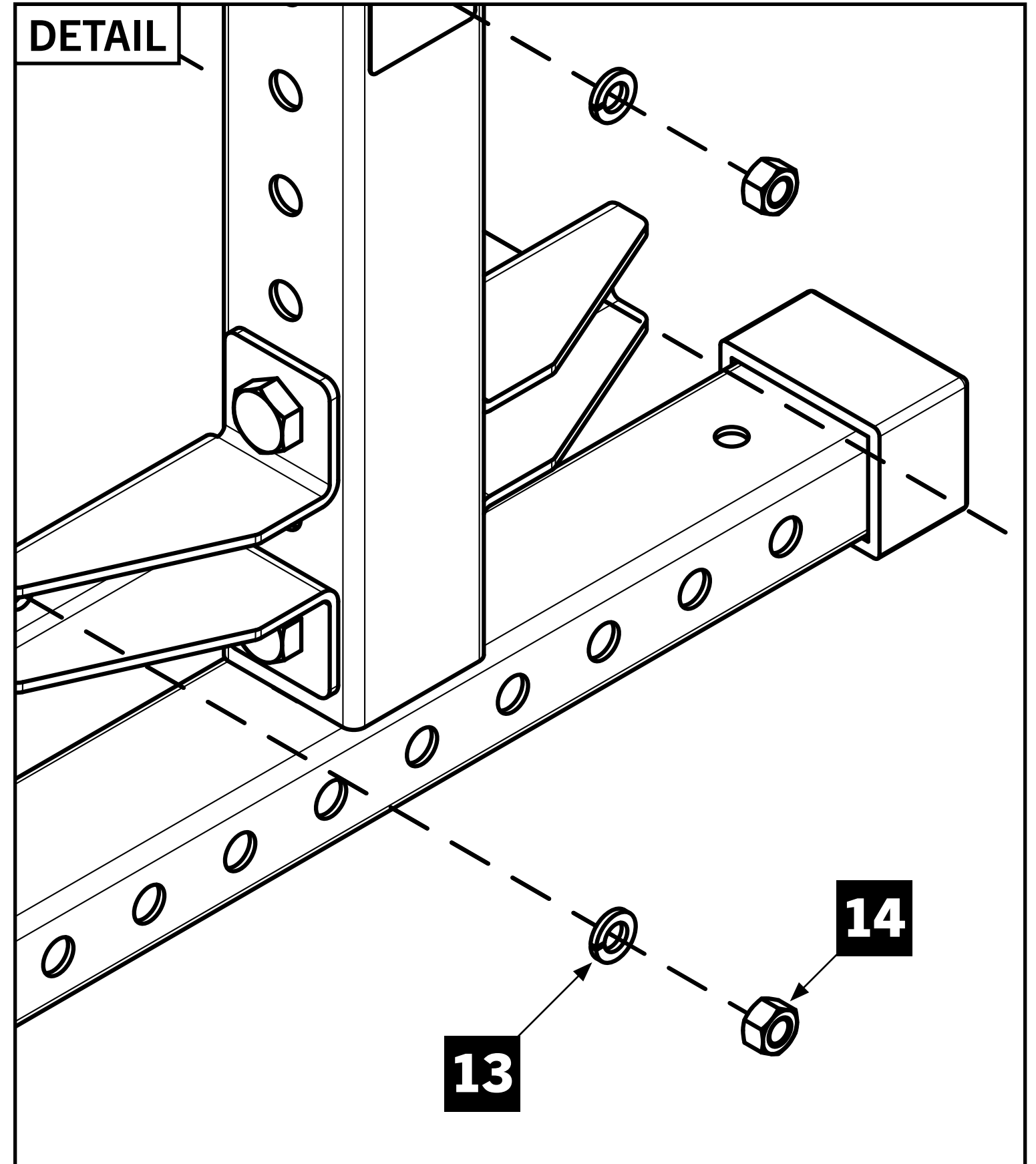
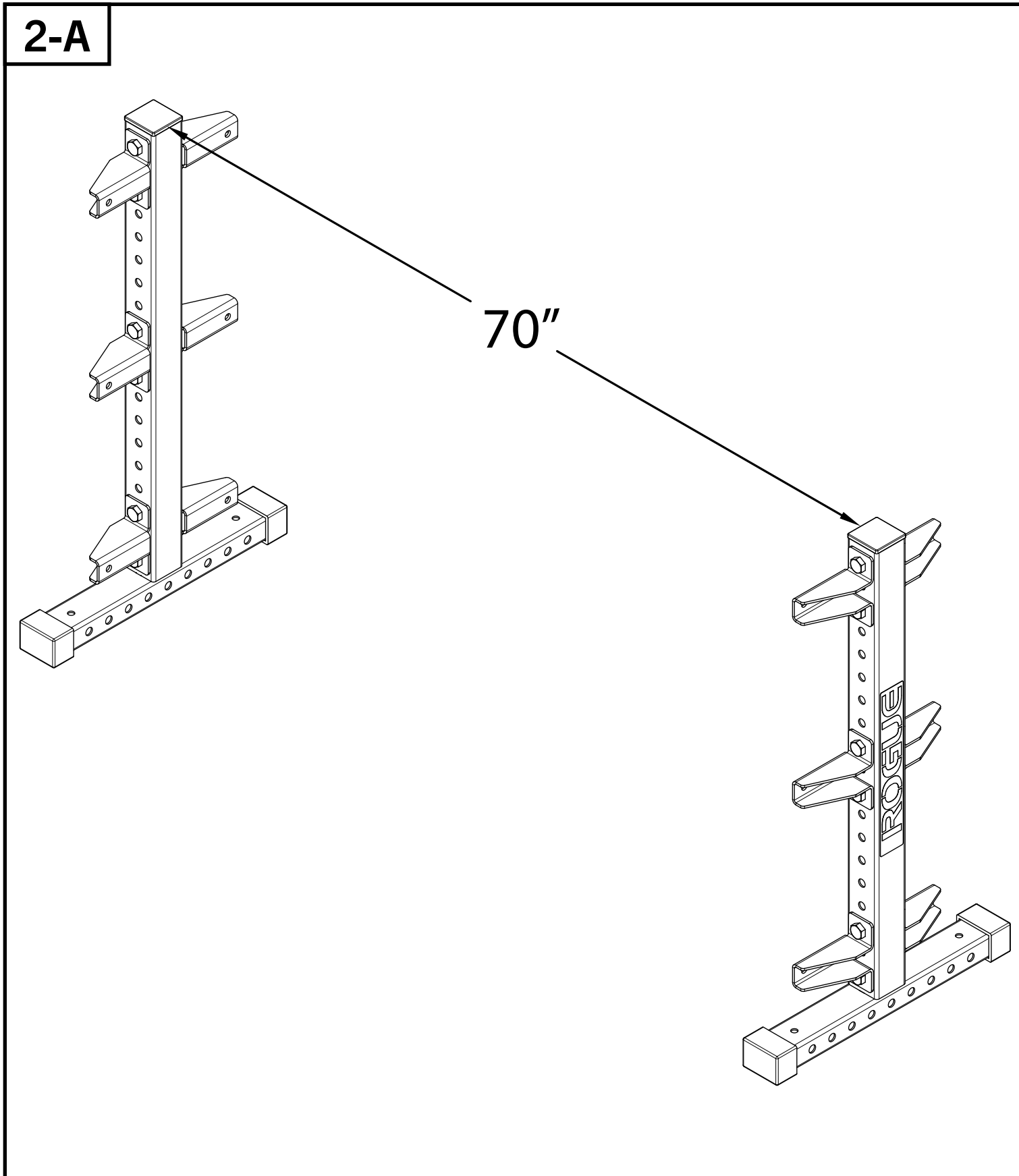

# STEP 3

• **THIS STEP IS BEST DONE WITH A PARTNER.**

• Start by tilting the storage unit onto the back side.

• Insert the Stem Caster [7] through the bottom of the base using 1/2" Flange Nut [8].

• Carefully tilt the storage unit onto the casters.

• **FULLY TIGHTEN ALL SHELF HARDWARE.**

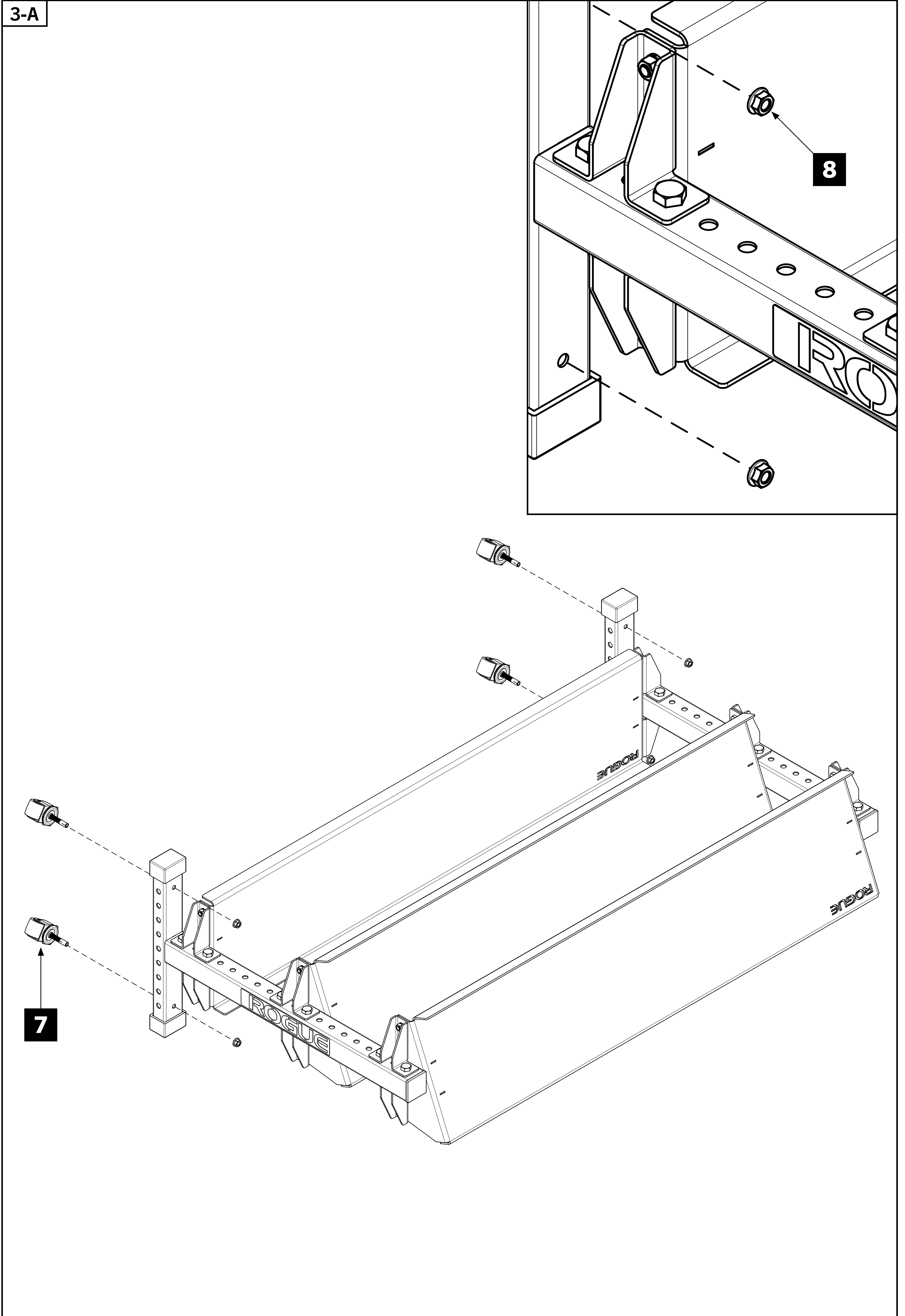

**ROGUE**



**SCAN FOR  
INSTRUCTIONS**



**IRON GAME  
PROGRAMMING**