

ROGUE®

MONSTER KEYWAY PLATE STORAGE

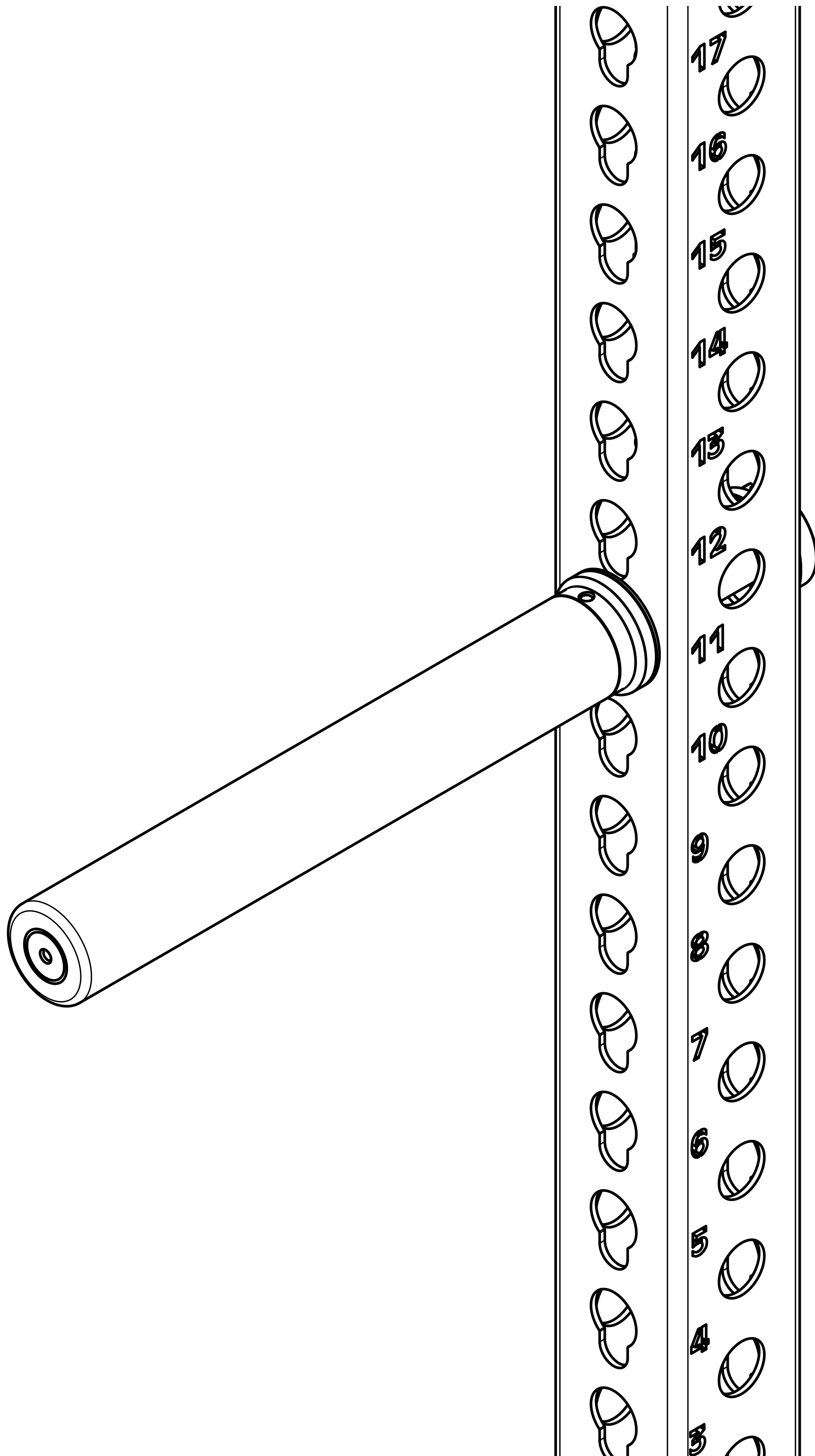

⚠ IMPORTANT SAFETY INFORMATION

DISCLAIMER:

Resistance training, gymnastics training, and activities at height are potentially dangerous and may lead to severe injury or even death. Use common sense when training, obtain instruction in the proper execution of movements, and understand your limitations. This equipment must only be used by competent and responsible persons. Obtaining instruction in appropriate techniques and methods of use is your own responsibility. You assume all risks and responsibilities for all damage, injury or death which may occur during or following incorrect use of this equipment in any matter whatsoever. Rogue Fitness bears no liability beyond the replacement value of the equipment in question.

WARNING:

MISUSE OF THIS PRODUCT CAN RESULT IN SEVERE INJURY. Both Rogue Fitness and buyer disclaim any express or implied warranty, including, without limitation, warranties or merchantability and/or fitness for a particular purpose with respect to the equipment. Buyer assumes all liability to use of equipment.

INCLUDED PARTS

Note: Images not shown at scale

1 Qty: **1x**

*

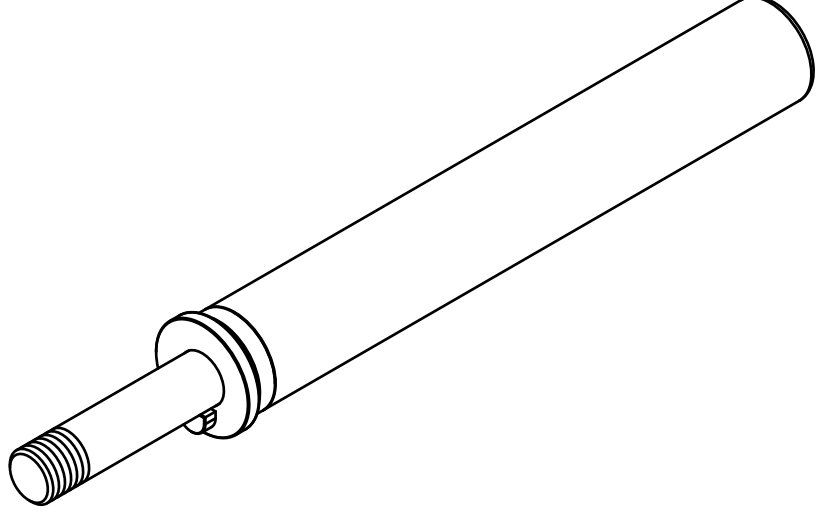
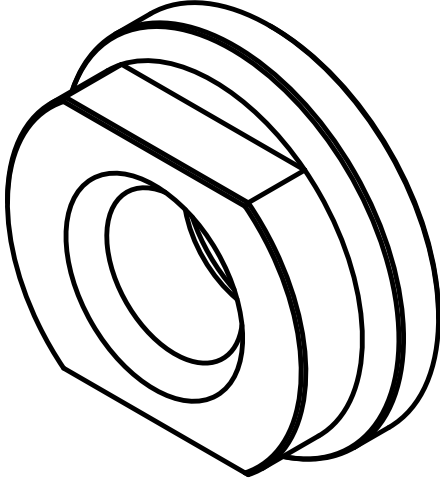

Plate Storage Assembly

A technical drawing of a plate storage assembly, showing a long cylindrical tube with a threaded end and a small circular component attached to the side.

2 Qty: **1x**



Threaded Nut

A technical drawing of a hexagonal threaded nut, showing its hexagonal shape and the internal threads.

3 Qty: **1x**

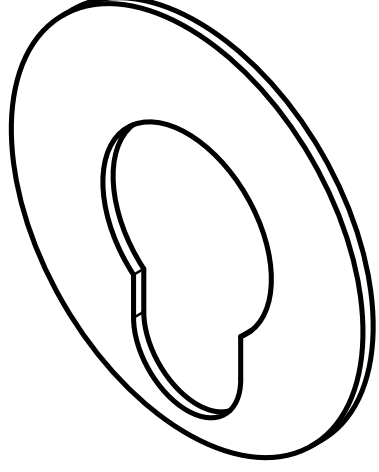

Key Washer

A technical drawing of a key washer, showing its circular shape and a central slot.

4 Qty: **1x**

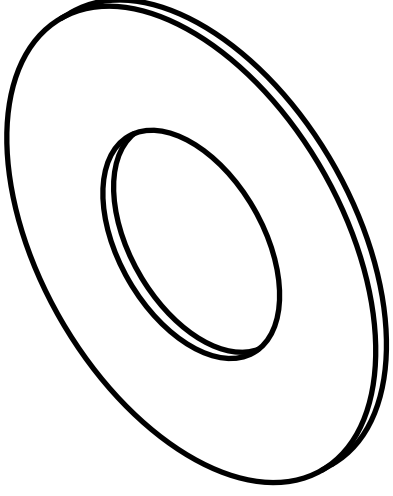

Flat Washer

A technical drawing of a flat washer, showing its circular shape and a central hole.

* 6.75" or 12.75" Plate Storage Assembly chosen at checkout.

STEP 1

- Place Key Washer [3] over the Key Nut on the Plate Storage Assembly [1].
- Insert Plate Storage Assembly [1] into desired height hole in upright.
- Place Flat Washer [4] over the Plate Storage Assembly [1].
- Screw on Threaded Nut [2] hand tighten only.
- Ensure Key Washer [3] is in proper position in regards to key nut.
- Tighten Threaded Nut [2].
- Be sure to have Threaded Nut [2] tight prior to adding weight to storage post.

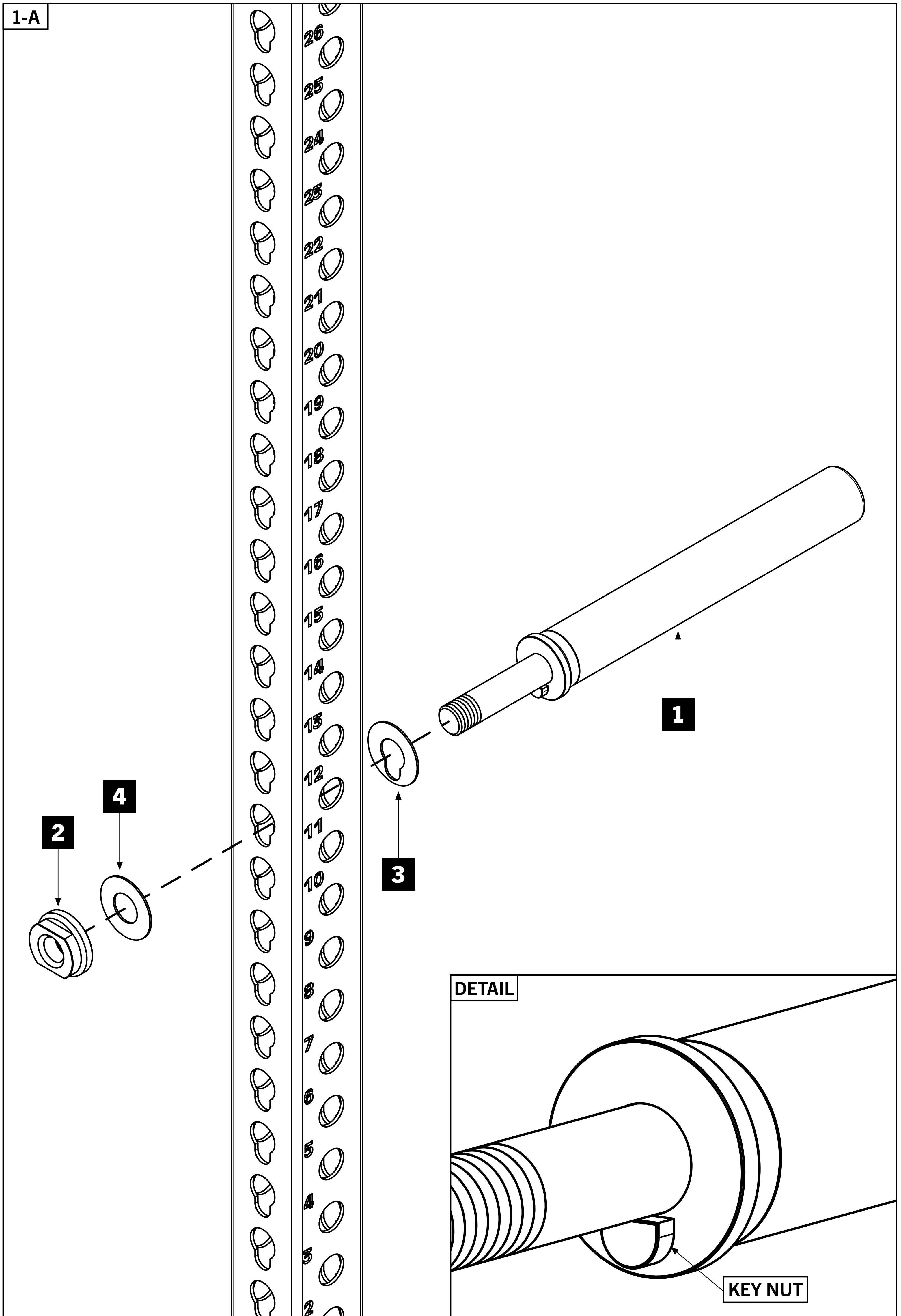

ROGUE



**SCAN FOR
INSTRUCTIONS**



**IRON GAME
PROGRAMMING**