

# ROGUE

## RML-90SLIM RACK (BRACKETS)

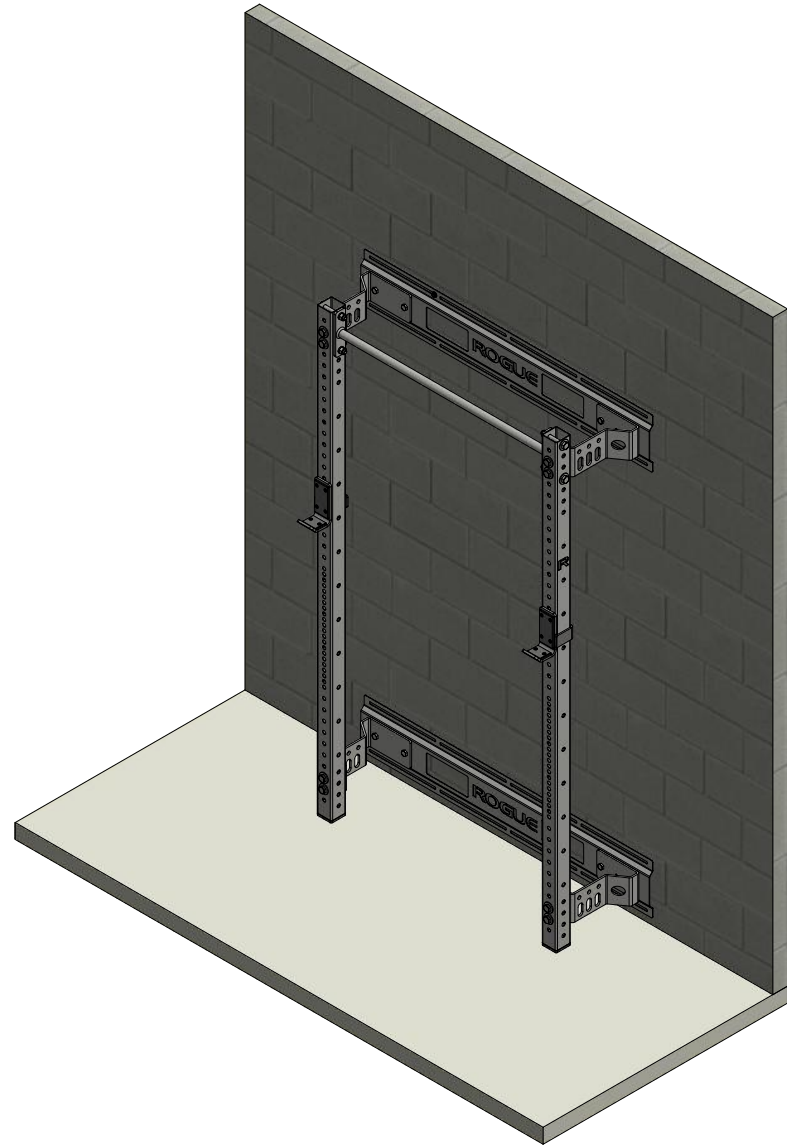

## DISCLAIMER

Resistance training, gymnastics training, and activities at height are potentially dangerous and may lead to severe injury or even death. Use common sense when training, to obtain instruction in the proper execution of movements, and understand your limitations. This equipment must only be used by competent and responsible persons, or under the direct and visual control of a competent and responsible person. Obtaining instruction in appropriate techniques and methods of use is your own responsibility. You assume all risks and responsibilities for all damage, injury or death which may occur during or following incorrect use of this equipment in any matter whatsoever. Rogue Fitness bears no liability beyond the replacement value of the equipment in question.



## WARNING!



MISUSE OF THIS CAN RESULT IN  
SEVERE INJURY

BOTH ROGUE FITNESS AND BUYER DISCLAIM ANY EXPRESS OR IMPLIED WARRANTY, INCLUDING, WITHOUT LIMITATION, WARRANTIES OR MERCHANTABILITY AND/OR FITNESS FOR A PARTICULAR PURPOSE WITH RESPECT TO THE EQUIPMENT. BUYER ASSUMES ALL LIABILITY IN USE OF EQUIPMENT.

**Rogue Fitness**  
545 E 5th Ave.  
Columbus, Ohio 43201  
614-358-6190  
team@roguefitness.com

# ROGUE

## RML-90SLIM RACK (BRACKETS)

PARTS LIST		
ITEM	QTY	DESCRIPTION
1	2	Monster Lite 90" Stick
2	2	Left Wall Mount Bracket - RML-90SLIM
3	2	Right Wall Mount Bracket - RML-90SLIM
4	2	UHMW 3x3 Foot
5	8	5/8" x 4.25" Hex Bolt
6	8 + 4	5/8" Flat Washer + (Pull Up Bar Add-on)
7	8 + 4	5/8" Lock Washer + (Pull Up Bar Add-on)
8	8 + 4	5/8" Hex Nut + (Pull Up Bar Add-on)
9	8	3/8" x 2-1/2" Lag Screw
10	8	3/8" Flat Washer
11	1	Monster Lite J-Cup Pair
12	1	X-431 - 43" Single Pull Up Bar (Add-on)
13	4	5/8" x 4.5" Hex Bolt (Add-on)

**\*\*ATTENTION\*\***

IF USING THIS PRODUCT WITH THE "ROGUE STRINGER PAIR", REFERENCE THE STRINGER INSTRUCTIONS FOR MOUNTING HEIGHTS AND LOCATIONS.

### DISCLAIMER

Resistance training, gymnastics training, and activities at height are potentially dangerous and may lead to severe injury or even death. Use common sense when training, to obtain instruction in the proper execution of movements, and understand your limitations. This equipment must only be used by competent and responsible persons, or under the direct and visual control of a competent and responsible person. Obtaining instruction in appropriate techniques and methods of use is your own responsibility. You assume all risks and responsibilities for all damage, injury or death which may occur during or following incorrect use of this equipment in any matter whatsoever. Rogue Fitness bears no liability beyond the replacement value of the equipment in question.

INCLUDED PARTS  
 \*NOTE: IMAGES NOT SHOWN TO SCALE

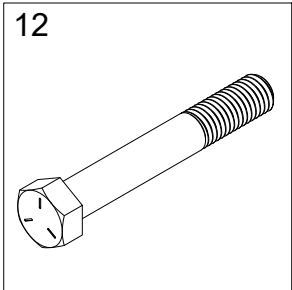
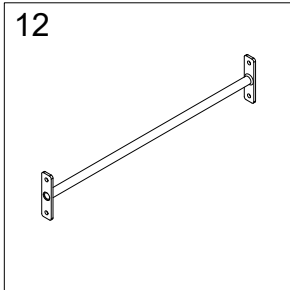
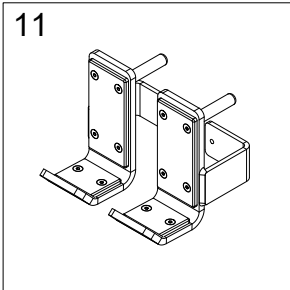
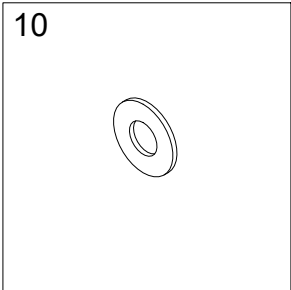
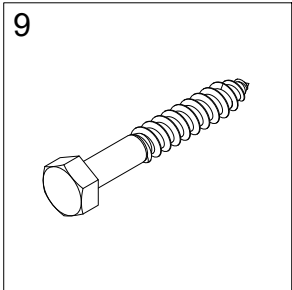
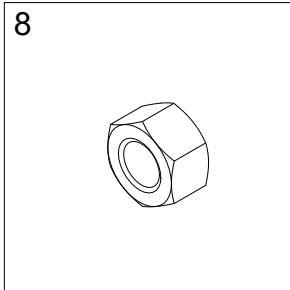
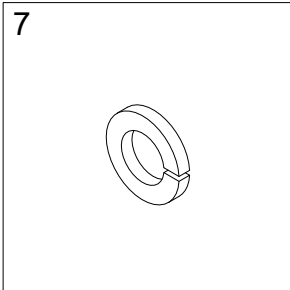
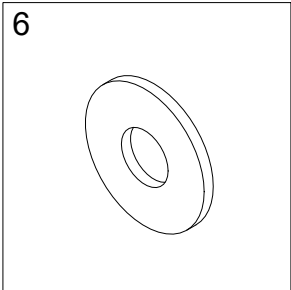
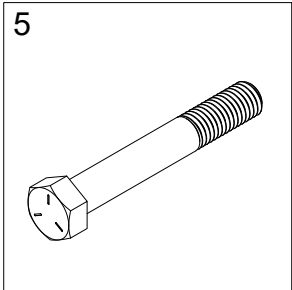
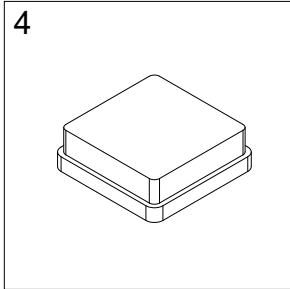
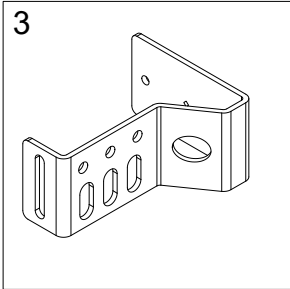
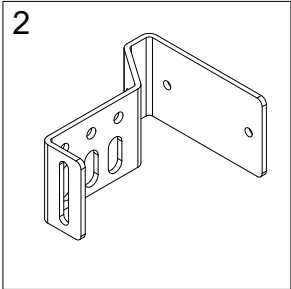
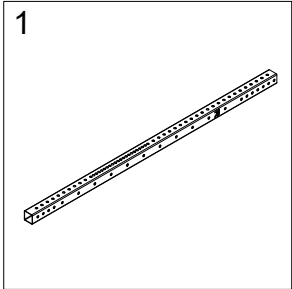

### WARNING!

MISUSE OF THIS CAN RESULT IN SEVERE INJURY

BOTH ROGUE FITNESS AND BUYER DISCLAIM ANY EXPRESS OR IMPLIED WARRANTY, INCLUDING, WITHOUT LIMITATION, WARRANTIES OR MERCHANTABILITY AND/OR FITNESS FOR A PARTICULAR PURPOSE WITH RESPECT TO THE EQUIPMENT. BUYER ASSUMES ALL LIABILITY IN USE OF EQUIPMENT.

**Rogue Fitness**  
 545 E 5th Ave.  
 Columbus, Ohio 43201  
 614-358-6190  
 team@roguefitness.com

# ROGUE

## RML-90SLIM RACK (BRACKETS)

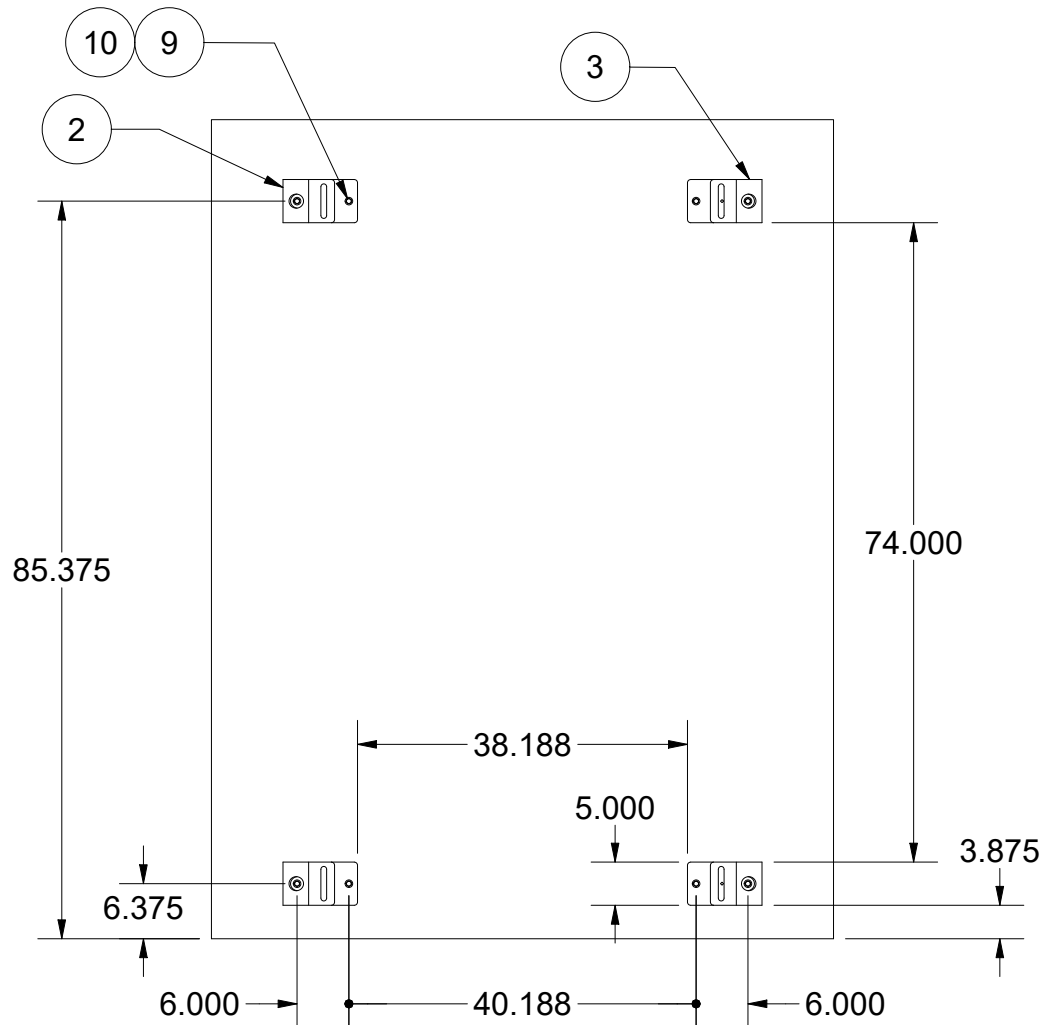

## DISCLAIMER

Resistance training, gymnastics training, and activities at height are potentially dangerous and may lead to severe injury or even death. Use common sense when training, to obtain instruction in the proper execution of movements, and understand your limitations. This equipment must only be used by competent and responsible persons, or under the direct and visual control of a competent and responsible person. Obtaining instruction in appropriate techniques and methods of use is your own responsibility. You assume all risks and responsibilities for all damage, injury or death which may occur during or following incorrect use of this equipment in any matter whatsoever. Rogue Fitness bears no liability beyond the replacement value of the equipment in question.

### \*\*ATTENTION\*\*

IT MAY BE BENEFICIAL TO TEST BUILD UPRIGHTS / BRACKETS AND MOCK UP SLIM RACK PLACEMENT ON THE WALL PRIOR TO DRILLING HOLES. DIMENSIONS SPECIFIED BELOW ASSUME A PERFECTLY LEVEL FLOOR. ANY VARIATION IN FLOOR SLOPE MAY RESULT IN SLIGHTLY DIFFERENT BRACKETS MOUNTING LOCATIONS.

### STEP 1:

SECURE THE WALL MOUNT BRACKETS (ITEMS 2 & 3) TO THE WALL AS SHOWN USING 3/8" X 2.5" LAG SCREWS (ITEM 9) AND 3/8" FLAT WASHERS (ITEM 10). USE 15/64" DIA PILOT HOLES. (SEE PAGE 4 FOR BRACKET ORIENTATION)

IT IS **NEVER** RECOMMENDED TO INSTALL THE SLIM RACK ON A DRYWALL, WOOD OR METAL STUD WALL WITHOUT A STRINGER OR ADDITIONAL SUPPORT.

### IMPORTANT:

THE HEIGHT DIMENSIONS CAN BE ADJUSTED IN 2" INCREMENTS IF YOU PREFER THE BRACKETS HIGHER OR LOWER.

\*THE UPRIGHT MUST BE FULLY SUPPORTED BY THE FLOOR WHEN THE UNIT IS INSTALLED.\*

### NOTES:

1) IF YOU ARE NOT CONFIDENT IN YOUR MECHANICAL SKILLS, PLEASE SEEK THE HELP OF A PROFESSIONAL TO PERFORM THE INSTALLATION. IT IS THE BUYERS RESPONSIBILITY TO INSTALL THE SLIM RACK IN A LOCATION AND WITH HARDWARE CAPABLE OF SUPPORTING THE AGGREGATE WEIGHT OF THE RACK AND ALL GEAR MOUNTED OR STORED ON IT, AND ANY PERSON USING IT.

2) TEST UNIT FOR STABILITY BEFORE EACH USE.



## WARNING!



MISUSE OF THIS CAN RESULT IN  
SEVERE INJURY

BOTH ROGUE FITNESS AND BUYER DISCLAIM ANY EXPRESS OR IMPLIED WARRANTY, INCLUDING, WITHOUT LIMITATION, WARRANTIES OR MERCHANTABILITY AND/OR FITNESS FOR A PARTICULAR PURPOSE WITH RESPECT TO THE EQUIPMENT. BUYER ASSUMES ALL LIABILITY IN USE OF EQUIPMENT.

**Rogue Fitness**  
545 E 5th Ave.  
Columbus, Ohio 43201  
614-358-6190  
team@roguefitness.com

# ROGUE

## RML-90SLIM RACK (BRACKETS)

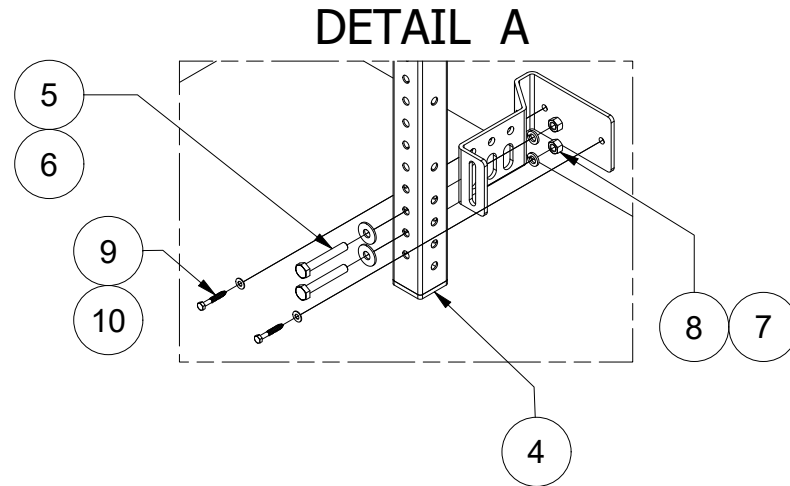
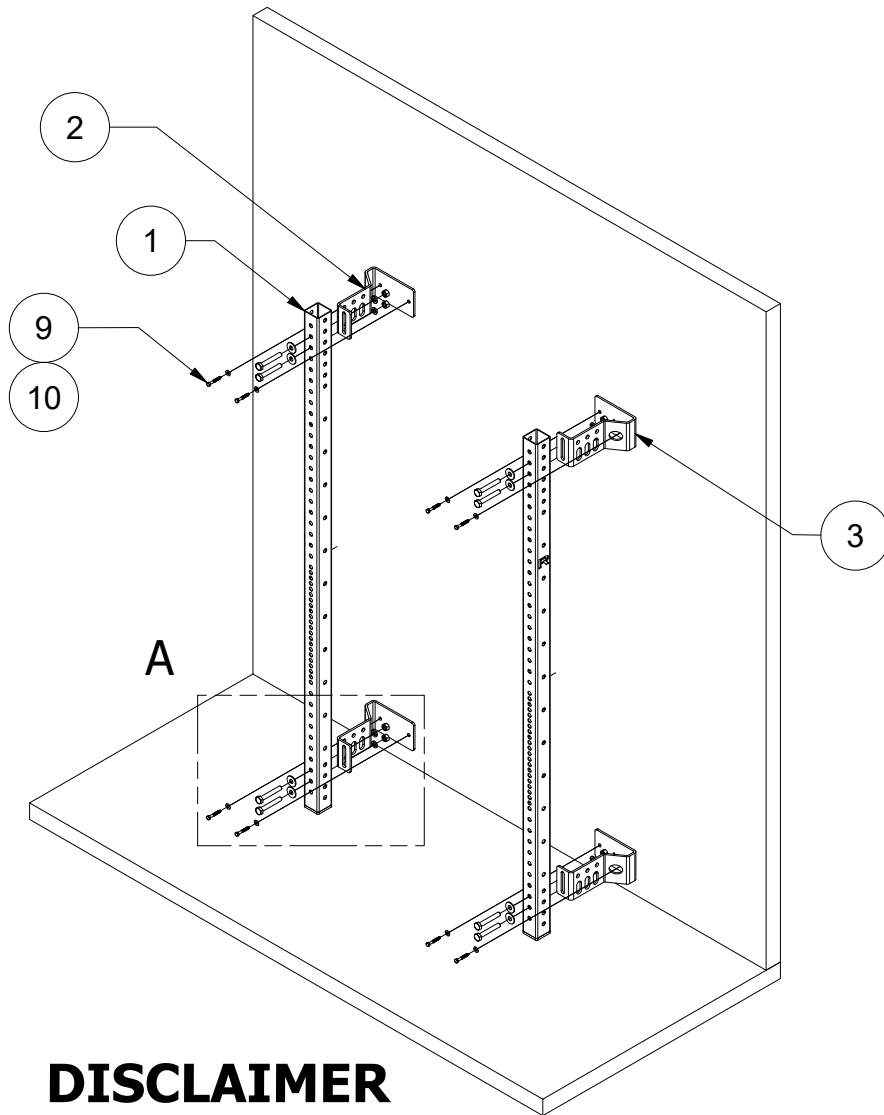

### STEP 2:

INSERT THE UHMW 3X3 FOOT (ITEM 4) INTO THE BOTTOM OF EACH MONSTER LITE 90" STICK (ITEM 1). **SEE DETAIL A.**

ATTACH THE MONSTER LITE 90" STICKS TO THE WALL MOUNT BRACKETS (ITEMS 2 & 3) USING 2 OF THE FOLLOWING FOR EACH BRACKET: 5/8" X 4.25" HEX BOLTS (ITEM 5), 5/8" FLAT WASHER (ITEM 6), 5/8" LOCK WASHER (ITEM 7), AND 5/8" HEX NUT (ITEM 8)

### NOTES:

1) ENSURE THAT THE MONSTER LITE 90" STICKS ARE SUPPORTED BY THE FLOOR BEFORE USE.

2) ENSURE THAT THE MONSTER LITE 90" STICKS ARE LEVEL FRONT-TO-BACK AND SIDE-TO-SIDE

## DISCLAIMER

Resistance training, gymnastics training, and activities at height are potentially dangerous and may lead to severe injury or even death. Use common sense when training, to obtain instruction in the proper execution of movements, and understand your limitations. This equipment must only be used by competent and responsible persons, or under the direct and visual control of a competent and responsible person. Obtaining instruction in appropriate techniques and methods of use is your own responsibility. You assume all risks and responsibilities for all damage, injury or death which may occur during or following incorrect use of this equipment in any matter whatsoever. Rogue Fitness bears no liability beyond the replacement value of the equipment in question.



## WARNING!



MISUSE OF THIS CAN RESULT IN  
SEVERE INJURY

BOTH ROGUE FITNESS AND BUYER DISCLAIM ANY EXPRESS OR IMPLIED WARRANTY, INCLUDING, WITHOUT LIMITATION, WARRANTIES OR MERCHANTABILITY AND/OR FITNESS FOR A PARTICULAR PURPOSE WITH RESPECT TO THE EQUIPMENT. BUYER ASSUMES ALL LIABILITY IN USE OF EQUIPMENT.

**Rogue Fitness**  
545 E 5th Ave.  
Columbus, Ohio 43201  
614-358-6190  
team@roguefitness.com

# ROGUE

## RML-90SLIM RACK (BRACKETS)

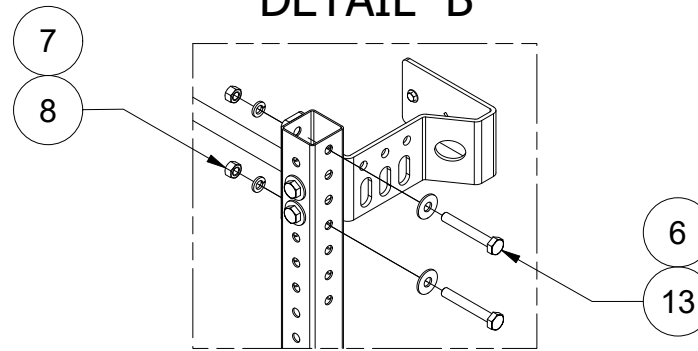
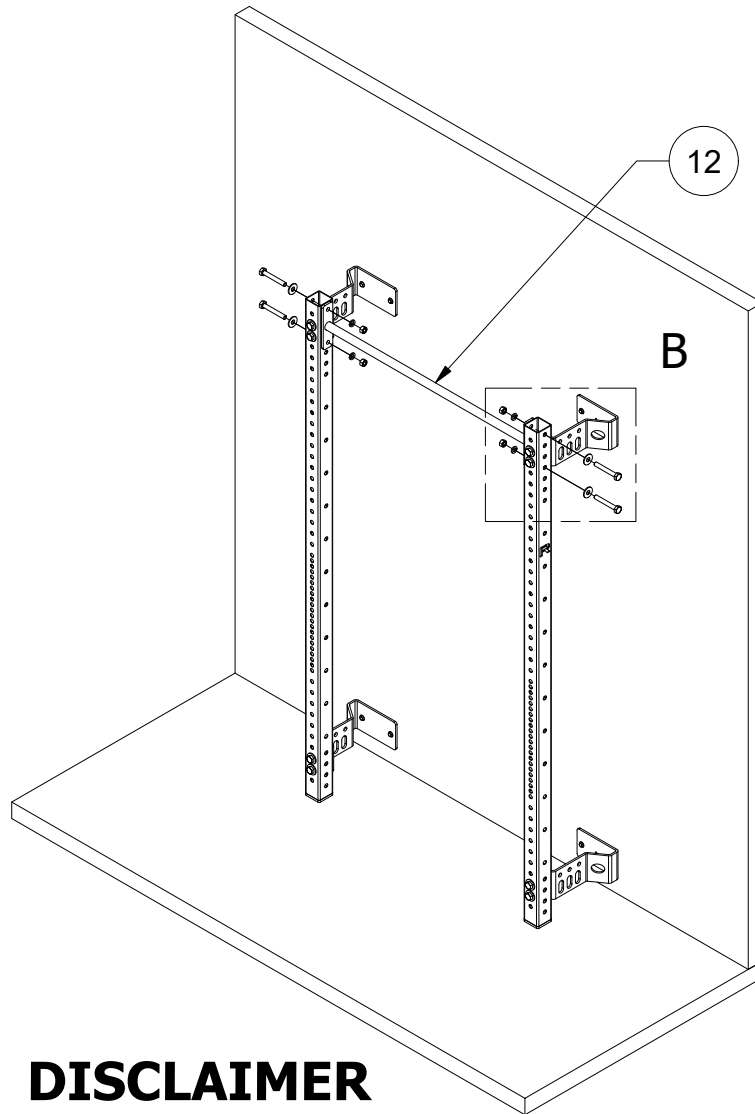

### STEP 3: (ADD-ON)

ATTACH 43" PULL UP BAR (ITEM 12) AT DESIRED HEIGHT USING 5/8" X 4.5" HEX BOLT (ITEM 13), 5/8" FLAT WASHER (ITEM 6), 5/8" LOCK WASHER (ITEM 7), AND 5/8" HEX NUT (ITEM 8). **SEE DETAIL B.**

## DISCLAIMER

Resistance training, gymnastics training, and activities at height are potentially dangerous and may lead to severe injury or even death. Use common sense when training, to obtain instruction in the proper execution of movements, and understand your limitations. This equipment must only be used by competent and responsible persons, or under the direct and visual control of a competent and responsible person. Obtaining instruction in appropriate techniques and methods of use is your own responsibility. You assume all risks and responsibilities for all damage, injury or death which may occur during or following incorrect use of this equipment in any matter whatsoever. Rogue Fitness bears no liability beyond the replacement value of the equipment in question.



## WARNING!

MISUSE OF THIS CAN RESULT IN  
SEVERE INJURY

BOTH ROGUE FITNESS AND BUYER DISCLAIM ANY EXPRESS OR IMPLIED WARRANTY, INCLUDING, WITHOUT LIMITATION, WARRANTIES OR MERCHANTABILITY AND/OR FITNESS FOR A PARTICULAR PURPOSE WITH RESPECT TO THE EQUIPMENT. BUYER ASSUMES ALL LIABILITY IN USE OF EQUIPMENT.

**Rogue Fitness**  
545 E 5th Ave.  
Columbus, Ohio 43201  
614-358-6190  
team@roguefitness.com