

# ROGUE

## 3x3 8" Mini Strip 2.0

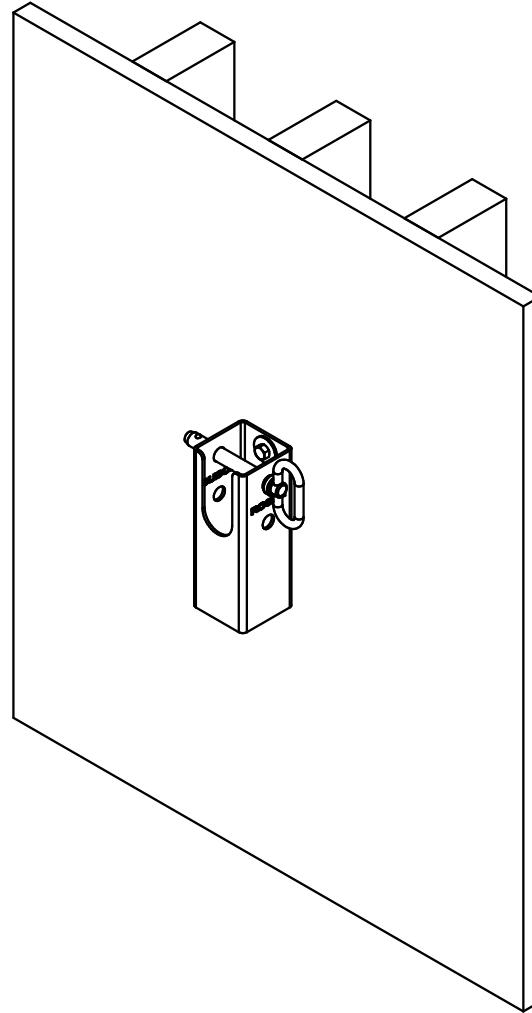

### DISCLAIMER

Resistance training, gymnastics training, and activities at height are potentially dangerous and may lead to severe injury or even death. Use common sense when training, to obtain instruction in the proper execution of movements, and understand your limitations. This equipment must only be used by competent and responsible persons, or under the direct and visual control of a competent and responsible person. Obtaining instruction in appropriate techniques and methods of use is your own responsibility. You assume all risks and responsibilities for all damage, injury or death which may occur during or following incorrect use of this equipment in any matter whatsoever. Rogue Fitness bears no liability beyond the replacement value of the equipment in question.



MISUSE OF THIS CAN RESULT IN  
SEVERE INJURY

BOTH ROGUE FITNESS AND BUYER DISCLAIM ANY EXPRESS OR IMPLIED WARRANTY, INCLUDING, WITHOUT LIMITATION, WARRANTIES OR MERCHANTABILITY AND/OR FITNESS FOR A PARTICULAR PURPOSE WITH RESPECT TO THE EQUIPMENT. BUYER ASSUMES ALL LIABILITY IN USE OF EQUIPMENT.

**Rogue Fitness**  
545 E 5th Ave.  
Columbus, Ohio 43201  
614-358-6190  
team@roguefitness.com

# ROGUE

## 3x3 8" Mini Strip 2.0

### INCLUDED PARTS

\*NOTE: IMAGES NOT SHOWN TO SCALE

PARTS LIST		
ITEM	QTY	PART NUMBER
1	1	Mini Strip
2	2	3/8" Flat Washer
3	1	Detent Pin
4	2	3/8" x 2-1/2" Lag Bolt

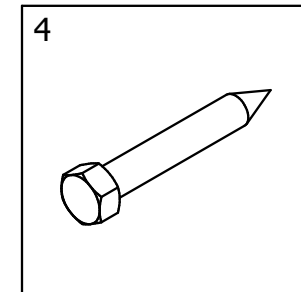
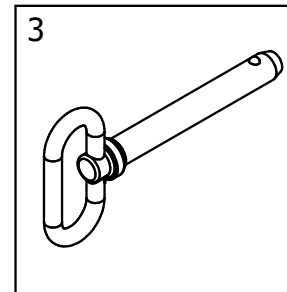
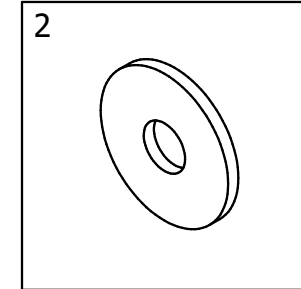
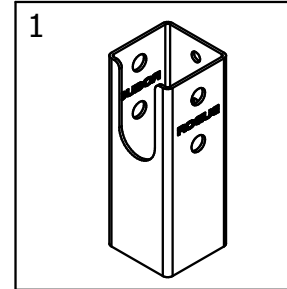

## DISCLAIMER

Resistance training, gymnastics training, and activities at height are potentially dangerous and may lead to severe injury or even death. Use common sense when training, to obtain instruction in the proper execution of movements, and understand your limitations. This equipment must only be used by competent and responsible persons, or under the direct and visual control of a competent and responsible person. Obtaining instruction in appropriate techniques and methods of use is your own responsibility. You assume all risks and responsibilities for all damage, injury or death which may occur during or following incorrect use of this equipment in any matter whatsoever. Rogue Fitness bears no liability beyond the replacement value of the equipment in question.



## WARNING!



MISUSE OF THIS CAN RESULT IN  
SEVERE INJURY

BOTH ROGUE FITNESS AND BUYER DISCLAIM ANY EXPRESS OR IMPLIED WARRANTY, INCLUDING, WITHOUT LIMITATION, WARRANTIES OR MERCHANTABILITY AND/OR FITNESS FOR A PARTICULAR PURPOSE WITH RESPECT TO THE EQUIPMENT. BUYER ASSUMES ALL LIABILITY IN USE OF EQUIPMENT.

**Rogue Fitness**  
545 E 5th Ave.  
Columbus, Ohio 43201  
614-358-6190  
team@roguefitness.com

# ROGUE

## 3x3 8" Mini Strip 2.0

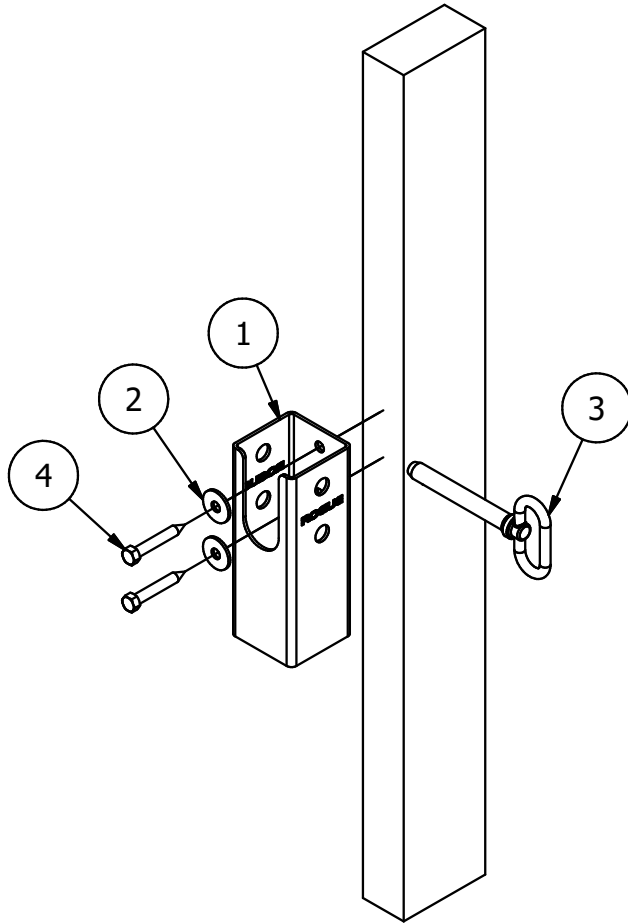

### Securing the Mini Strip to wall or wood stud

1. Identify stud in wall and mark desired height of top hole
2. Drill 15/64" diameter pilot hole
3. Put thread-side of screw through washer then screw through top 3/8" hole in back of the strip into the wall until wood lag can support the weight of the strip
4. Let strip hang. Ensure it is square using a level then mark locations of other hole
5. Hold strip to the side and drill the remaining hole (see illustration to the right)
6. Put thread-side of screw through washer then screw through bottom 3/8" hole in back of the strip into the wall loosely
7. Fully tighten top and bottom screws

If you are not confident in your mechanical skills, please seek the help of a professional to perform the installation.

If attempting to secure strip to wall construction other than wood, the buyer is responsible for using correct hardware.

It is the buyers responsibility to install strip in a location and with hardware capable of supporting the aggregate weight of strip, all gear mounted or stored on it, and any person using it.

### Using the Mini Strip

Ensure detent pin goes through holes on both sides of strip and both sides of attachment. Test unit for stability before each use.

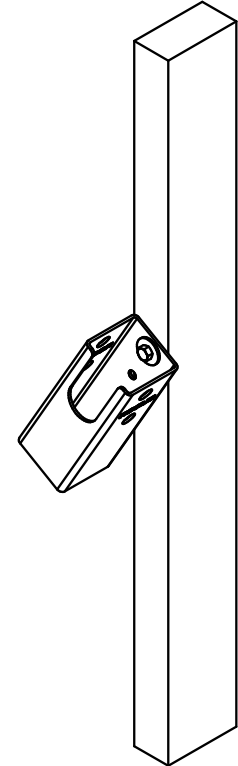

## DISCLAIMER

Resistance training, gymnastics training, and activities at height are potentially dangerous and may lead to severe injury or even death. Use common sense when training, to obtain instruction in the proper execution of movements, and understand your limitations. This equipment must only be used by competent and responsible persons, or under the direct and visual control of a competent and responsible person. Obtaining instruction in appropriate techniques and methods of use is your own responsibility. You assume all risks and responsibilities for all damage, injury or death which may occur during or following incorrect use of this equipment in any matter whatsoever. Rogue Fitness bears no liability beyond the replacement value of the equipment in question.



## WARNING!



MISUSE OF THIS CAN RESULT IN  
SEVERE INJURY

BOTH ROGUE FITNESS AND BUYER DISCLAIM ANY EXPRESS OR IMPLIED WARRANTY, INCLUDING, WITHOUT LIMITATION, WARRANTIES OR MERCHANTABILITY AND/OR FITNESS FOR A PARTICULAR PURPOSE WITH RESPECT TO THE EQUIPMENT. BUYER ASSUMES ALL LIABILITY IN USE OF EQUIPMENT.

**Rogue Fitness**  
545 E 5th Ave.  
Columbus, Ohio 43201  
614-358-6190  
team@roguefitness.com